

REVISIONS

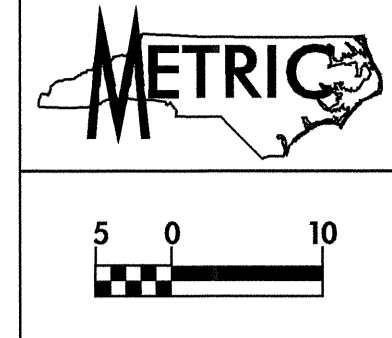

PROJECT REFERENCE NO. R-2206AA	SHEET NO. 27
R-2206A SHEET NO. 27	
ROADWAY DESIGN ENGINEER NORTH CAROLINA PROFESSIONAL ENGINEER 15356 DAVID ALLEN	HYDRAULICS ENGINEER NORTH CAROLINA PROFESSIONAL ENGINEER 9334 HENRY WELLS
CONST. REV.	
R/W REV.	

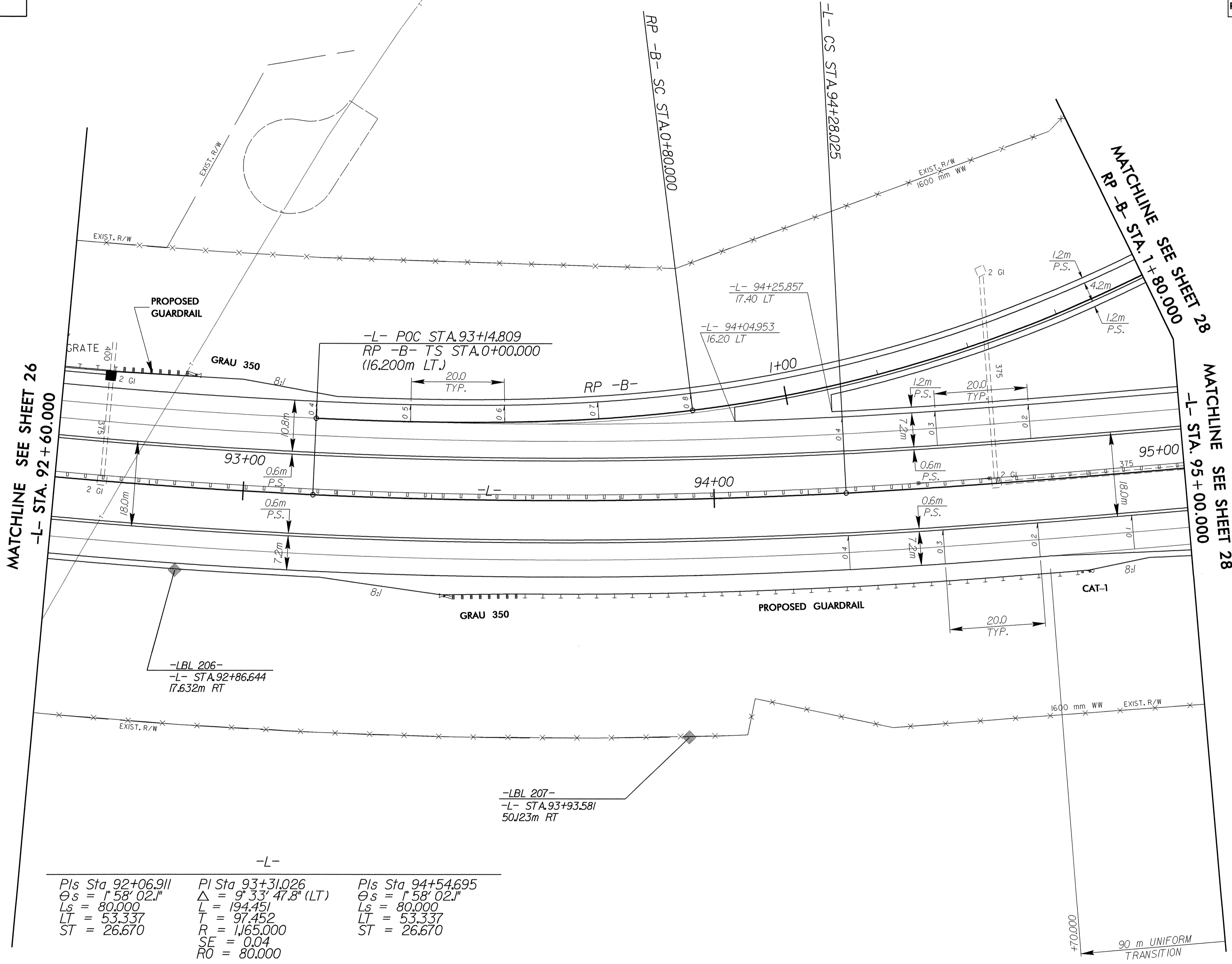
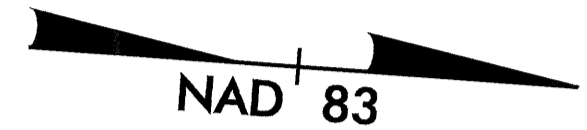

-L-		
Pls Sta 92+06.911	Pls Sta 93+31.026	Pls Sta 94+54.695
$\Theta_s = 1^{\circ} 58' 02.1''$	$\Delta = 9^{\circ} 33' 47.8''$ (LT)	$\Theta_s = 1^{\circ} 58' 02.1''$
$L_s = 80.000$	$L = 194.451$	$L_s = 80.000$
$LT = 53.337$	$T = 97.452$	$LT = 53.337$
$ST = 26.670$	$R = 1,165.000$	$ST = 26.670$
	$SE = 0.04$	
	$RO = 80.000$	
	RP -B-	
Pls Sta 0+47.903	Pls Sta 1+60.668	Pls Sta 2+64.320
$\Theta_s = 9^{\circ} 38' 03.9''$	$\Delta = 30^{\circ} 06' 03.7''$ (LT)	$\Theta_s = 7^{\circ} 38' 22.0''$
$L_s = 80.000$	$L = 157.609$	$L_s = 80.000$
$LT = 47.903$	$T = 80.668$	$LT = 53.383$
$ST = 32.273$	$R = 300.000$	$ST = 26.712$
	$SE = 0.08$	
	$RO = 80.000$	

SEE SHEET 48 FOR -L- PROFILE
SEE SHEET 63 FOR RP -B- PROFILE

30-SEP-2004 16:35
SECalhoun rd-09occe34