

10/26/08

21-SEP-2004 07:53  
SECalhoun rd-09oce34

# (NC 16)

**METRIC**

PROJECT REFERENCE NO. **R-2206AA** SHEET NO. **36**  
R-2206A SHEET NO. 48

ROADWAY DESIGN ENGINEER  
NORTH CAROLINA PROFESSIONAL SEAL  
15356  
RONALD DAVID ALLEN  
10-8-04

HYDRAULICS ENGINEER  
NORTH CAROLINA PROFESSIONAL SEAL  
9334  
HENRY WELLS  
10/21/04

CONST. REV.  
R/W REV.

5 0 10

BM 118  
-L- STA 17+28.773  
46.8024 m RIGHT  
EL.225.252 IP & CAP

BM 104  
-L- STA 17+66.200  
81.4046 m LEFT  
EL.228.453 IP & CAP

BM 119  
-L- STA 18+45.818  
77.5084 m RIGHT  
EL.226.706 IP & CAP

BM 120  
-L- STA 19+99.078  
35.9357 m RIGHT  
EL.224.621 IP & CAP

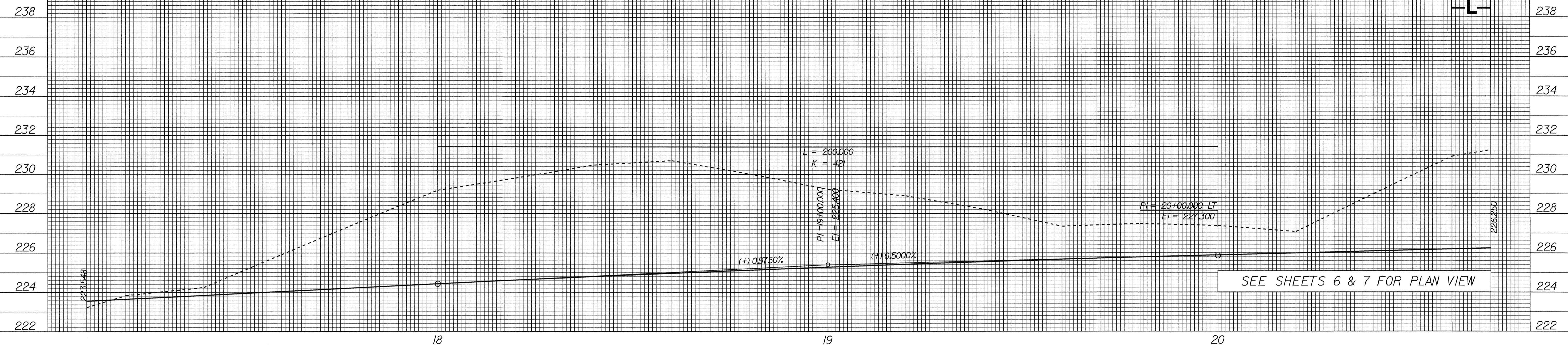

# (NC 16)

**STRUCTURE HYDRAULIC DATA**

DESIGN DISCHARGE	= 16.0 CMS
DESIGN FREQUENCY	= 50 YRS
DESIGN HW ELEVATION	= 216.47 M
BASE DISCHARGE	= 19.0 CMS
BASE FREQUENCY	= 100 YRS
BASE HW ELEVATION	= 216.73 M
OVERTOPPING DISCHARGE	= 26.2+ CMS
OVERTOPPING FREQUENCY	= 500+ YRS
OVERTOPPING ELEVATION	= 227.40M

BM 123  
-L- STA 23+70.597  
28.8344 m RIGHT  
EL.215.125 IP & CAP

SEE SHEETS 7 & 8 FOR PLAN VIEW

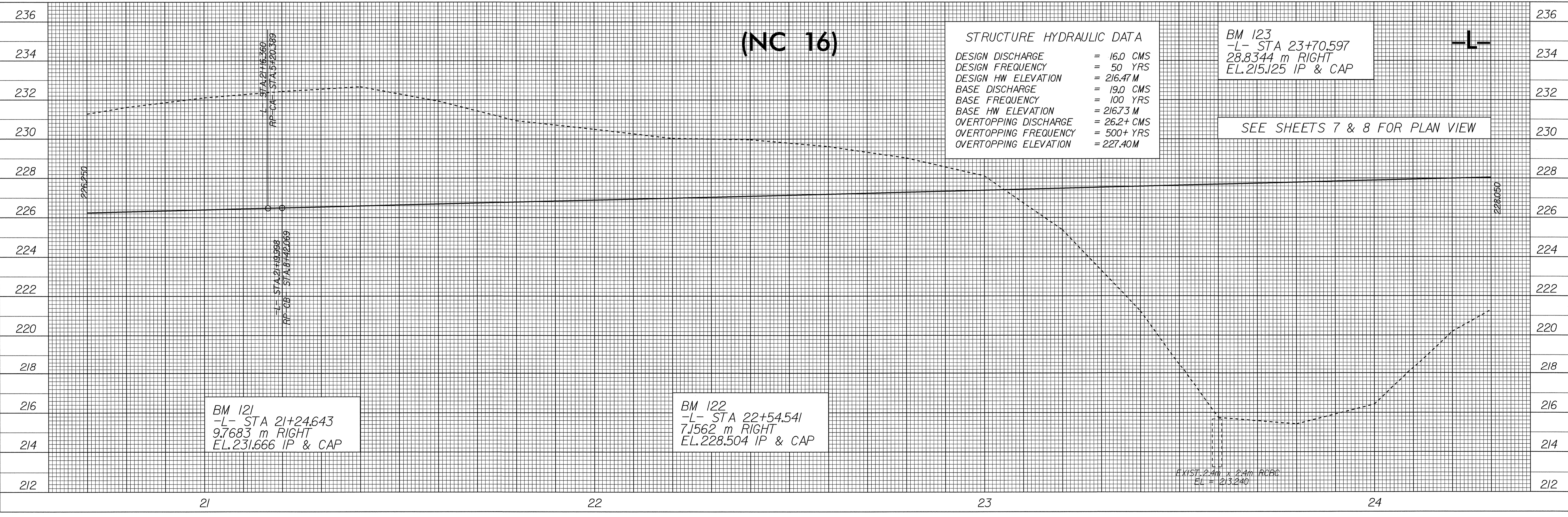

BM 121  
-L- STA 21+24.643  
9.7683 m RIGHT  
EL.231.666 IP & CAP

BM 122  
-L- STA 22+54.541  
7.1562 m RIGHT  
EL.228.504 IP & CAP

EXIST. 2.4m x 2.4m RCBC  
EL = 213.240