

RAMP -B- (EXIST. NC 16)

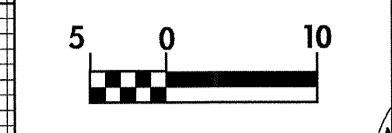

PROJECT REFERENCE NO. R-2206AA	SHEET NO. 51
R-2206A SHEET NO. 63	
ROADWAY DESIGN ENGINEER NORTH CAROLINA PROFESSIONAL SEAL 15356 RONALD DAVID ALLEN	HYDRAULICS ENGINEER NORTH CAROLINA PROFESSIONAL SEAL 9334 W. HEARY WELLS
10-8-04	



CONST. REV.
R / W REV.

BM 102
-RPB- STA 4+65.140
19.6924 m LEFT
EL. 236.747 IP & CAP

BM 101
-RPB- STA 6+60.534
10.308 m RIGHT
EL. 236.513 IP & CAP

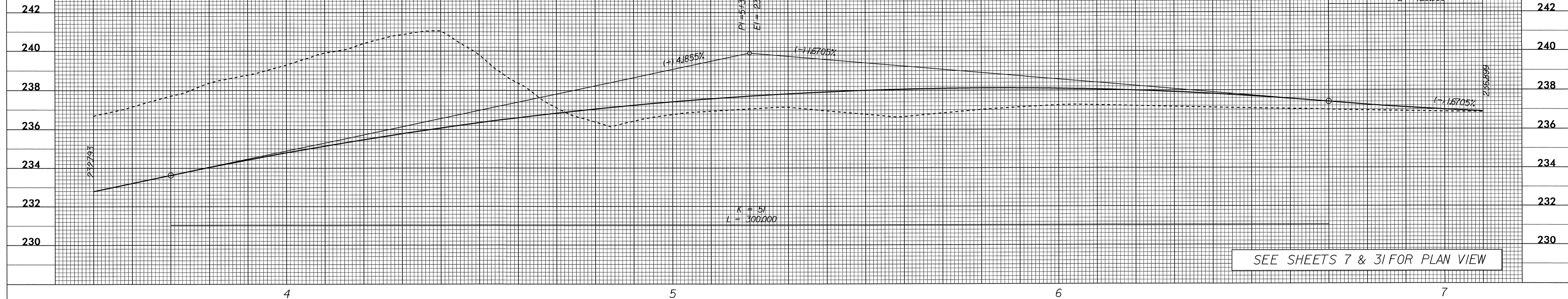

RAMP -B- (EXIST. NC 16)

-RPB-

END GRADE
RAMP -B- STA 8+00.000
EI = 236.878

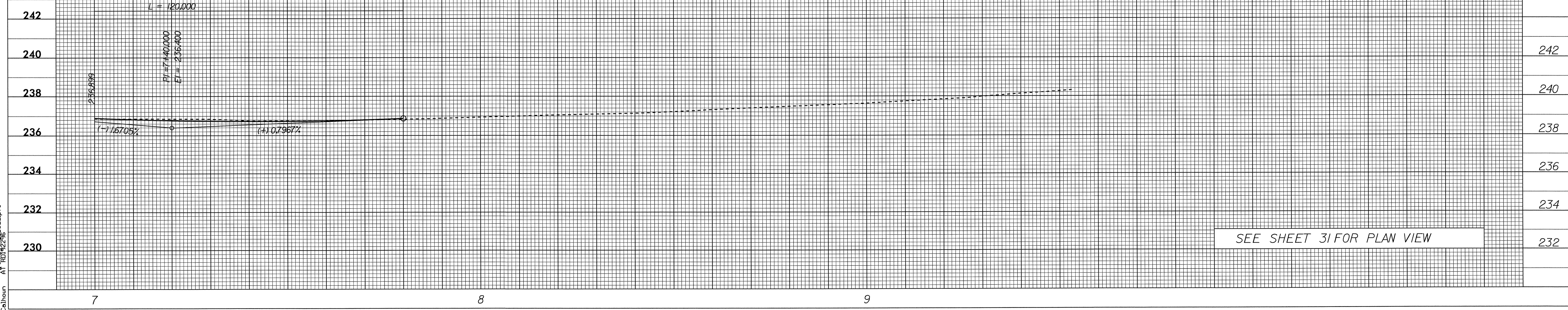

21-SEP-2004 07:47
SECalhoun RD192296.dwg