

RAMP -CA- (EXIST. NC 16)

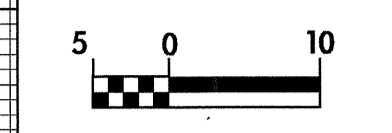

PROJECT REFERENCE NO. R-2206AA	SHEET NO. 52
R-2206A SHEET NO. 64	
ROADWAY DESIGN ENGINEER <i>[Signature]</i>	HYDRAULICS ENGINEER <i>[Signature]</i>
CONST. REV.	10-8-04
R/W REV.	10-21-04



DRAINAGE AREA	= 6.0 HA
DESIGN FREQUENCY	= 50 YRS
DESIGN DISCHARGE	= 1.07 CMS
DESIGN HW ELEVATION	= 216.50 M
100 YEAR DISCHARGE	= 1.25 CMS
100 YEAR HW ELEVATION	= 216.59 M
OVERTOPPING FREQUENCY	= 500+ YRS
OVERTOPPING DISCHARGE	= 2.12+ CMS
OVERTOPPING ELEVATION	= 220.400 M

BEGIN GRADE
RAMP -CA- STA 0+00.000 =
+L- STA 14+20.00 EP (16.20m RT.)
EL = 219.726

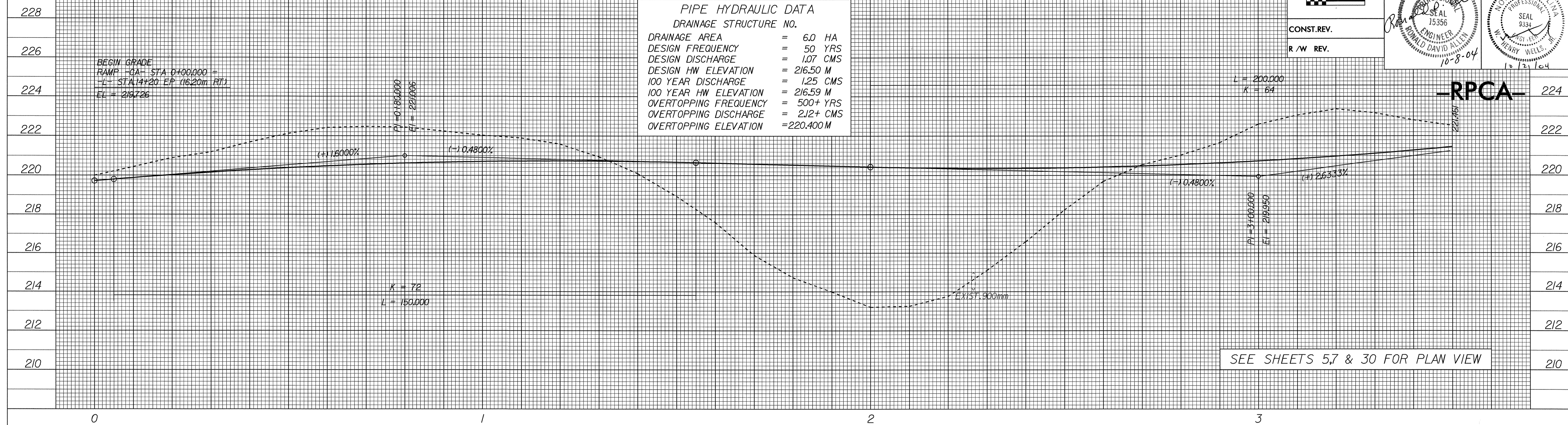

RAMP -CA- (EXIST. NC 16)

DRAINAGE AREA	= 6.12 HA
DESIGN FREQUENCY	= 50 YRS
DESIGN DISCHARGE	= 1.11 CMS
DESIGN HW ELEVATION	= 218.12 M
100 YEAR DISCHARGE	= 1.29 CMS
100 YEAR HW ELEVATION	= 218.26 M
OVERTOPPING FREQUENCY	= 500 YRS
OVERTOPPING DISCHARGE	= 2.20 CMS
OVERTOPPING ELEVATION	= 224.472 M

DRAINAGE AREA	= 2.8 HA
DESIGN FREQUENCY	= 50 YRS
DESIGN DISCHARGE	= 0.56 CMS
DESIGN HW ELEVATION	= 217.93 M
100 YEAR DISCHARGE	= 0.63 CMS
100 YEAR HW ELEVATION	= 217.96 M
OVERTOPPING FREQUENCY	= 500+ YRS
OVERTOPPING DISCHARGE	= 1.68+ CMS
OVERTOPPING ELEVATION	= 221.35 M

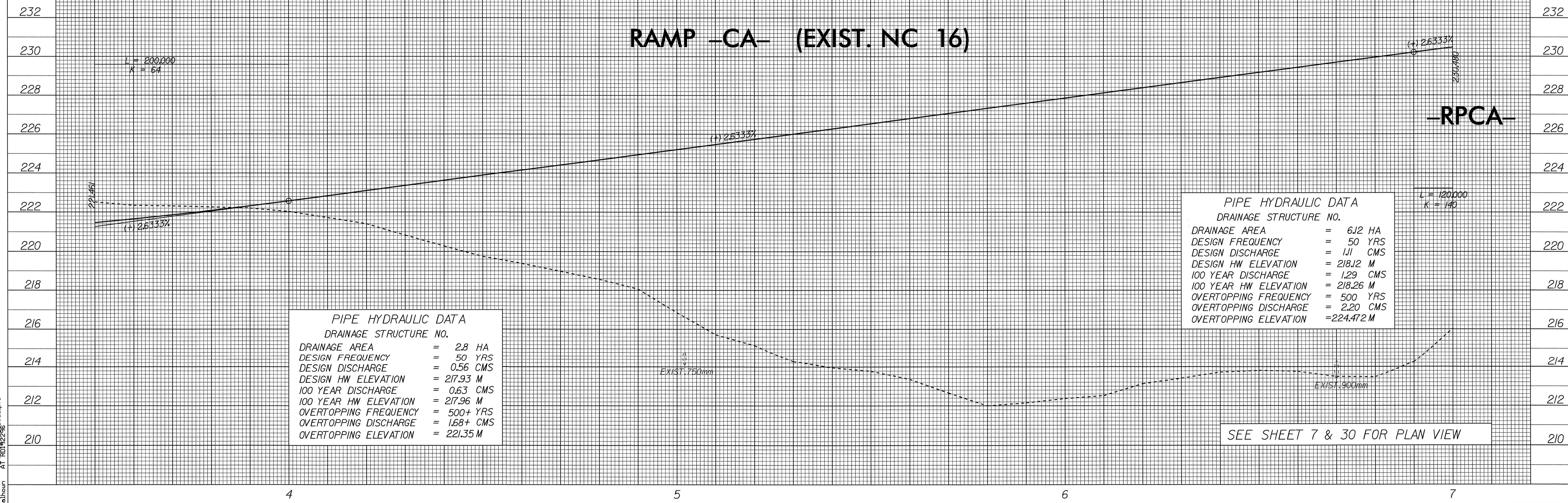

21-SEP-2004 07:46
SECalhoun rd-09oce34