

RAMP -BC- (EXIST. NC 16)

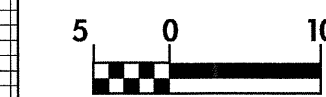

PROJECT REFERENCE NO. R-2206AA	SHEET NO. 56
R-2206A SHEET NO. 68	
ROADWAY DESIGN ENGINEER DONALD DAVID ALLEN 15356 10-8-04	HYDRAULICS ENGINEER HENRY WELLS 9334 10/21/04



CONST. REV.
R / W REV.

-RPBC-

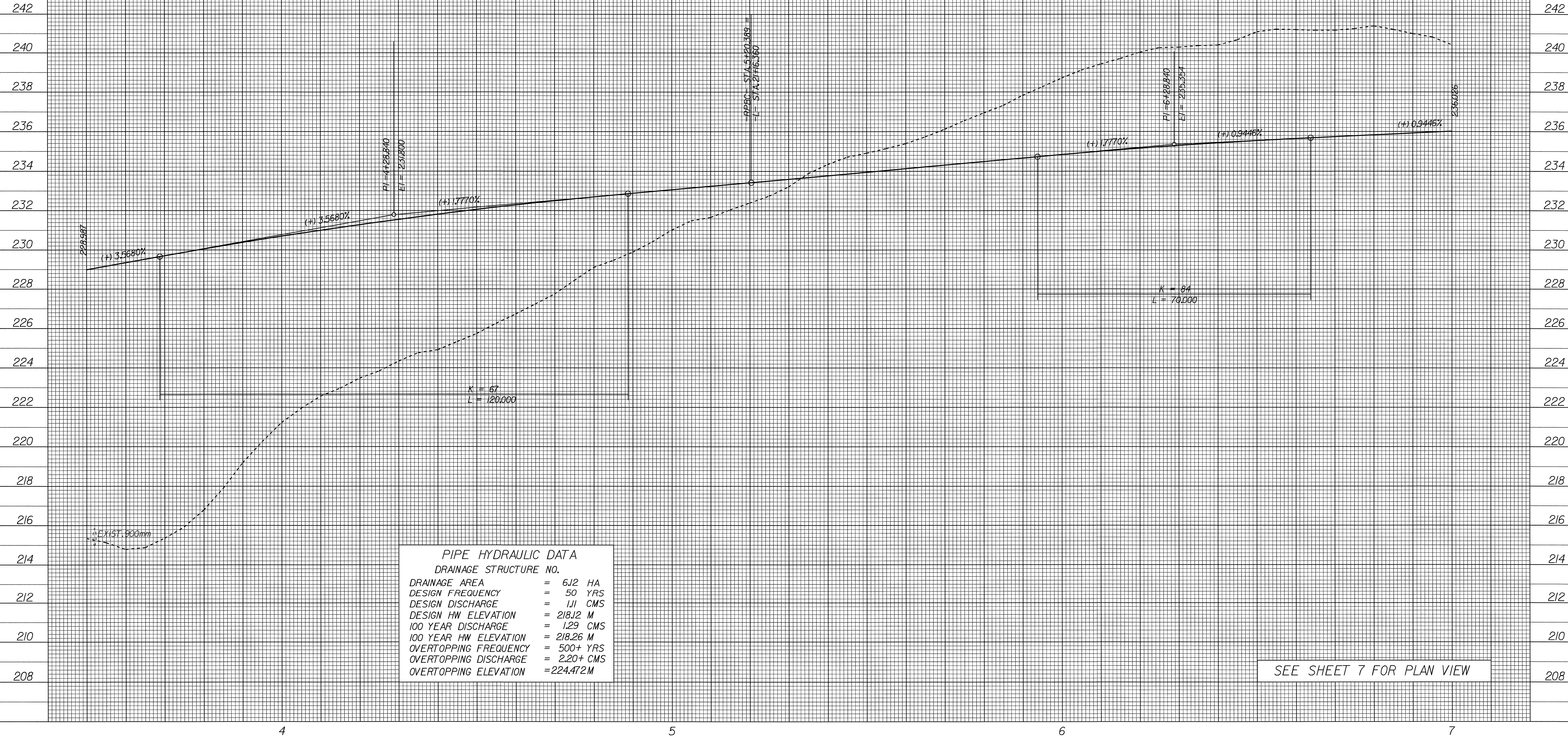

PIPE HYDRAULIC DATA	
DRAINAGE STRUCTURE NO.	
DRAINAGE AREA	= 6.12 HA
DESIGN FREQUENCY	= 50 YRS
DESIGN DISCHARGE	= 1.11 CMS
DESIGN HW ELEVATION	= 218.12 M
100 YEAR DISCHARGE	= 1.29 CMS
100 YEAR HW ELEVATION	= 218.26 M
OVERTOPPING FREQUENCY	= 500+ YRS
OVERTOPPING DISCHARGE	= 2.20+ CMS
OVERTOPPING ELEVATION	= 224.472 M

SEE SHEET 7 FOR PLAN VIEW

21-SEP-2004 09:06 At 1001422666.pfl
SECalhour