

RAMP -A- (EXIST. NC 16)

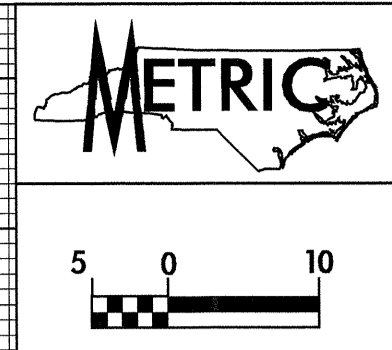

PROJECT REFERENCE NO. R-2206AA	SHEET NO. 59
R-2206A SHEET NO. 71	
ROADWAY DESIGN ENGINEER DAVID ALLEN 10-8-04	HYDRAULICS ENGINEER HENRY WELLS 10/21/04

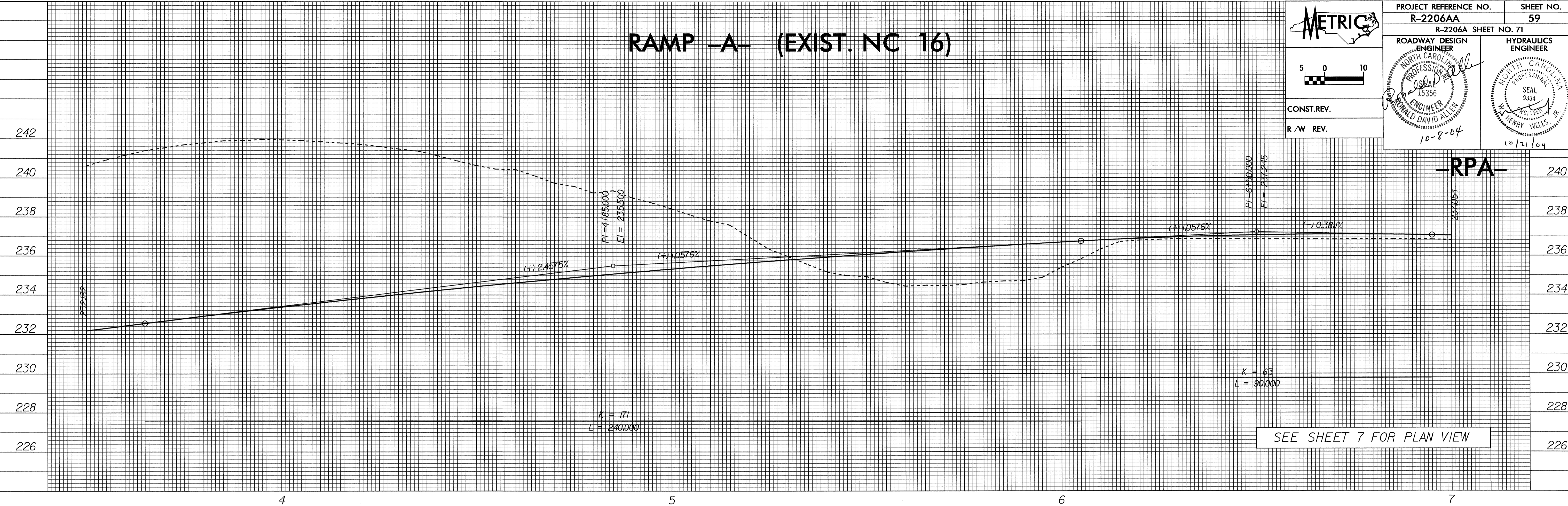

SEE SHEET 7 FOR PLAN VIEW

RAMP -A- (EXIST. NC 16)

-RPA-

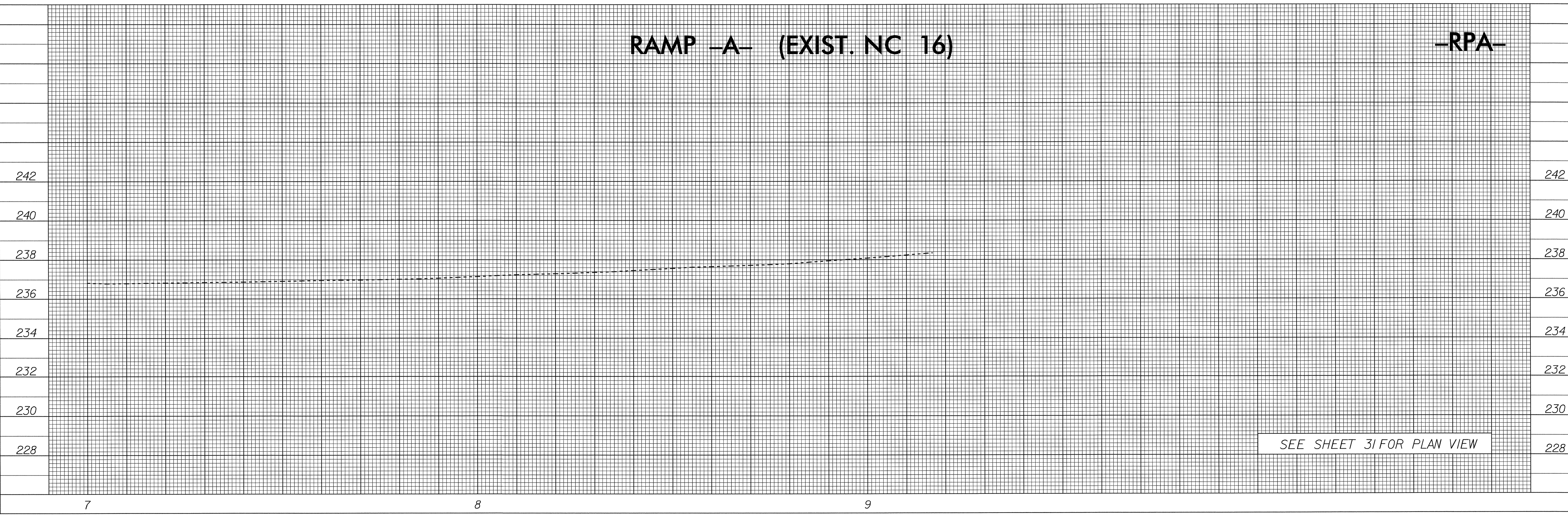

SEE SHEET 31 FOR PLAN VIEW

21-SEP-2004 07:13:23
SECalhoun rd-09oce34