

PLAN OF SIDEWALK

BILL OF MATERIAL						
SIDEWALK						
BAR	NO.	SIZE	TYPE	LENGTH	WEIGHT	
* B11	60	#4	STR	30'-0"	1202	
* D11	164	#4	STR	0'-10"	91	
* G11	278	#4	STR	6'-5"	1192	
* G12	2	#4	STR	5'-9"	8	
* G13	4	#4	STR	4'-5"	12	
* EPOXY COATED REINF. STEEL = 2505 LBS						
CLASS "AA" CONCRETE 36.8 C.Y.						
* THESE BARS ARE EPOXY COATED						

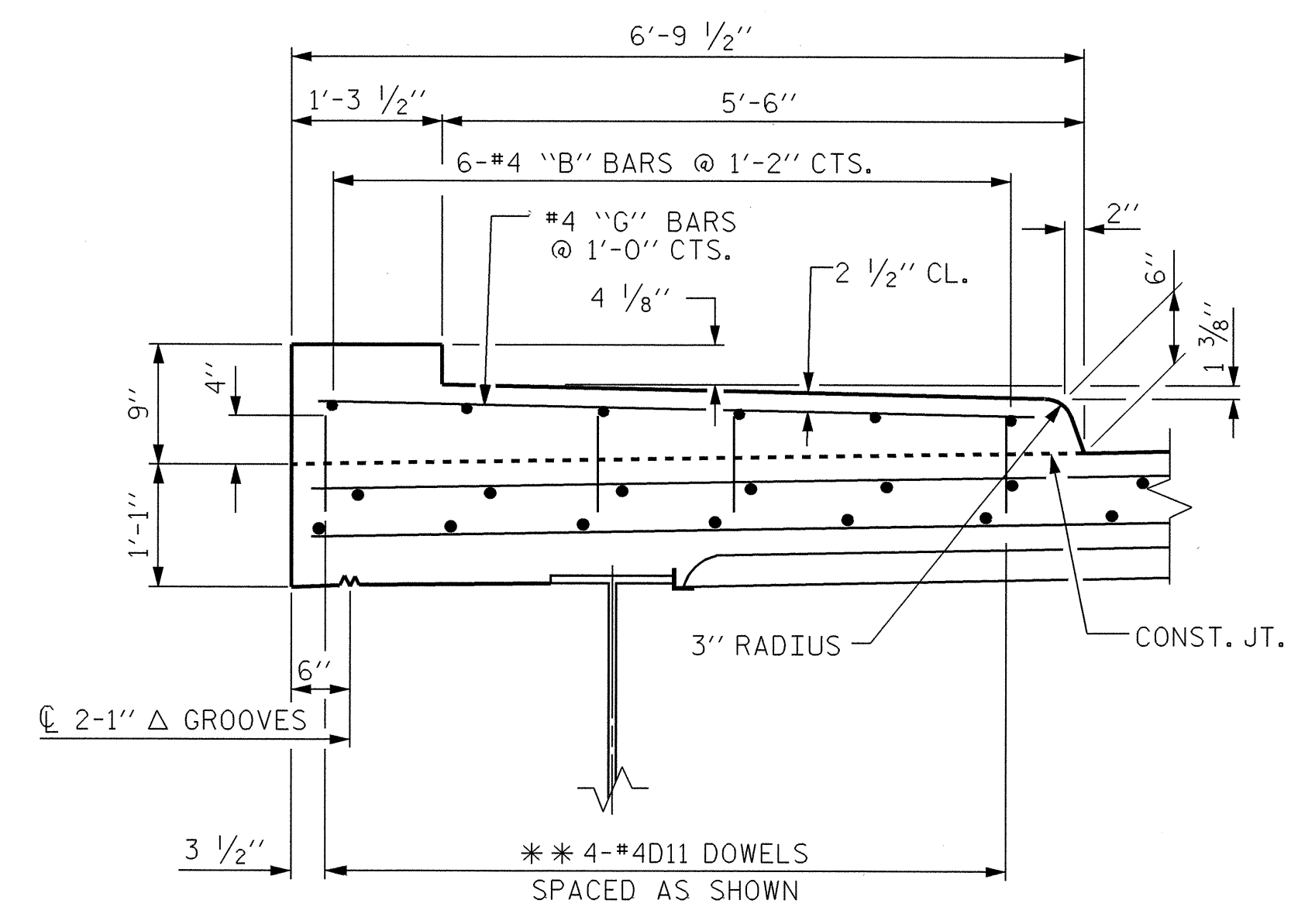

SECTION THRU SIDEWALK

** DOWELS MAY BE PUSHED INTO GREEN CONCRETE AFTER SPAN HAS BEEN SCREEDED OFF.

NOTES

THE #4D11 & #4G12 BARS MAY BE SHIFTED SLIGHTLY IN ORDER TO MAINTAIN A 2" CLEARANCE TO THE 1" EXPANSION JOINT MATERIAL IN SIDEWALK.

THE SIDEWALK IN A CONTINUOUS UNIT SHALL NOT BE CAST UNTIL ALL SLAB CONCRETE IN THAT UNIT HAS BEEN CAST AND HAS REACHED A MINIMUM COMPRESSIVE STRENGTH OF 3,000 PSI.

PROJECT NO. I-2102
FORSYTH COUNTY
 STATION: 20+71.54 -L-



STATE OF NORTH CAROLINA
 DEPARTMENT OF TRANSPORTATION
 RALEIGH

SUPERSTRUCTURE
 SIDEWALK DETAILS

REVISIONS						SHEET NO.	
NO.	BY:	DATE:	NO.	BY:	DATE:	S-25	
1			3			TOTAL SHEETS 51	
2			4				

DRAWN BY: J.P. ADAMS DATE: 8/12/03
 CHECKED BY: S.H. SOCKWELL DATE: 10/2/03