

REINFORCING BAR SCHEDULE (SPANS A-B)																																																																																																																																																																																																																																																																																																																																																																																																																																																																																																																																																																																									
STAGE 1						STAGE 2																																																																																																																																																																																																																																																																																																																																																																																																																																																																																																																																																																																			
BAR	NO.	SIZE	TYPE	LENGTH	WEIGHT	BAR	NO.	SIZE	TYPE	LENGTH	WEIGHT	BAR	NO.	SIZE	TYPE	LENGTH	WEIGHT	BAR	NO.	SIZE	TYPE	LENGTH	WEIGHT																																																																																																																																																																																																																																																																																																																																																																																																																																																																																																																																																																		
*A1	468	#5	STR	43'-2"	21071	A208	4	#5	STR	30'-3"	126	*A3	468	#5	STR	43'-2"	21071	A408	4	#5	STR	30'-3"	126	A209	4	#5	STR	28'-7"	119	A409	4	#5	STR	28'-7"	119	A410	4	#5	STR	26'-11"	112	*A301	4	#5	STR	41'-9"	174	A410	4	#5	STR	26'-11"	112	*A302	4	#5	STR	40'-1"	167	A411	4	#5	STR	25'-4"	106	*A303	4	#5	STR	38'-6"	161	A412	4	#5	STR	23'-8"	99	*A304	4	#5	STR	36'-10"	154	A413	4	#5	STR	22'-0"	92	*A305	4	#5	STR	35'-2"	147	A414	4	#5	STR	20'-4"	85	*A306	4	#5	STR	33'-6"	140	A415	4	#5	STR	18'-8"	78	*A307	4	#5	STR	31'-11"	133	A416	4	#5	STR	17'-1"	71	*A308	4	#5	STR	30'-3"	126	A417	4	#5	STR	15'-5"	64	*A309	4	#5	STR	28'-7"	119	A418	4	#5	STR	13'-9"	57	*A310	4	#5	STR	26'-11"	112	A419	4	#5	STR	12'-1"	50	*A311	4	#5	STR	25'-4"	106	A420	4	#5	STR	10'-6"	44	*A312	4	#5	STR	23'-8"	99	A421	4	#5	STR	8'-10"	37	*A313	4	#5	STR	22'-0"	92	A422	4	#5	STR	7'-2"	30	*A314	4	#5	STR	20'-4"	85	A423	4	#5	STR	5'-6"	23	*A315	4	#5	STR	18'-8"	78	A424	4	#5	STR	3'-11"	16	*A316	4	#5	STR	17'-1"	71	A425	4	#5	STR	2'-3"	9	*A317	4	#5	STR	15'-5"	64	*A318	4	#5	STR	13'-9"	57	*A5	520	#5	STR	1'-8"	904	*A319	4	#5	STR	12'-1"	50	*B1	128	#4	STR	26'-3"	2244	*A320	4	#5	STR	10'-6"	44	*B2	183	#7	STR	35'-2"	13514	*A321	4	#5	STR	8'-10"	37	*B3	220	#5	STR	58'-2"	13347	*A322	4	#5	STR	7'-2"	30	*A323	4	#5	STR	5'-6"	23	*A324	4	#5	STR	3'-11"	16	*A325	4	#5	STR	2'-3"	9	*D1	517	#5	STR	3'-0"	1618	*A2	468	#5	STR	43'-2"	21071	*K1	6	#5	1	11'-9"	74	A4	468	#5	STR	43'-2"	21071	*G1	2	#5	STR	51'-8"	108	*K2	18	#5	2	15'-7"	293	A201	4	#5	STR	41'-9"	174	*K3	6	#5	1	11'-1"	69	A401	4	#5	STR	41'-9"	174	*S1	72	#4	3	4'-10"	245	A402	4	#5	STR	40'-1"	167	A403	4	#5	STR	38'-6"	161	A404	4	#5	STR	36'-10"	154	A405	4	#5	STR	35'-2"	147	A406	4	#5	STR	33'-6"	140	A407	4	#5	STR	31'-11"	133	A202	4	#5	STR	40'-1"	167	A203	4	#5	STR	38'-6"	161	A204	4	#5	STR	36'-10"	154	A205	4	#5	STR	35'-2"	147	A206	4	#5	STR	33'-6"	140	A207	4	#5	STR	31'-11"	133	A210	4	#5	STR	26'-11"	112	A211	4	#5	STR	25'-4"	106	A212	4	#5	STR	23'-8"	99	A213	4	#5	STR	22'-0"	92	A214	4	#5	STR	20'-4"	85	A215	4	#5	STR	18'-8"	78	A216	4	#5	STR	17'-1"	71	A217	4	#5	STR	15'-5"	64	A218	4	#5	STR	12'-1"	50	A219	4	#5	STR	12'-1"	50	A220	4	#5	STR	10'-6"	44	A221	4	#5	STR	8'-10"	37	A222	4	#5	STR	7'-2"	30	A223	4	#5	STR	5'-6"	23	A224	4	#5	STR	3'-11"	16	A225	4	#5	STR	2'-3"	9	*B2	174	#7	STR	35'-2"	12507	*B3	220	#5	STR	58'-2"	13347	*B4	120	#4	STR	24'-8"	1977	*D1	517	#5	STR	3'-0"	1618	*G1	2	#5	STR	51'-8"	108

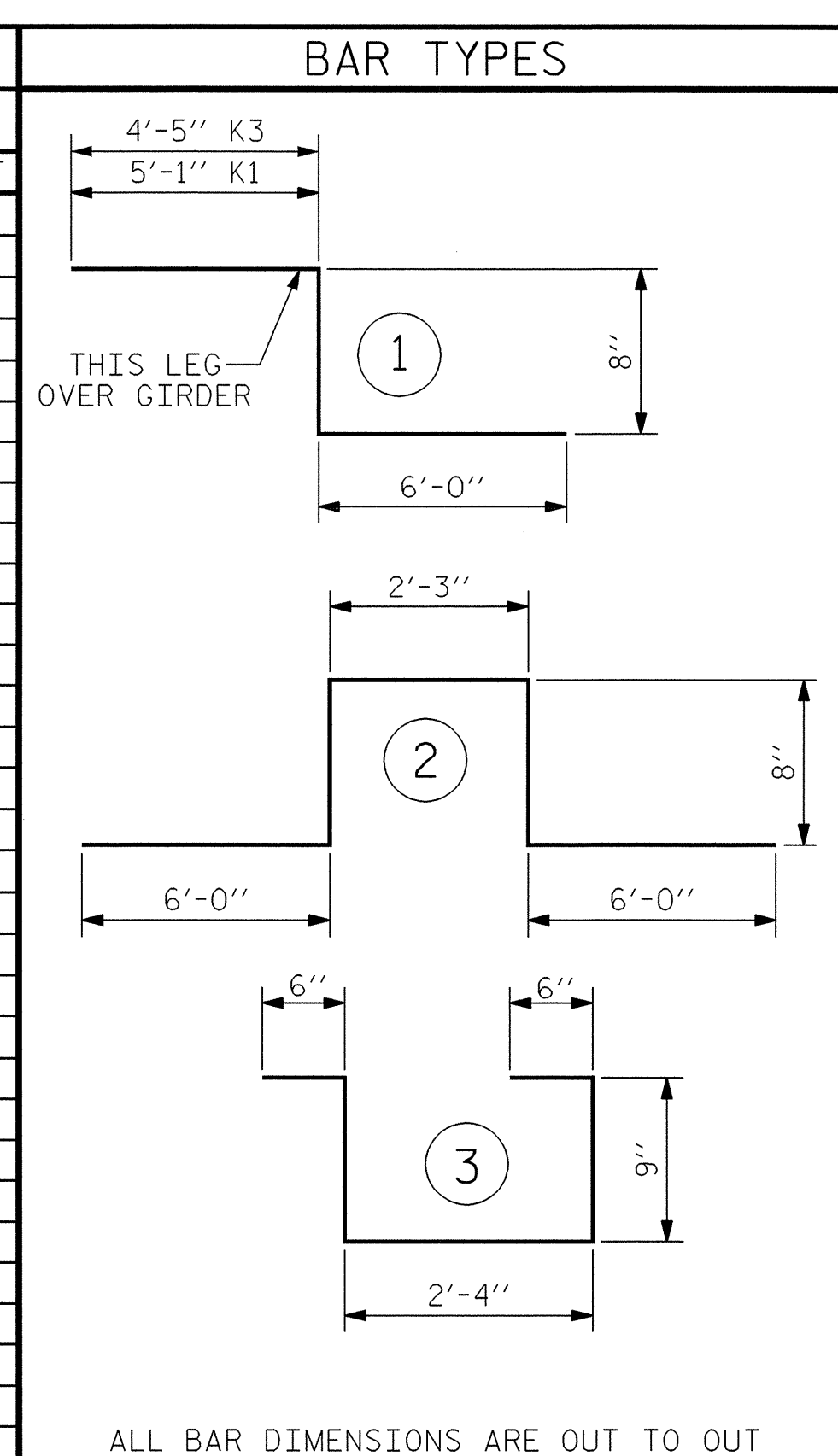

GROOVING BRIDGE FLOORS	
BRIDGE DECK	21,958 SQ.FT.
APPROACH SLAB	4,295 SQ.FT.
TOTAL	26,253 SQ.FT.

BAR SIZE	SUPERSTRUCTURE EXCEPT APPROACH SLABS, PARAPET, AND BARRIER RAIL		APPROACH SLABS		PARAPET AND BARRIER RAIL
	EPOXY COATED	UNCOATED	EPOXY COATED	UNCOATED	
#4	2'-0"	1'-9"	2'-0"	1'-9"	2'-9"
#5	2'-6"	2'-2"	2'-6"	2'-2"	3'-5"
#6	3'-0"	2'-7"	3'-10"	2'-7"	4'-4"
#7	5'-3"	3'-6"			
#8	6'-10"	4'-7"			

REINFORCING STEEL QUANTITIES		
	REINFORCING STEEL	EPOXY COATED REINFORCING STEEL
STAGE 1	36,712 Lbs.	42,347 Lbs.
STAGE 2	36,712 Lbs.	44,551 Lbs.
END POSTS & SIDEWALK		2,743 Lbs.
TOTAL	73,424 Lbs.	89,641 Lbs.

CONCRETE QUANTITIES WITH POUR SEQUENCE BREAKDOWN			
CLASS AA CONCRETE (CU. YARDS)			
	POUR #1	POUR #2	TOTAL
STAGE 1	119.3	284.5	403.8
STAGE 2	119.3	284.5	403.8
CLOSURE POUR			21.8
END POSTS & SIDEWALK			37.8
TOTAL CONCRETE (CU. YDS.)			867.2

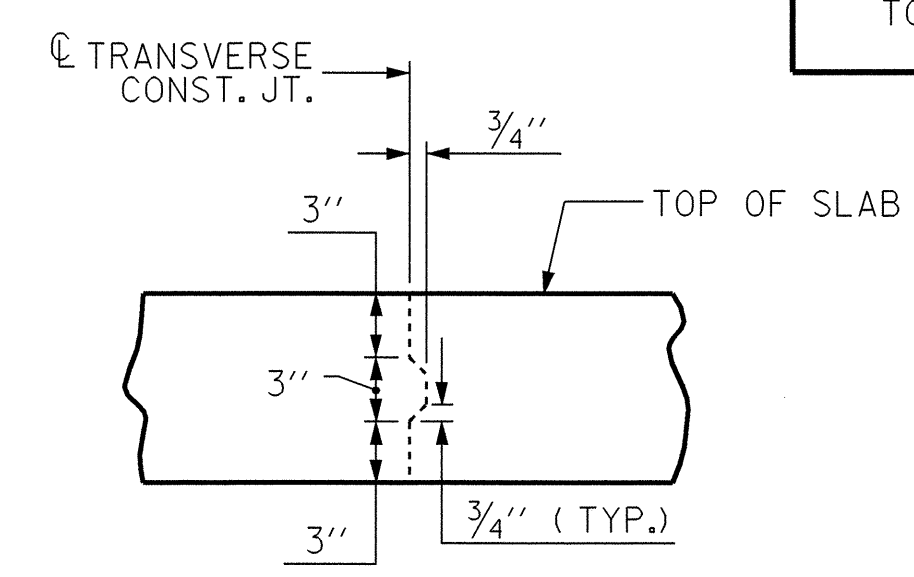
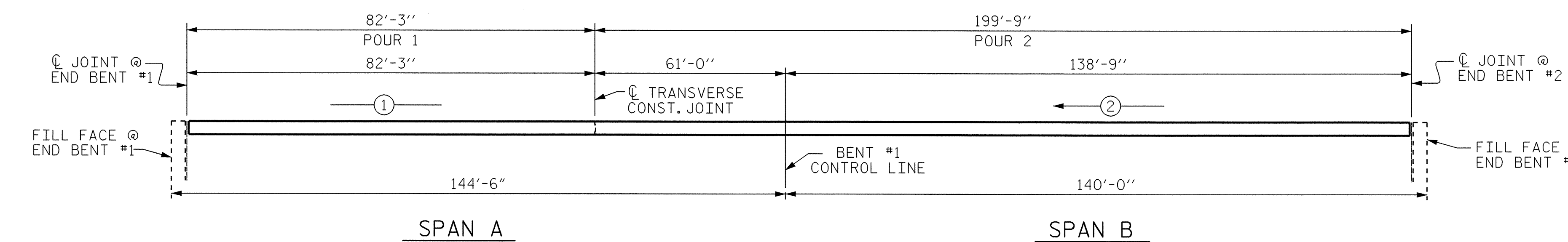

TRANSVERSE CONSTRUCTION JOINT DETAIL  
NOTE: REINFORCING STEEL IN SLAB NOT SHOWN. LONGITUDINAL REINFORCING STEEL SHALL BE CONTINUOUS THRU JOINT

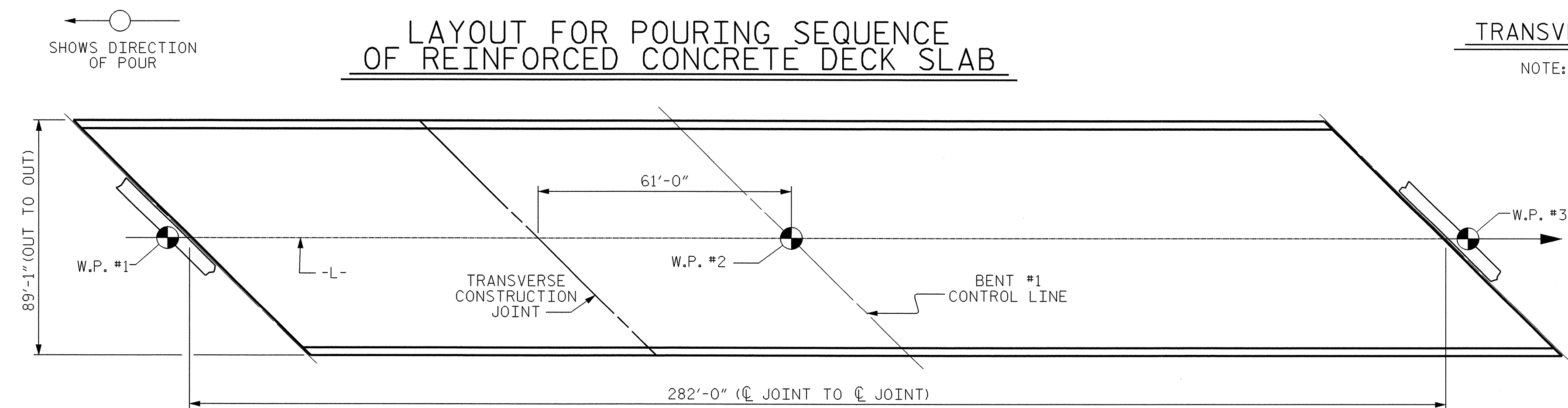

LAYOUT FOR COMPUTING AREA OF REINFORCED CONCRETE DECK SLAB  
AREA CONCRETE DECK SLAB = 25,122 Sq. Ft.

PROJECT NO. I-2102  
FORSYTH COUNTY  
STATION: 20+71.54 -L-

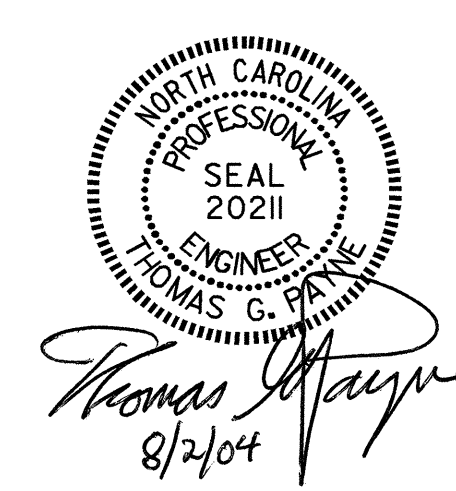

STATE OF NORTH CAROLINA DEPARTMENT OF TRANSPORTATION RALEIGH					
STANDARD SUPERSTRUCTURE BILL OF MATERIAL					
REVISIONS					
NO.	BY:	DATE:	NO.	BY:	DATE:
1			3		
2			4		

ASSEMBLED BY : J.P. ADAMS	DATE : 8/25/03
CHECKED BY : S.H. SOCKWELL	DATE : 10/2/03
DRAWN BY : JMB 5/87	REV. 6/1/94 EEM/GRP
CHECKED BY : SJD 9/87	REV. 8/16/99 RWW/LES

SHEET NO.	
S-31	TOTAL SHEETS 51