

TIP NO.
I-3600

SHEET NO.
SIGN-6

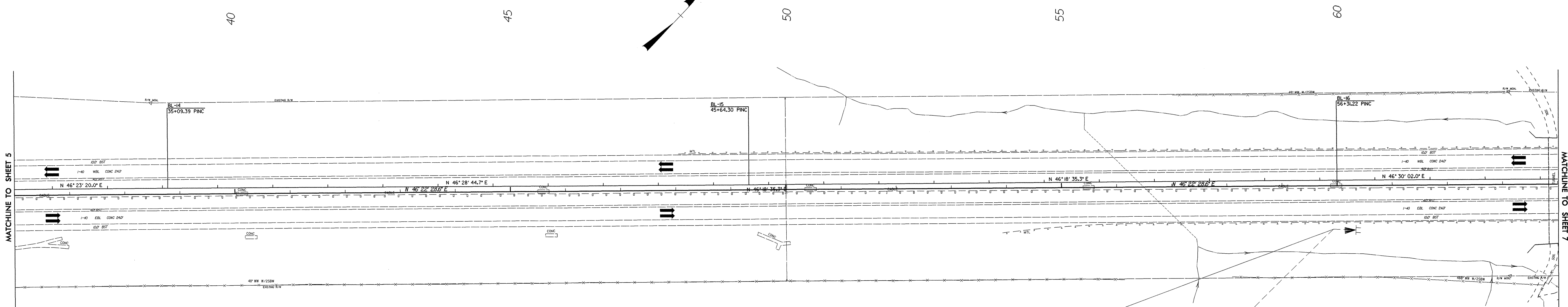
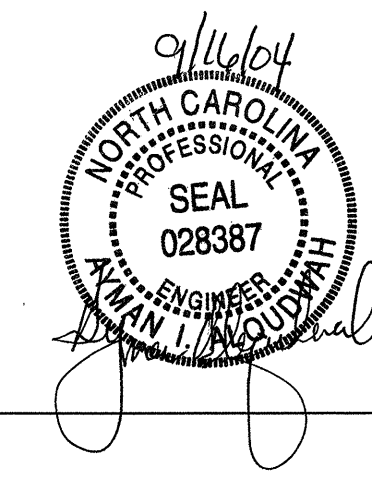

REST AREA
RIGHT LANE
120" X 60"
SEE NOTE 4, A
Sta. 60 + 00
(803)

REST AREA
RIGHT LANE
SEE NOTE 3

PROPOSED & EXISTING SIGNS
STA 37 + 00 TO 64 + 00
I-40