

5/28/99

BM - 6 CHISLED "X" IN 15" RCP IN WEST END, LEFT OF BY-18
N 729771.2919 E 1596920.1830
BL STATION 252+12.22 - 872.82' LT
EL. = 715.55

PROJECT REFERENCE NO. B-4334	SHEET NO. 6
ROADWAY DESIGN ENGINEER	HYDRAULICS ENGINEER

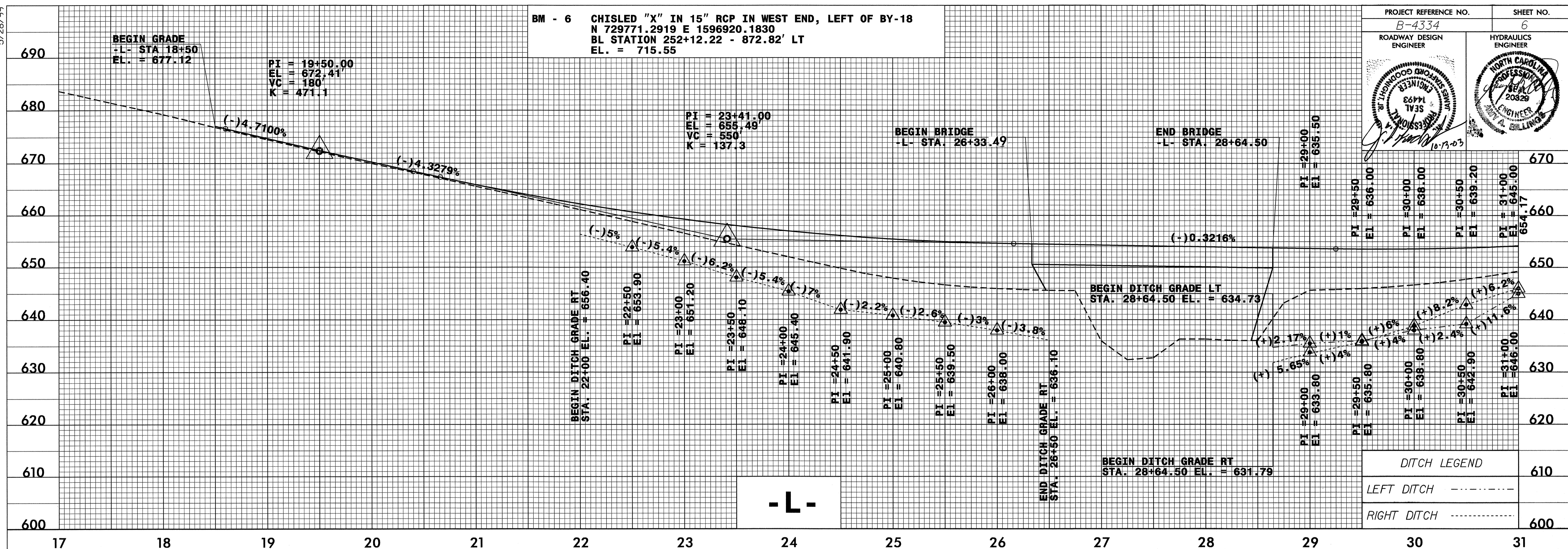

-L-

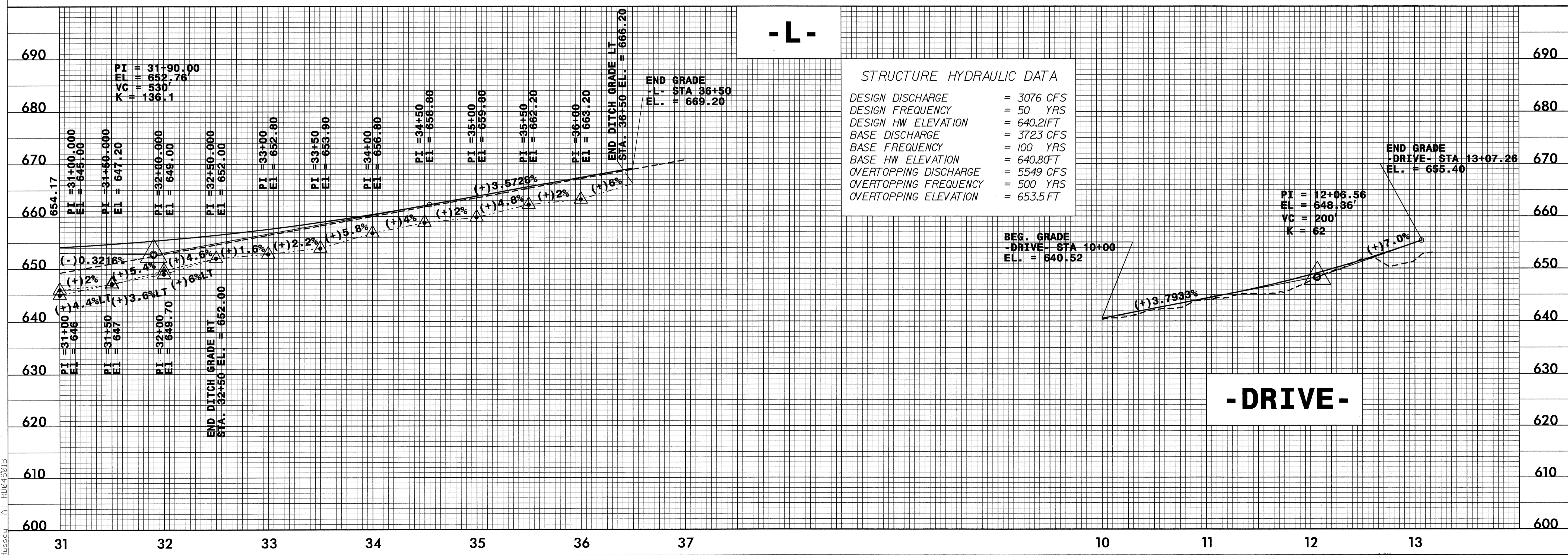

02-OCT-2003 14:5
RD04S01B Thursday October 02 2003 b4334.m MRHussey rd-04oce34