

SURVEY CONTROL SHEET B-3626

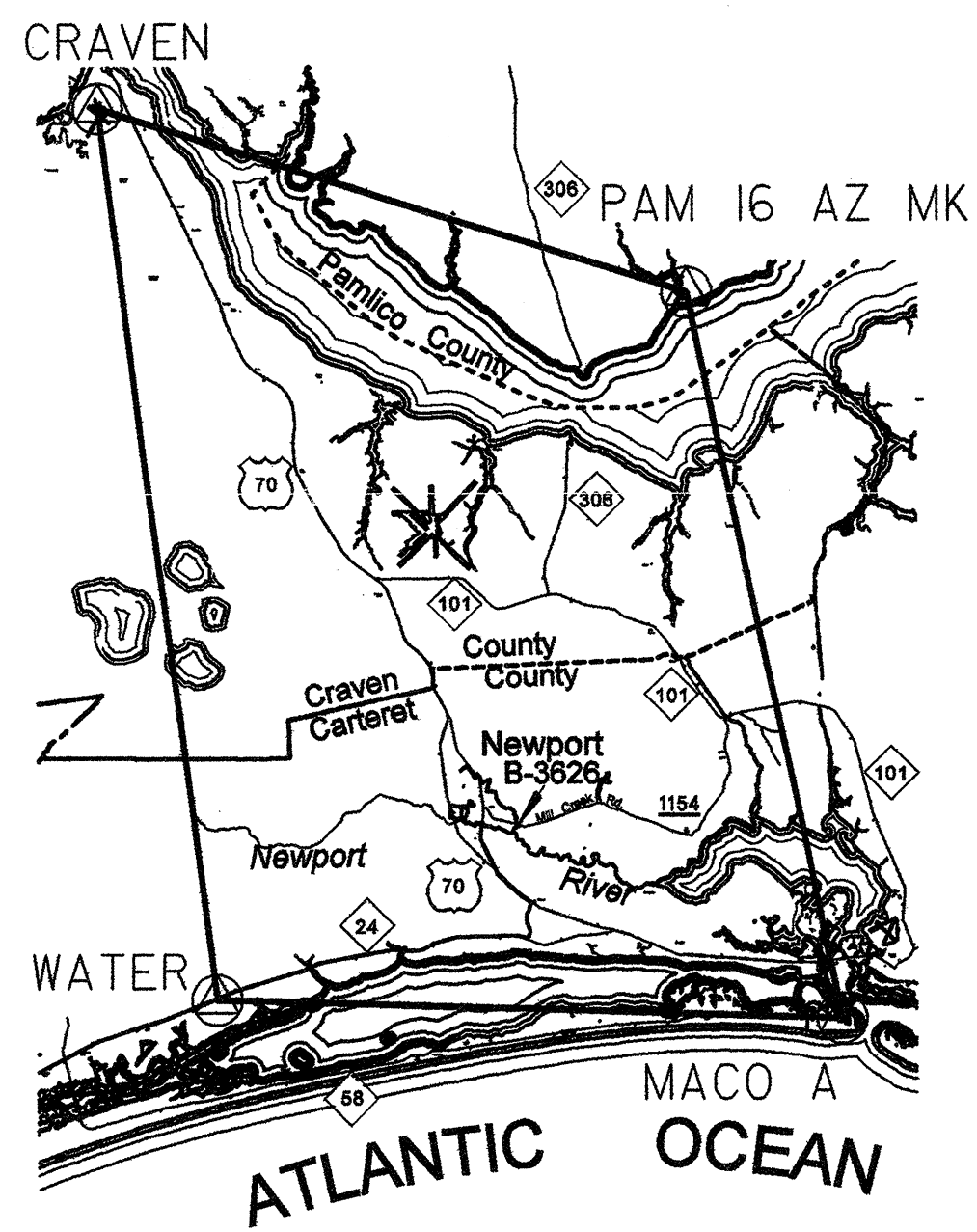

GPS CONTROL NETWORK

CONTROL DATA

BL POINT	DESC.	NORTH	EAST	ELEVATION	L STATION	OFFSET
BL1	BL-1	382034.1976	2647174.8595	2.48	12+48.44	31.69 LT
BL2	BL-2+T1-101	381743.2329	2647868.5966	1.77	19+97.17	23.54 RT
BL3	BL-3	381528.0015	2648538.3134	4.05	26+98.39	20.07 RT

BENCHMARK DATA

.....
 BM1 ELEVATION = 5.94'
 N 382084 E 2647388
 L STATION 14+36 124 LEFT
 RR SPIKE SET IN 24' PINE TREE

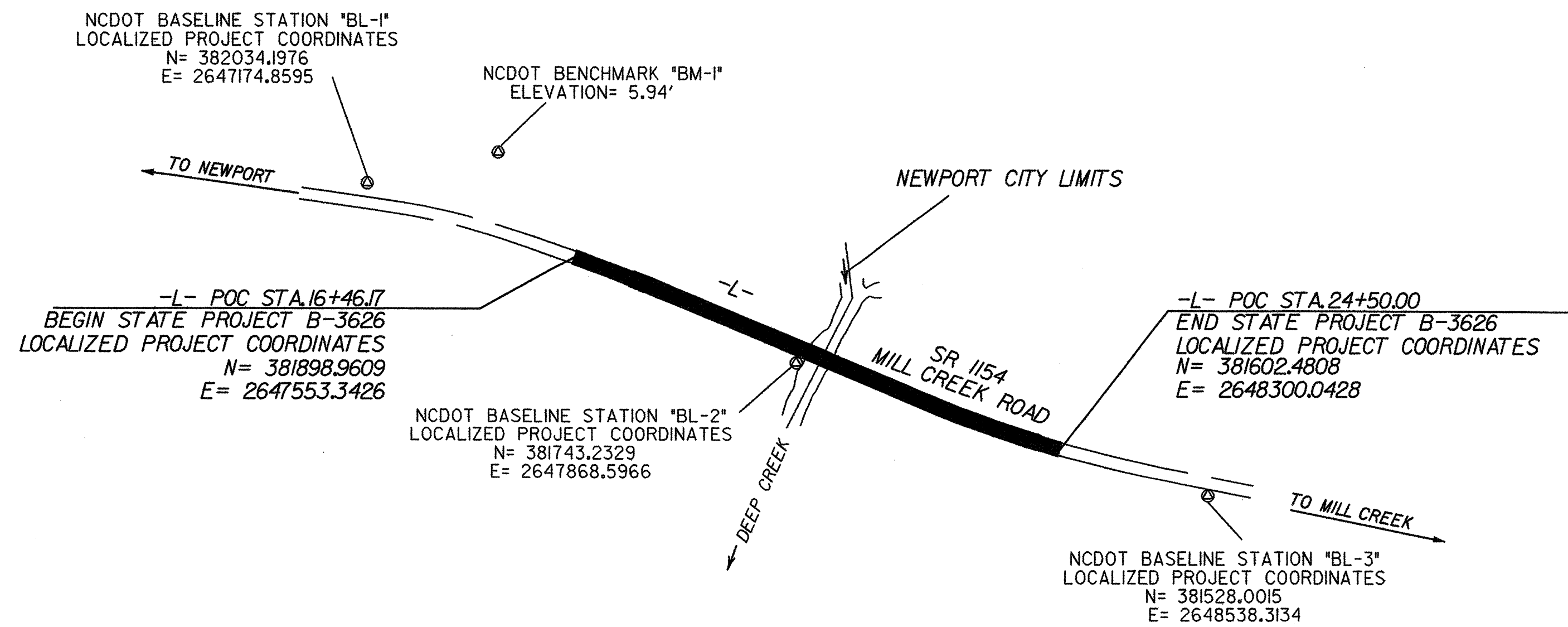

DATUM DESCRIPTION

THE LOCALIZED COORDINATE SYSTEM DEVELOPED FOR THIS PROJECT IS BASED ON THE STATE PLANE COORDINATES ESTABLISHED BY NCDOT FOR MONUMENT "B3626-1" WITH NAD 1983/95 STATE PLANE GRID COORDINATES OF NORTHING: 382161.0700(F) EASTING: 2646490.7480(F) THE AVERAGE COMBINED GRID FACTOR USED ON THIS PROJECT (GROUND TO GRID) IS: 0.999911710 THE N.C. LAMBERT GRID BEARING AND LOCALIZED HORIZONTAL GROUND DISTANCE FROM "B3626-1" TO -L- STATION 16+46.17 IS S 76°08'36.7" E 1094.444' ALL LINEAR DIMENSIONS ARE LOCALIZED HORIZONTAL DISTANCES VERTICAL DATUM USED IS NAVD 88

NOTES:

THE CONTROL DATA FOR THIS PROJECT CAN BE FOUND ELECTRONICALLY BY SELECTING PROJECT CONTROL DATA AT:

HTTP://WWW.DOH.DOT.STATE.NC.US/PRECONSTRUCT/HIGHWAY/LOCATION/PROJECT
 FILE: b3626_ls_control_031008.txt

SITE CALIBRATION INFORMATION HAS NOT BEEN PROVIDED FOR THIS PROJECT. IF FURTHER INFORMATION IS NEEDED, PLEASE CONTACT THE LOCATION AND SURVEYS UNIT.

© INDICATES GEODETIC CONTROL MONUMENTS USED OR SET FOR HORIZONTAL PROJECT CONTROL BY THE NCDOT LOCATION AND SURVEYS UNIT.

PROJECT CONTROL ESTABLISHED USING GLOBAL POSITIONING SYSTEM.

NOTE: DRAWING NOT TO SCALE

6/2/99 6/2/99
 SYSTEM FILE: \\STATE.NC.US\GIS\DATA\PROJECTS\B3626\B3626-1\CONTROL\B3626-1_CONTROL_031008.TXT