

STATE	STATE PROJECT REFERENCE NO.	SHEET NO.	TOTAL SHEETS
N.C.	B-3626		
STATE PROJ. NO.	F.A. PROJ. NO.	DESCRIPTION	
33174.1.1	BRSTP-1154(2)	PE	
33174.2.2	BRSTP-1154(2)	RW & UTILITY	
33174.3.2	BRSTP-1154(3)	CONSTR.	

STATE OF NORTH CAROLINA  
DIVISION OF HIGHWAYS

**CARTERET COUNTY**

LOCATION: BRIDGE NO. 26 OVER DEEP CREEK AND APPROACHES  
ON SR 1154 (MILL CREEK ROAD)

TYPE OF WORK: GRADING, DRAINAGE, PAVING, AND STRUCTURES

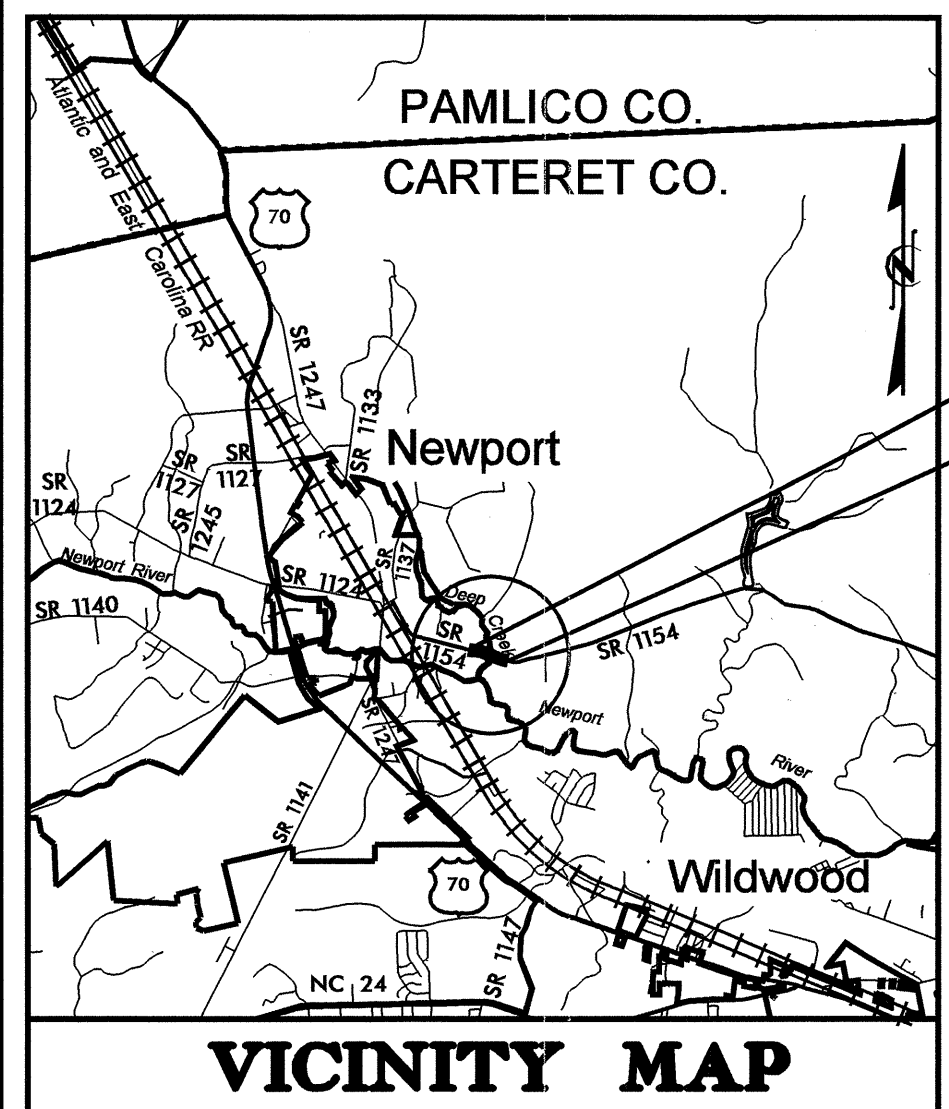

BEGIN PROJECT  
END PROJECT

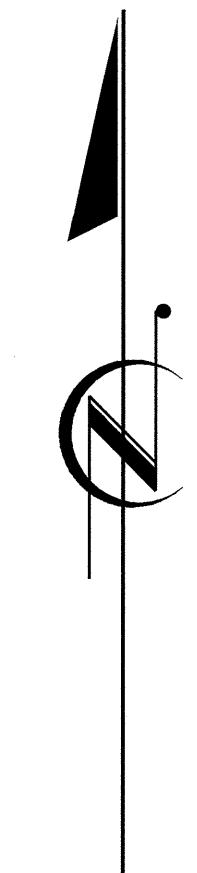
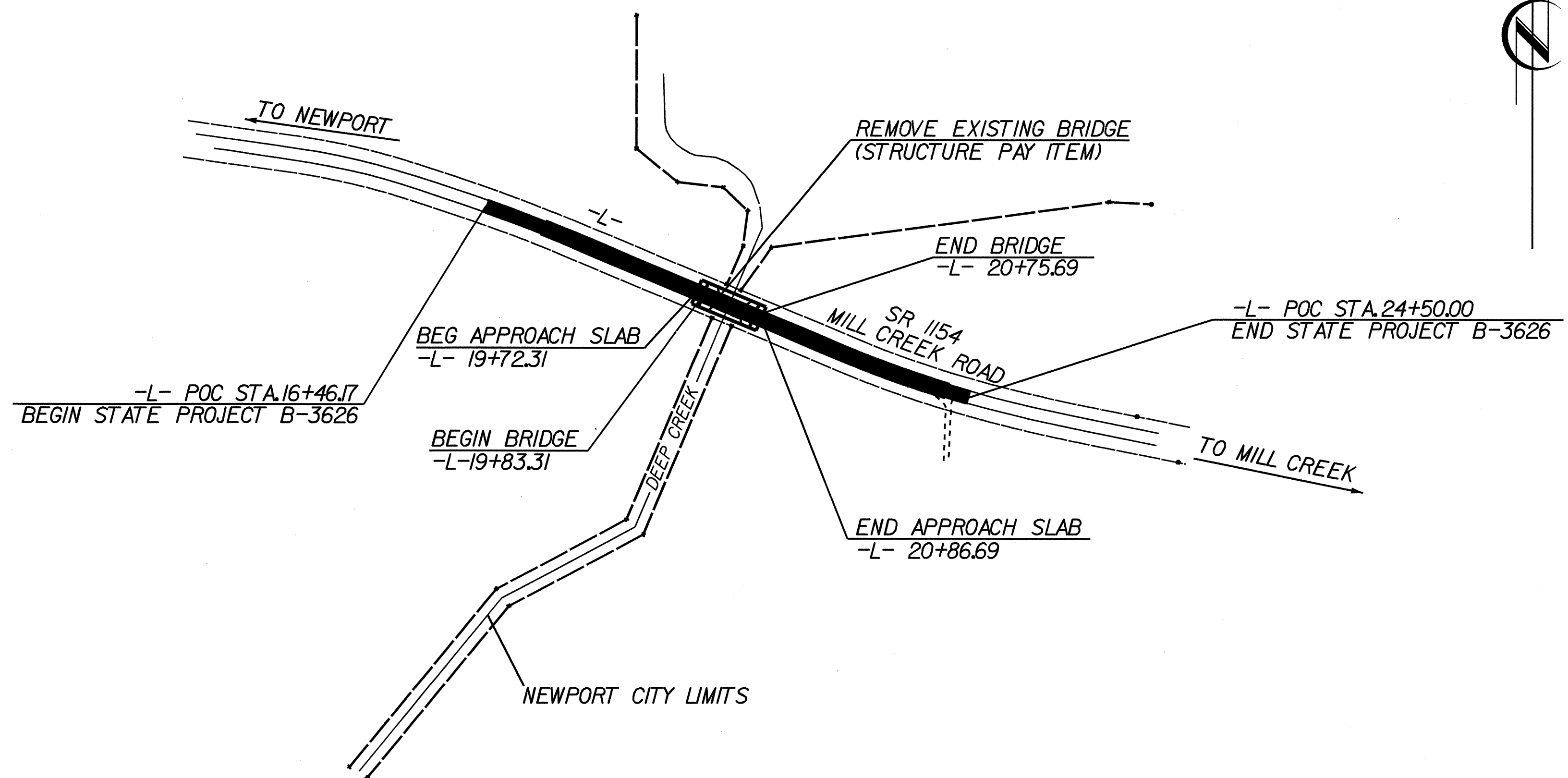

**STRUCTURE**

CONTRACT: C200818 TIP PROJECT: B-3626

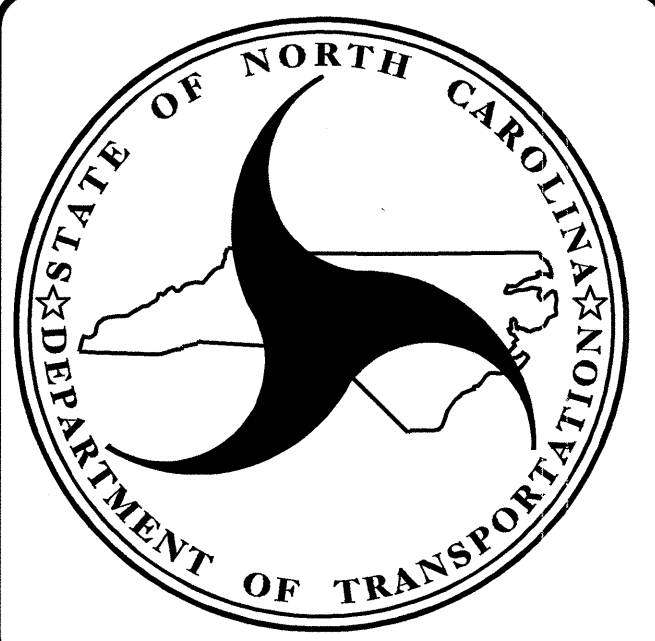

**DESIGN DATA**

ADT 2001 = 1500  
ADT 2025 = 3000  
DHV = 20%  
D = 70%  
T = 4%\*  
V = 60 MPH

\* TTST 1% DUAL 3%

**PROJECT LENGTH**

LENGTH ROADWAY TIP PROJECT B-3626 = 0.135 mi  
LENGTH STRUCTURES TIP PROJECT B-3626 = 0.017 mi  
TOTAL LENGTH TIP PROJECT B-3626 = 0.152 mi

Prepared in the Office of:  
**DIVISION OF HIGHWAYS**

2002 STANDARD SPECIFICATIONS

R.M. GIROLAMI, P. E.  
PROJECT ENGINEER

L.E. SUTTON, P. E.  
PROJECT DESIGN ENGINEER

LETTING DATE:  
DECEMBER 21, 2004

STRUCTURE DESIGN UNIT  
1000 BIRCH RIDGE DR.  
RALEIGH, N.C. 27610

*Gregory R. Perretti*  
3/1/04

DIVISION OF HIGHWAYS  
STATE OF NORTH CAROLINA

P.E.  
STATE DESIGN ENGINEER

DEPARTMENT OF TRANSPORTATION  
FEDERAL HIGHWAY ADMINISTRATION

APPROVED  
DIVISION ADMINISTRATOR

DATE