

UTILITIES BY OTHERS

NOTE:
ALL PROPOSED UTILITY WORK SHOWN ON THIS SHEET WILL BE DONE BY OTHERS

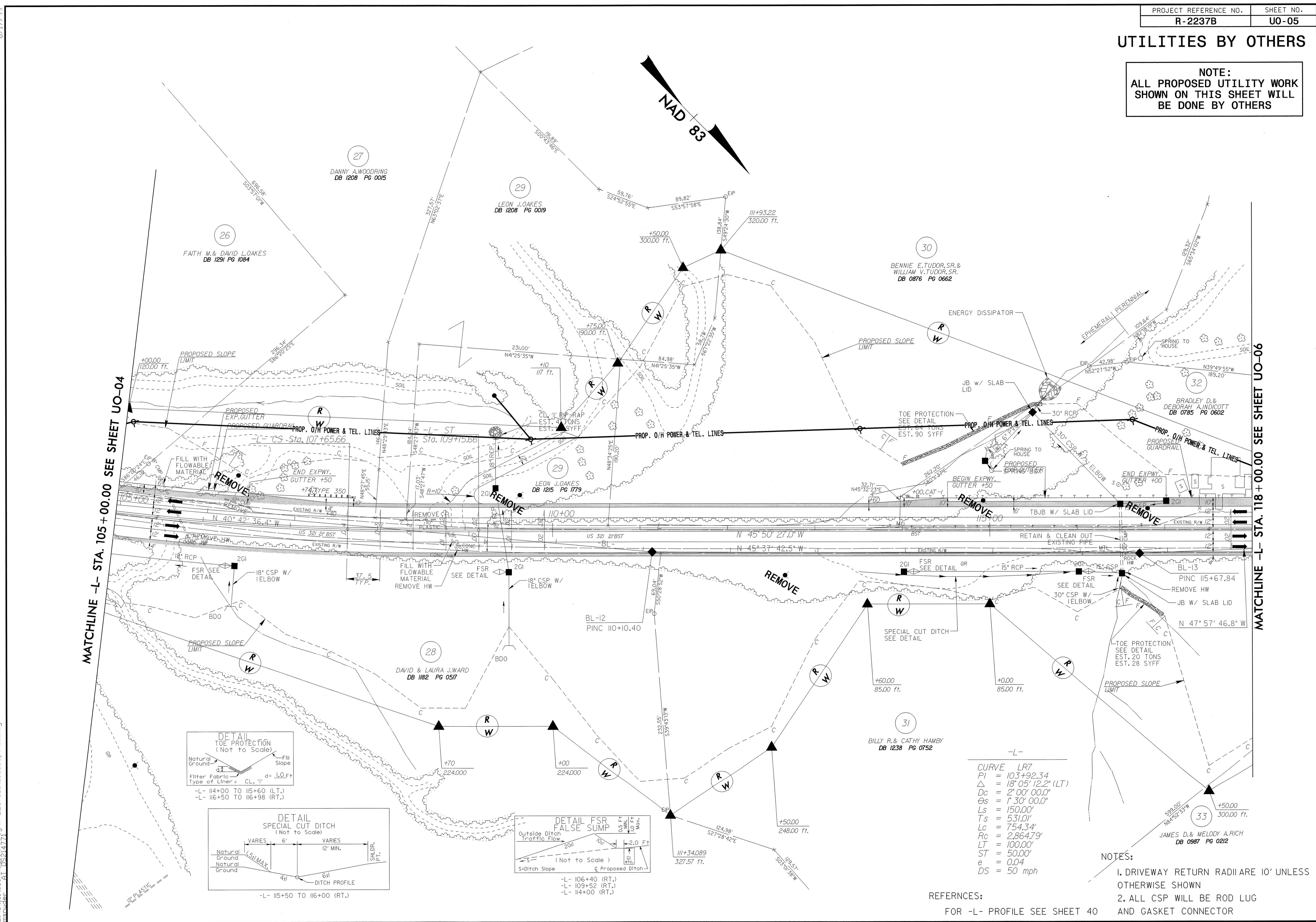

MATCHLINE -L- STA. 105 + 00.00 SEE SHEET UO-04

MATCHLINE -L- STA. 118 + 00.00 SEE SHEET UO-06

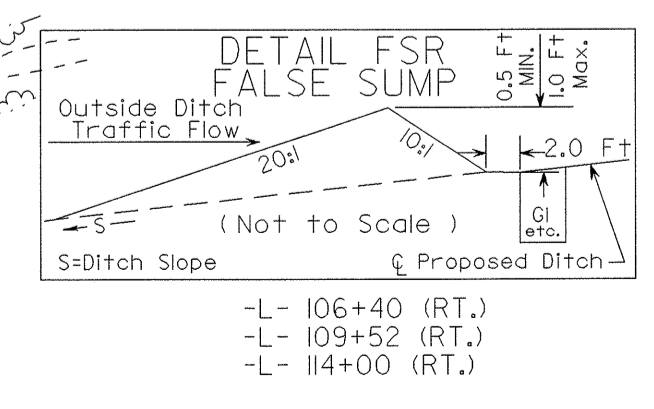
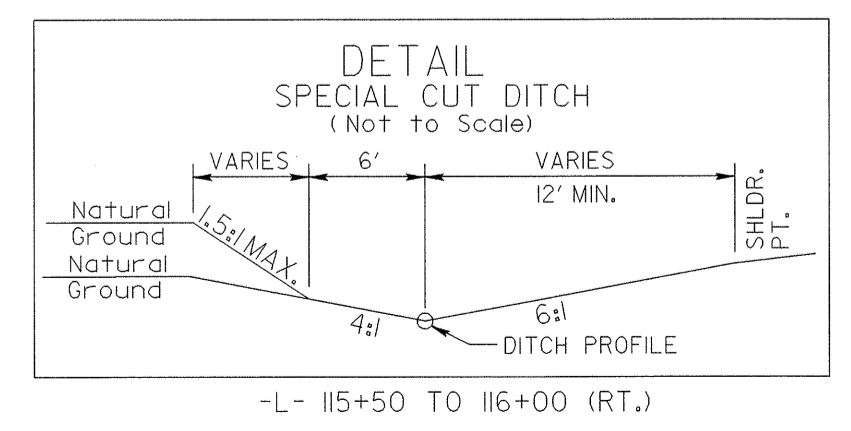
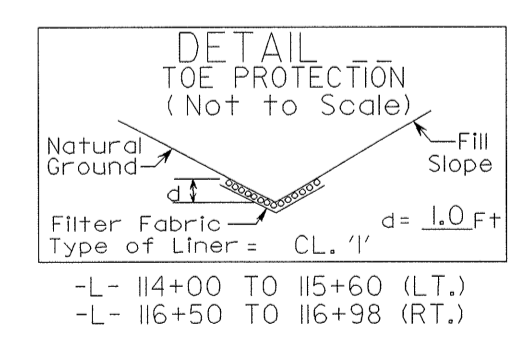

-L-
CURVE LR7
PI = 103+92.34
Δ = 18° 05' 12.2" (LT.)
Dc = 2° 00' 00.0"
Θs = 1° 30' 00.0"
Ls = 150.00'
Ts = 531.01'
Lc = 754.34'
Rc = 2,864.79'
LT = 100.00'
ST = 50.00'
e = 0.04
DS = 50 mph

REFERENCES:
FOR -L- PROFILE SEE SHEET 40

NOTES:
1. DRIVEWAY RETURN RADII ARE 10' UNLESS OTHERWISE SHOWN
2. ALL CSP WILL BE ROD LUG AND GASKET CONNECTOR

8/17/99
C:\CSP\2004\15r40\15r40_P1.dwg
P:\CSP\2004\15r40\15r40_P1.dwg
R-2237b_ut_UO_05psh_12.dgn
msouder