

-L-
 CURVE LR9
 PI = 157+24.39
 Δ = 64° 47' 41" (RT)
 Dc = 7' 30" 00.0"
 Θ s = 10° 30' 00.0"
 Ls = 280.00'
 Ts = 627.32'
 Lc = 583.93'
 Rc = 763.94'
 LT = 187.00'
 ST = 93.63'
 e = 0.08
 DS = 50 mph

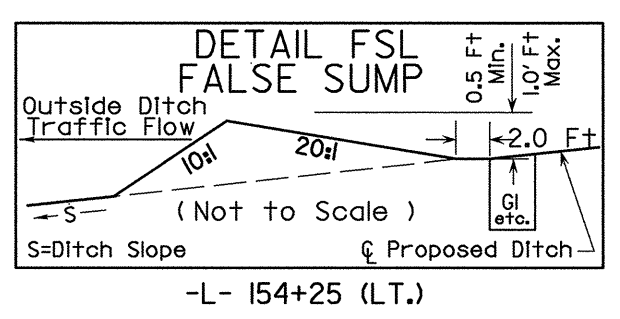
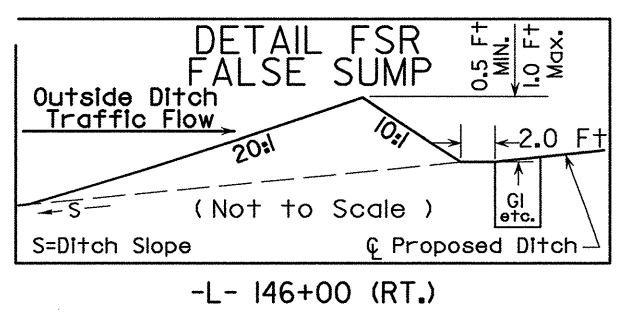
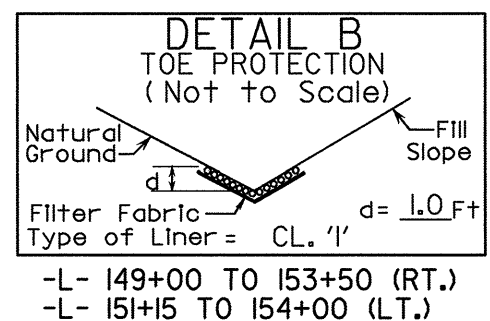
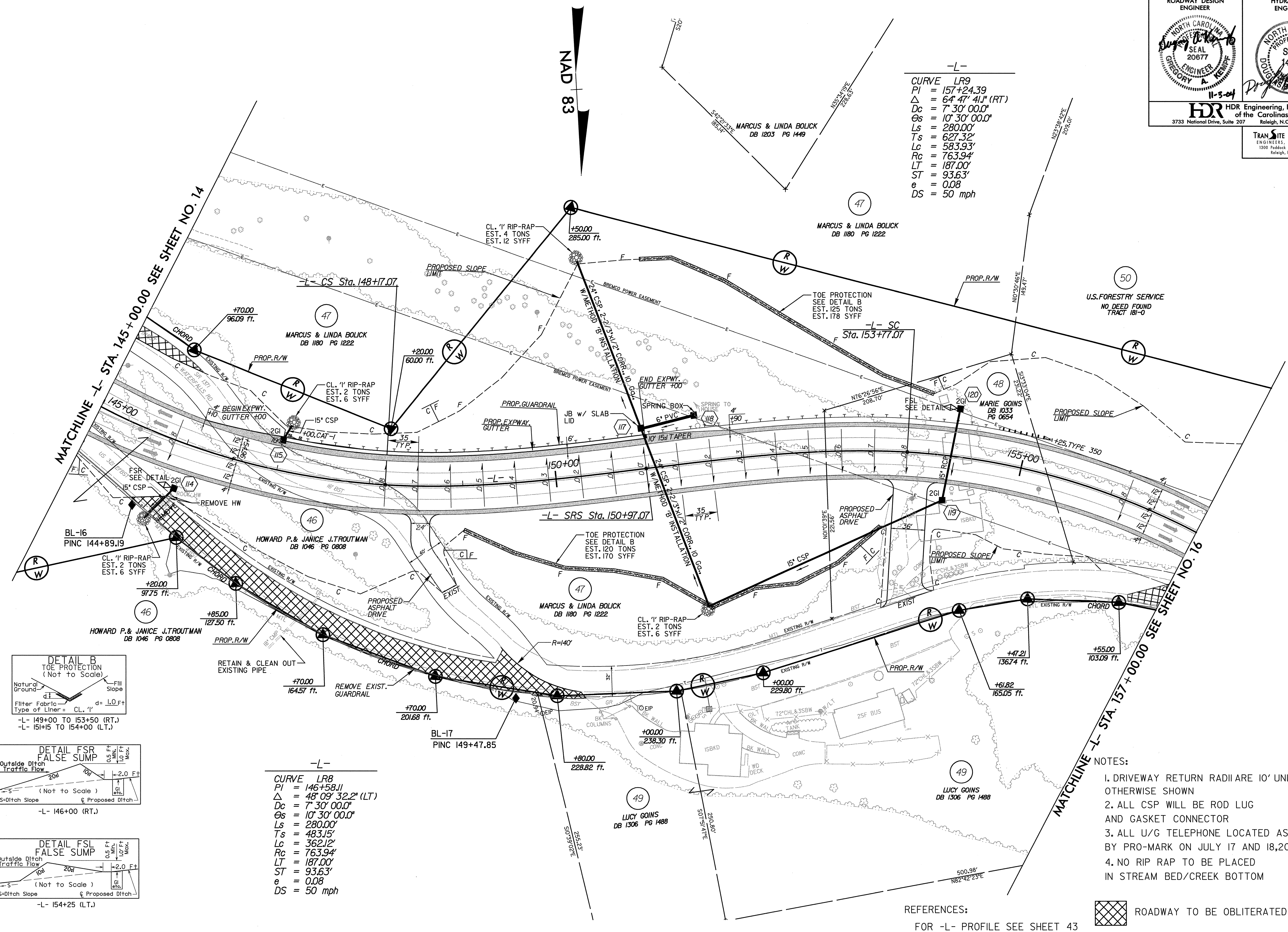

-L-
 CURVE LR8
 PI = 146+58.11
 Δ = 48° 09' 32.2" (LT)
 Dc = 7' 30" 00.0"
 Θ s = 10° 30' 00.0"
 Ls = 280.00'
 Ts = 483.15'
 Lc = 362.12'
 Rc = 763.94'
 LT = 187.00'
 ST = 93.63'
 e = 0.08
 DS = 50 mph

- NOTES:
1. DRIVEWAY RETURN RADII ARE 10' UNLESS OTHERWISE SHOWN
 2. ALL CSP WILL BE ROD LUG AND GASKET CONNECTOR
 3. ALL U/G TELEPHONE LOCATED AS MARKED BY PRO-MARK ON JULY 17 AND 18, 2000
 4. NO RIP RAP TO BE PLACED IN STREAM BED/CREEK BOTTOM

REFERENCES:
 FOR -L- PROFILE SEE SHEET 43



REVISIONS

8/17/99

1/02/2004