

NOTE:
DESIGN EXCEPTION REQUIRED FOR MAX. GRADE
STA. -L- 31+70 TO STA. -L- 69+50

REFERENCE: FOR PLAN VIEW SEE
PLAN SHEET 06

BM-2 RR SPIKE IN BASE OF A 15' YELLOW
POPLAR TREE.
59.74 FEET LEFT OF -L- STA. 35+35.26
ELEV. 1527.56

- L -

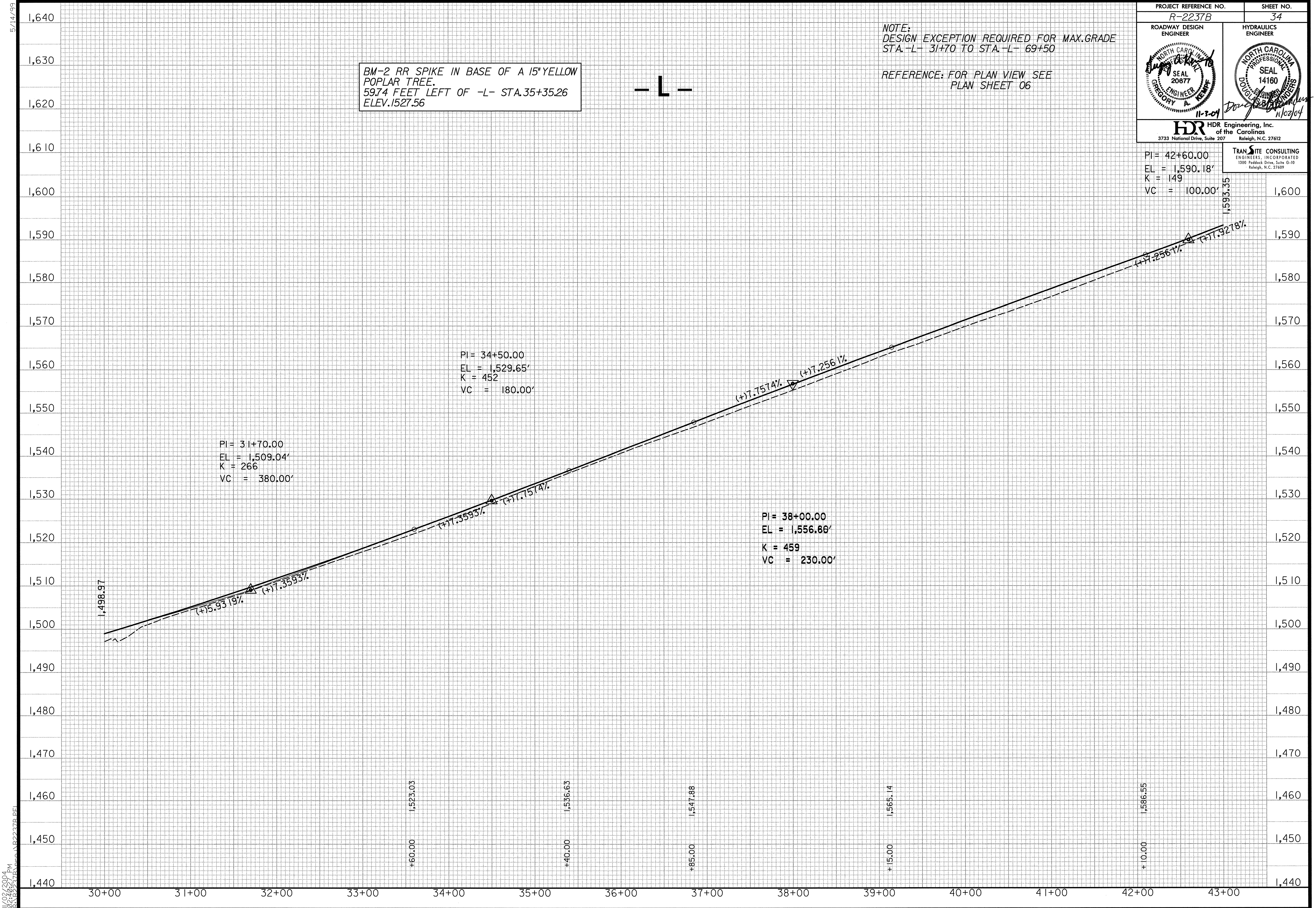

5/14/04
11/09/2004 02:40:20 PM
R:\2237B\ENR\2237B.PE1