

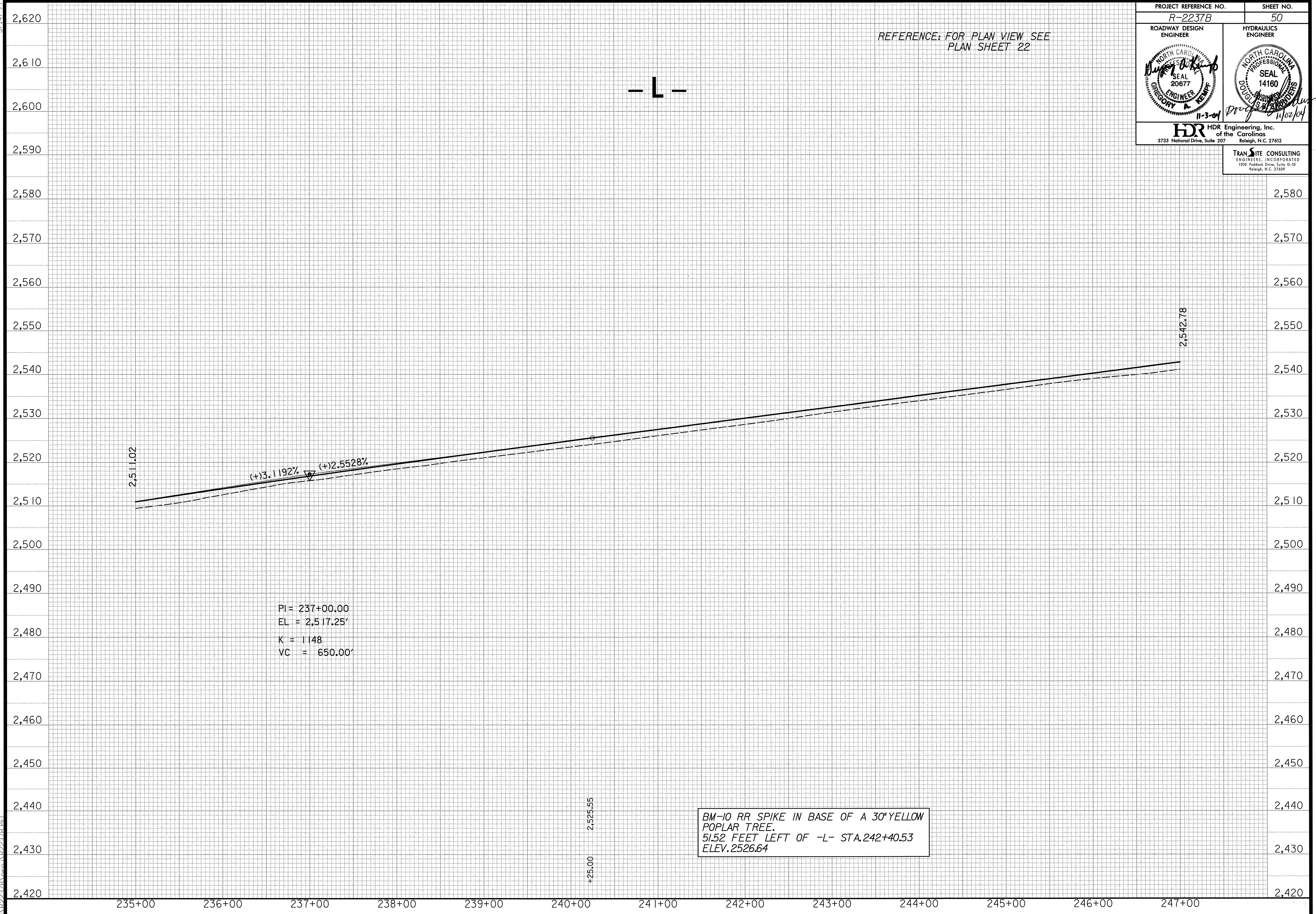

REFERENCE: FOR PLAN VIEW SEE PLAN SHEET 22

- L -



2,511.02

(+)3.1192%  
(+)2.5528%

PI = 237+00.00  
EL = 2,517.25'  
K = 1148  
VC = 650.00'

2,525.55  
+25.00

BM-10 RR SPIKE IN BASE OF A 30" YELLOW POPLAR TREE.  
51.52 FEET LEFT OF -L- STA. 242+40.53  
ELEV. 2526.64

2,542.78

5/14/04  
1/22/2004 PM  
R-2237B-50