

NOTE:
DESIGN EXCEPTION REQUIRED FOR MAX.GRADE
STA.-L- 328+60 TO STA.-L- 337+15

REFERENCE: FOR PLAN VIEW SEE
PLAN SHEET 29

BM-13 RR SPIKE IN BASE OF A 30" BUR OAK
TREE.
369.72 FEET RIGHT OF -L- STA.324+78.60
ELEV.2822.47

PI = 328+60.00
EL = 2,831.78'
K = 96
VC = 490.00'

PIPE HYDRAULIC DATA		
DRAINAGE STRUCTURE NO. _		
DRAINAGE AREA	= 21.0	AC
DESIGN FREQUENCY	= 50	YRS
DESIGN DISCHARGE	= 30.0	CFS
DESIGN HW ELEVATION	= 2745.58	FT
100 YEAR DISCHARGE	= 36.0	CFS
100 YEAR HW ELEVATION	= 2746.50	FT
OVERTOPPING FREQUENCY	= 500+	YRS
OVERTOPPING DISCHARGE	= OFF CHART	CFS
OVERTOPPING ELEVATION	= 2810.46	FT

PI = 333+30.00
EL = 2,869.16'
K = 1062
VC = 300.00'

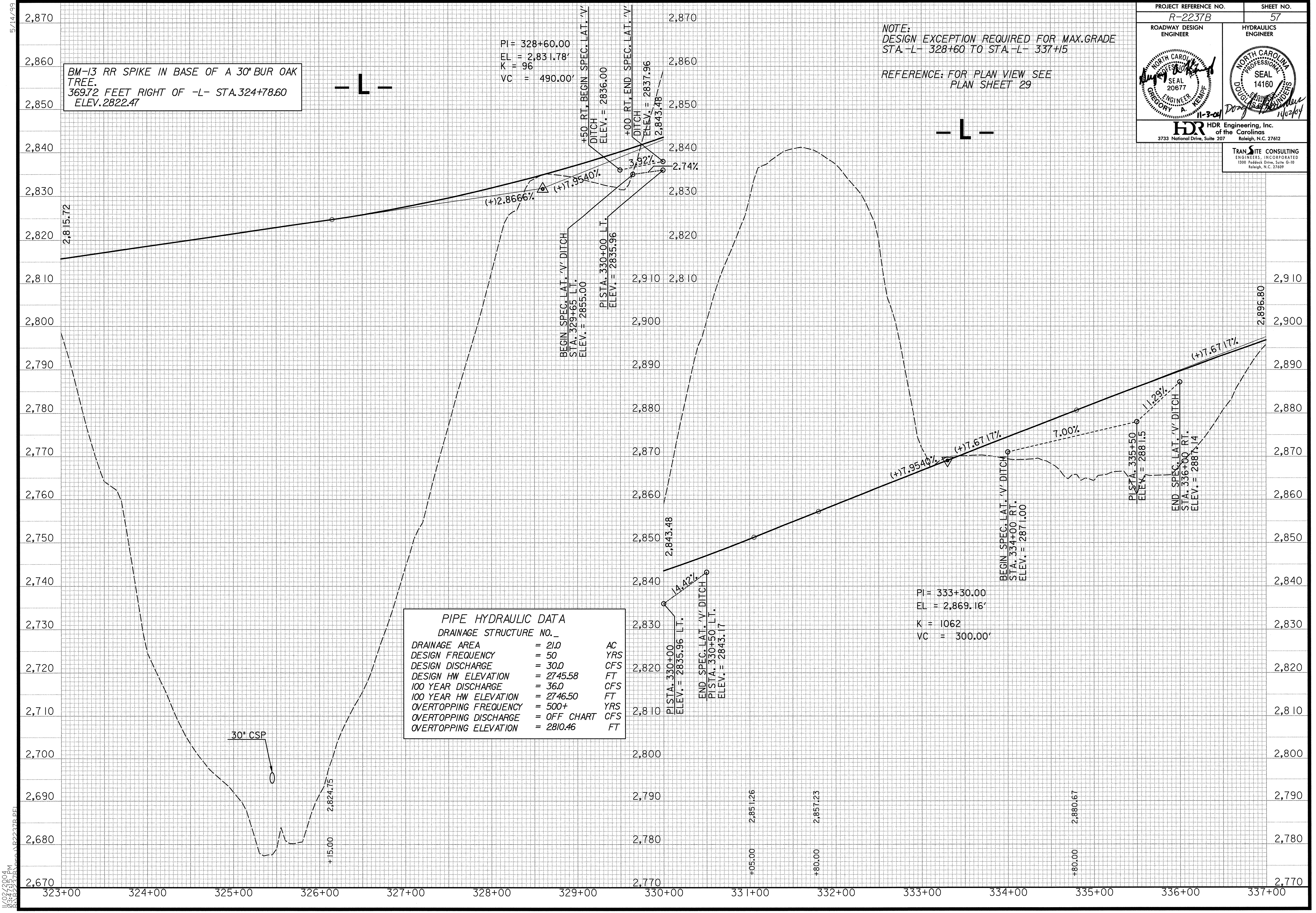

5/14/99
11/02/2004
03:47:15 PM
R-2237B.dwg
R-2237B.dwg