

Rev. 12/12/00

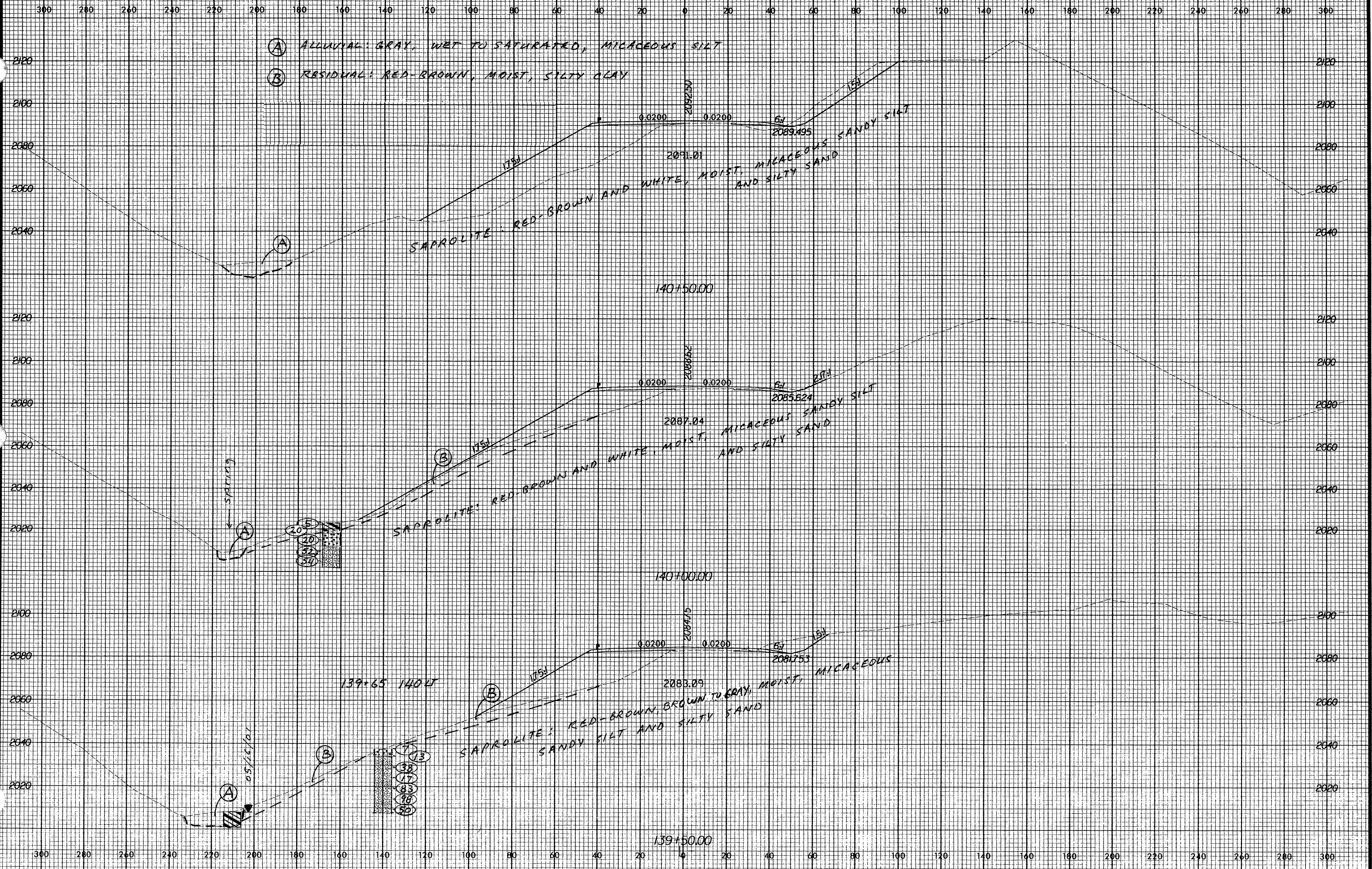

(A) ALLUVIAL: GRAY, WET TO SATURATED, MICACEOUS SILT

(B) RESIDUAL: RED-BROWN, MOIST, SILTY CLAY

SAPROLITE: RED-BROWN AND WHITE, MOIST, MICACEOUS SANDY SILT AND SILTY SAND

140+50.00

SAPROLITE: RED-BROWN AND WHITE, MOIST, MICACEOUS SANDY SILT AND SILTY SAND

140+00.00

SAPROLITE: RED-BROWN, BROWN TO GRAY, MOIST, MICACEOUS SANDY SILT AND SILTY SAND

139+50.00

05/16/01

0 AUG 2001
2:13:33 PM
33751751.mxd