

PROJECT REFERENCE NO.	SHEET NO.
R-2237B	EC-3/CONST.4
RW SHEET NO.	
ROADWAY DESIGN ENGINEER	HYDRAULICS ENGINEER

**CLEARING AND GRUBBING  
EROSION CONTROL FOR  
CONSTRUCTION SHEET 4**

NOTE:  
PLACE TEMPORARY ROCK SEDIMENT DAMS TYPE-B  
AND TEMPORARY ROCK SILT CHECKS TYPE-A AT  
DRAINAGE OUTLETS.

 ENVIRONMENTALLY SENSITIVE AREA  
SEE PROJECT SPECIAL PROVISIONS

## DATUM DESCRIPTION

THE LOCALIZED COORDINATE SYSTEM DEVELOPED FOR THIS PROJECT IS BASED ON THE STATE PLANE COORDINATES ESTABLISHED BY NCDOT FOR MONUMENT "R2237B-6" WITH NAD 83 STATE PLANE GRID COORDINATES OF NORTHING: 854180.257(ft) EASTING: 1226839.328(ft) THE AVERAGE COMBINED GRID FACTOR USED ON THIS PROJECT (GROUND TO GRID) IS: .999908500 THE N.C. LAMBERT GRID BEARING AND LOCALIZED HORIZONTAL GROUND DISTANCE FROM "R2237B-6" TO L- STATION 9+86.41 IS S 25° 54' 15.57" E DIST 14811.136 (ft) ALL LINEAR DIMENSIONS ARE LOCALIZED HORIZONTAL DISTANCES VERTICAL DATUM USED IS NGVD 29

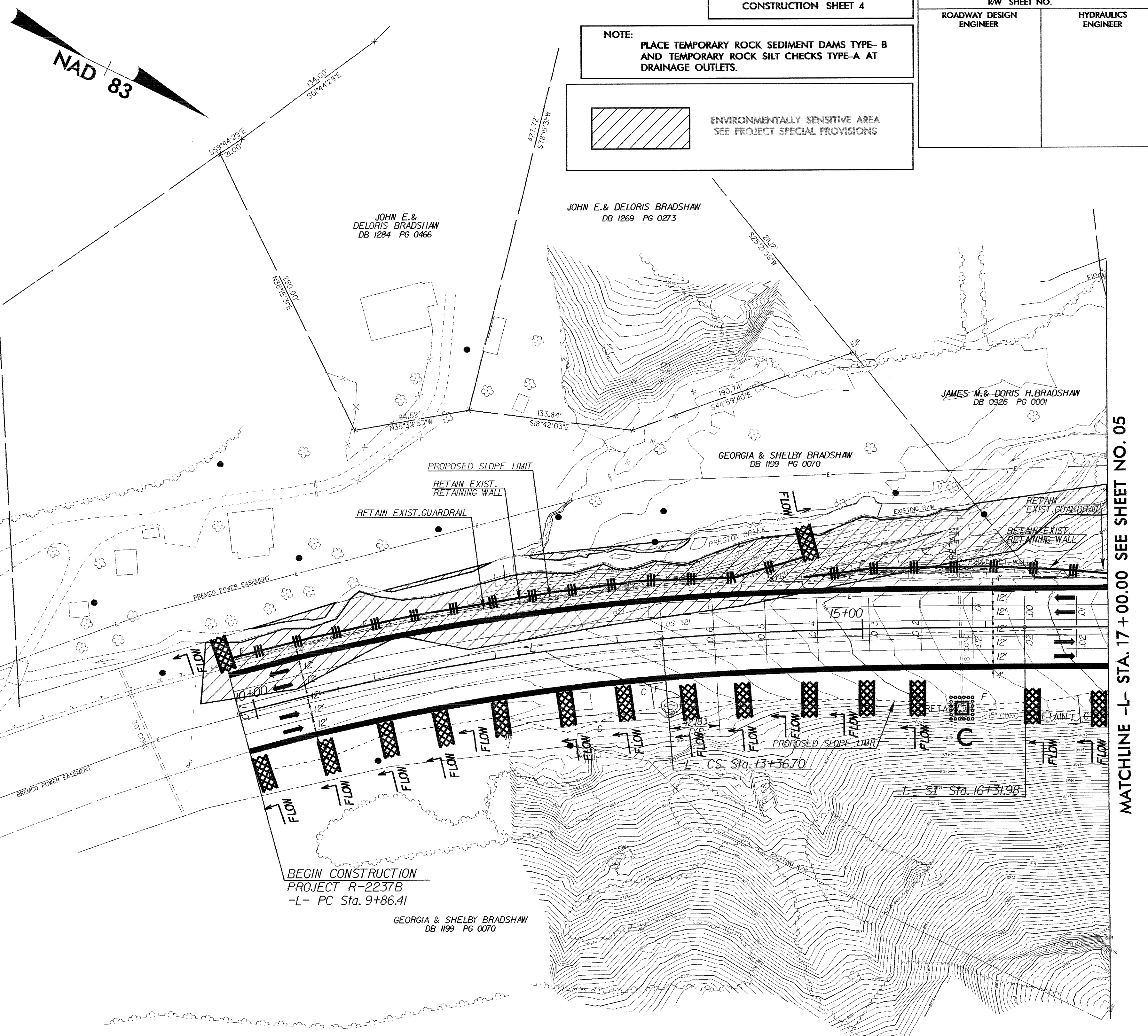

R2237B-2  
BL- POT 5+00.00 =  
BYI- POT 5+00.00

BEGIN CONSTRUCTION  
PROJECT R-2237B  
-L- PC Sta. 9+86.41

GEORGIA & SHELBY BRADSHAW  
DB 1199 PG 0070

-L-  
CURVE LRI PIs Sta 14+35.18  
PI Sta 11+62.04 Ps = 4' 24' 26.8"  
Δ = 10° 27' 25.5" (RT) Cs = 295.28'  
D = 2' 59' 06.9" LT = 196.91'  
L = 350.29 ST = 98.48'  
T = 175.63'  
R = 1,919.29'  
e = 0.07  
DS = 50 mph

- NOTES:
1. DRIVEWAY RETURN RADII ARE 10' UNLESS OTHERWISE SHOWN
  2. ALL CSP WILL BE ROD LUG AND GASKET CONNECTOR

REFERENCES:  
FOR -L- PROFILE SEE SHEET 32

MATCHLINE -L- STA. 17+00.00 SEE SHEET NO. 05