

6/09/11

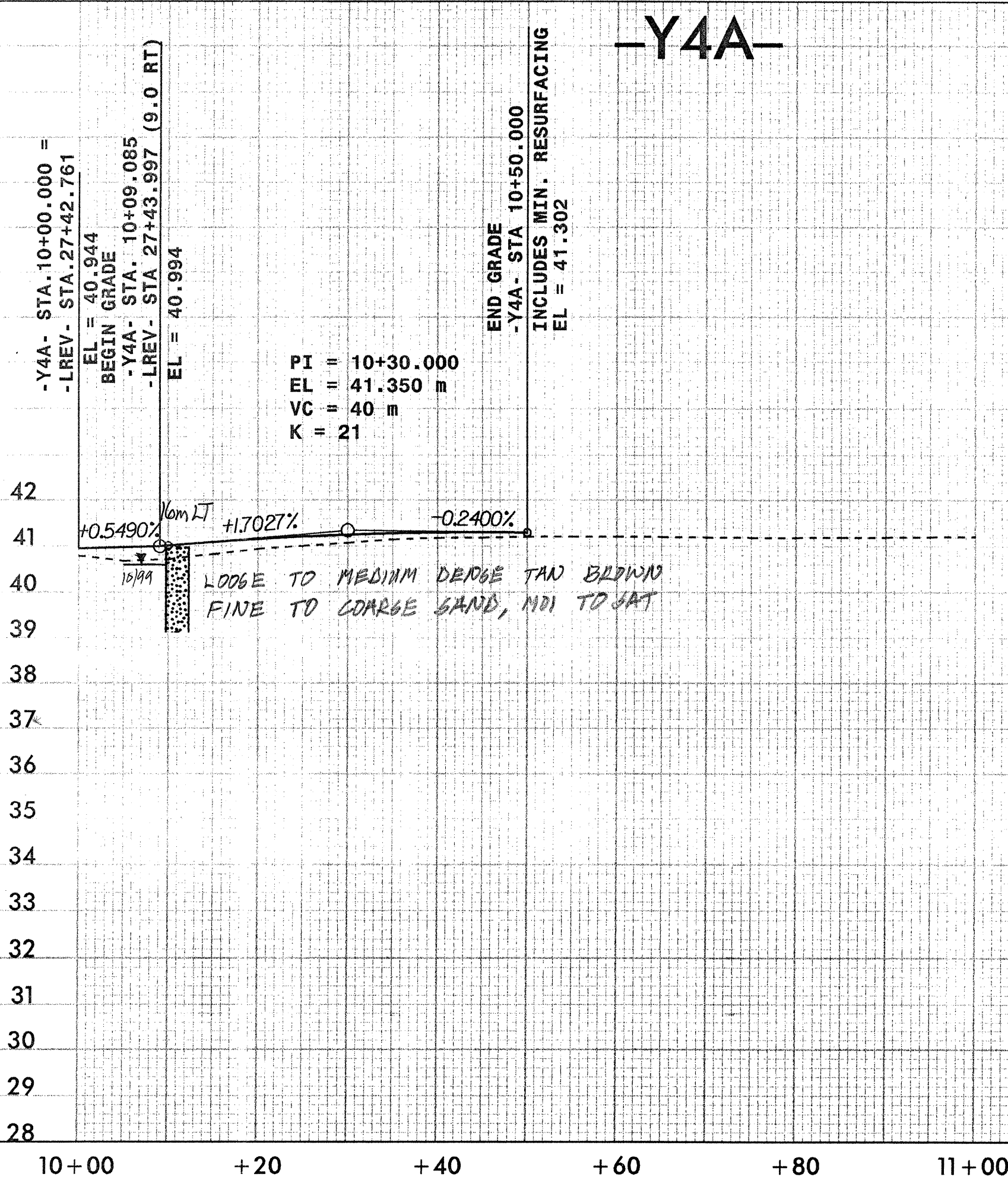

| | |
|--|---------------------|
| PROJECT REFERENCE NO. R-2562D | SHEET NO. 43 |
| ROADWAY DESIGN ENGINEER | HYDRAULICS ENGINEER |
| INCOMPLETE PLANS <small>DO NOT USE FOR R/W ACQUISITION</small> PRELIMINARY PLANS <small>DO NOT USE FOR CONSTRUCTION</small> | |
| CONST. REV. | |
| R / W REV. | |

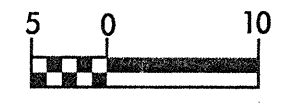

TBM #17 -LREV- STA 20+37.57
 OFFSET 71.889 LT. RR SPIKE SET
 IN BASE OF 18" COTTONWOOD TREE
 ELEV. 37.901

-Y5-

SEE SHEET 9 FOR PLAN VIEW

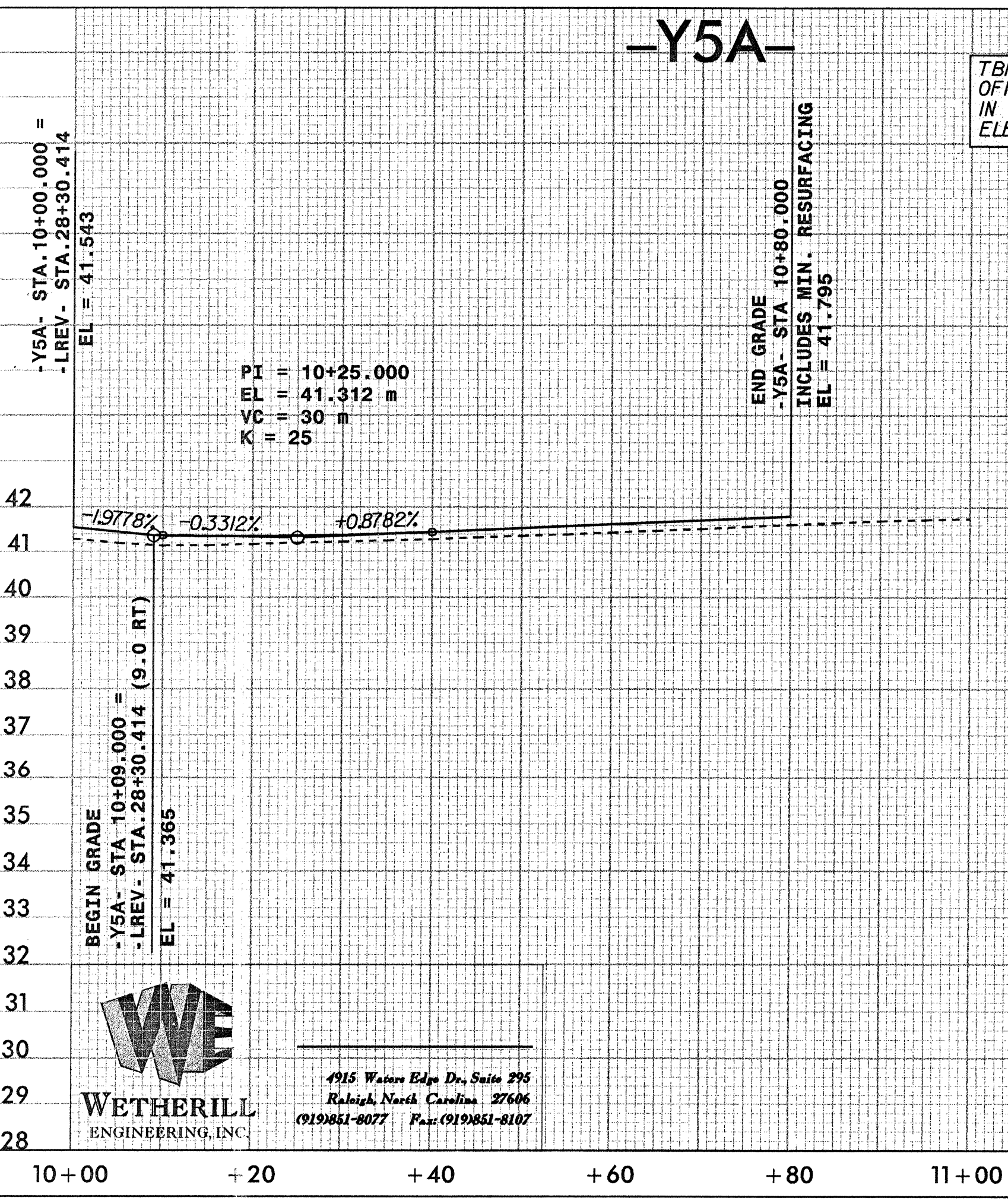

TBM #19 -LREV- STA 32+08.016
 OFFSET 51.79 LT. RR SPIKE SET
 IN BASE OF 22" PINE TREE
 ELEV. 42.364

BM GPS (R2562CD-8)
 -LREV- STA 32+35.217
 OFFSET 7.657 RT.
 ELEV. 43.275

BM GPS (R2562CD-9)
 -LREV- STA 35+25.233
 OFFSET 5.903 RT.
 ELEV. 44.942

-Y6-

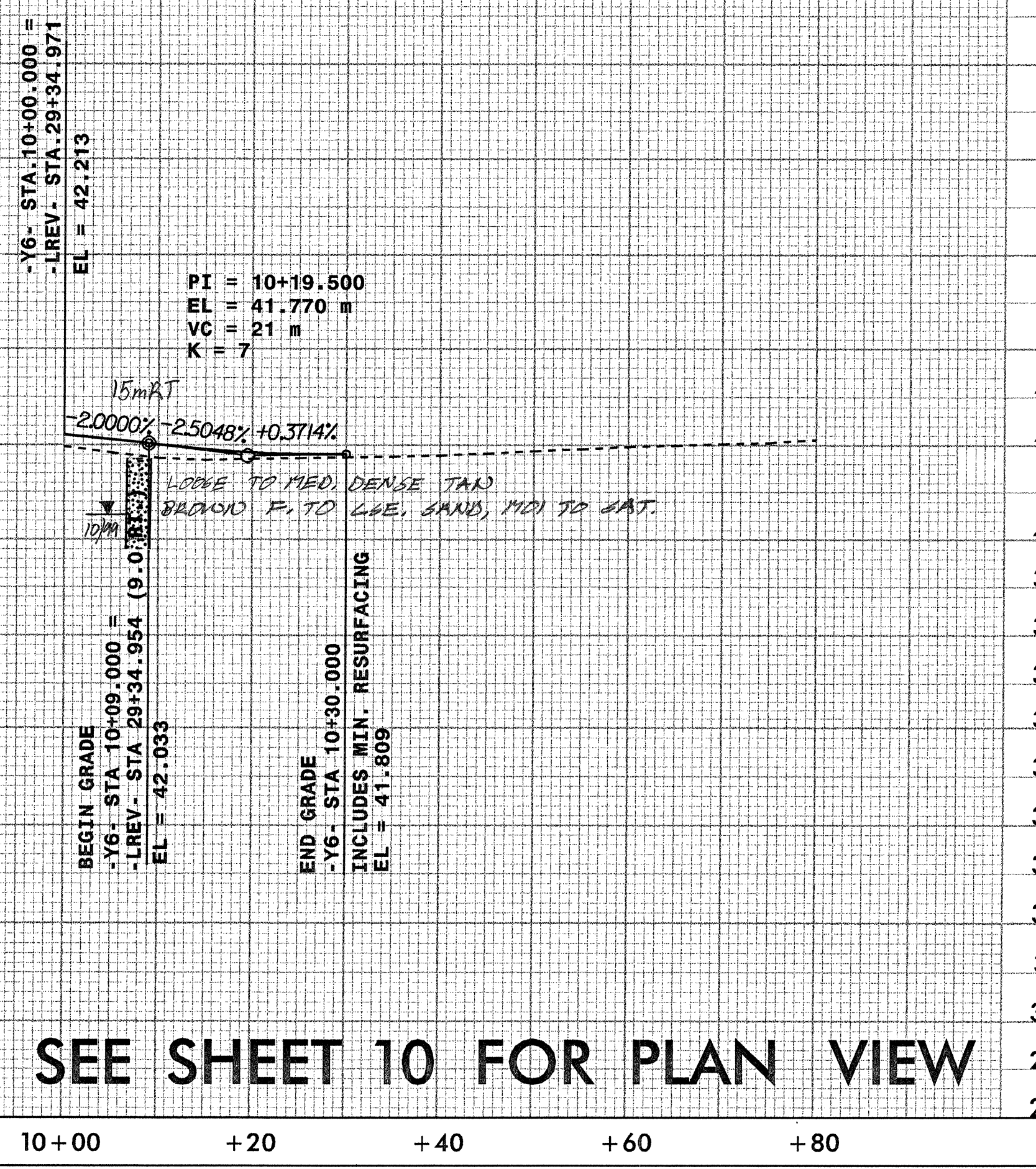

SEE SHEET 10 FOR PLAN VIEW



4915 Watson Edge Dr., Suite 295
 Raleigh, North Carolina 27606
 (919) 851-8077 Fax (919) 851-8107

15-DEC-09 09:12:44
 R:\MKD\2562D\1\prow\1-2562d.pfl