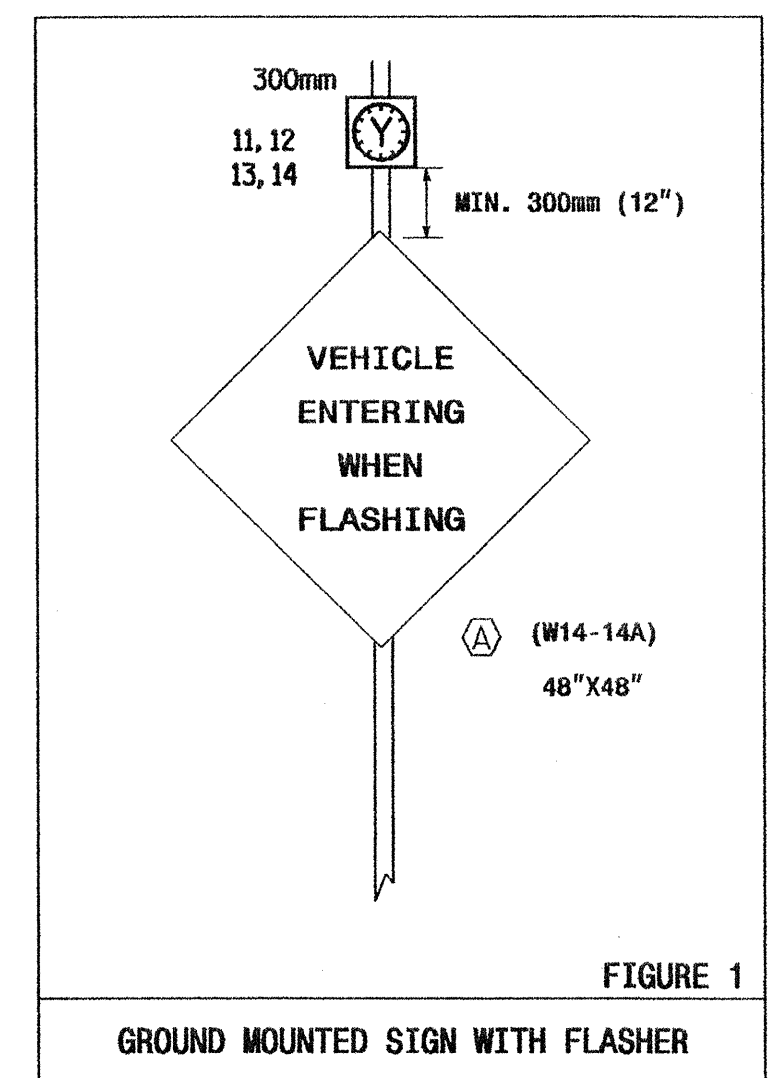
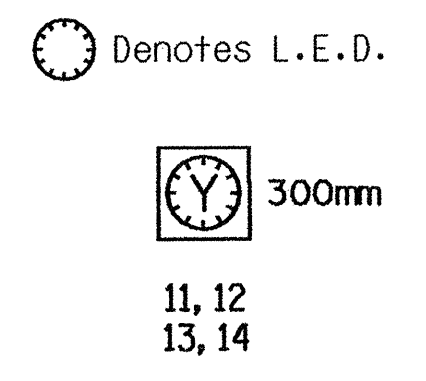

**TABLE OF OPERATION**

SIGNAL FACE	INTERVAL	
	1	2
11, 12	ON	OFF
13, 14	OFF	ON



**SIGNAL FACE I.D.**



**Acuated Flasher**

**NOTES**

1. Refer to "Roadway Standard Drawings NCDOT" dated January 2002 and "Standard Specifications for Roads and Structures" dated January 2002.
2. Pavement Markings on Cromartie Rd. and NC 41/NC87 Bus. are existing.
3. Set all detector units to presence mode.
4. Flash all beacons when actuated by loops 4A, 4B, 4C, 8A or 8B.

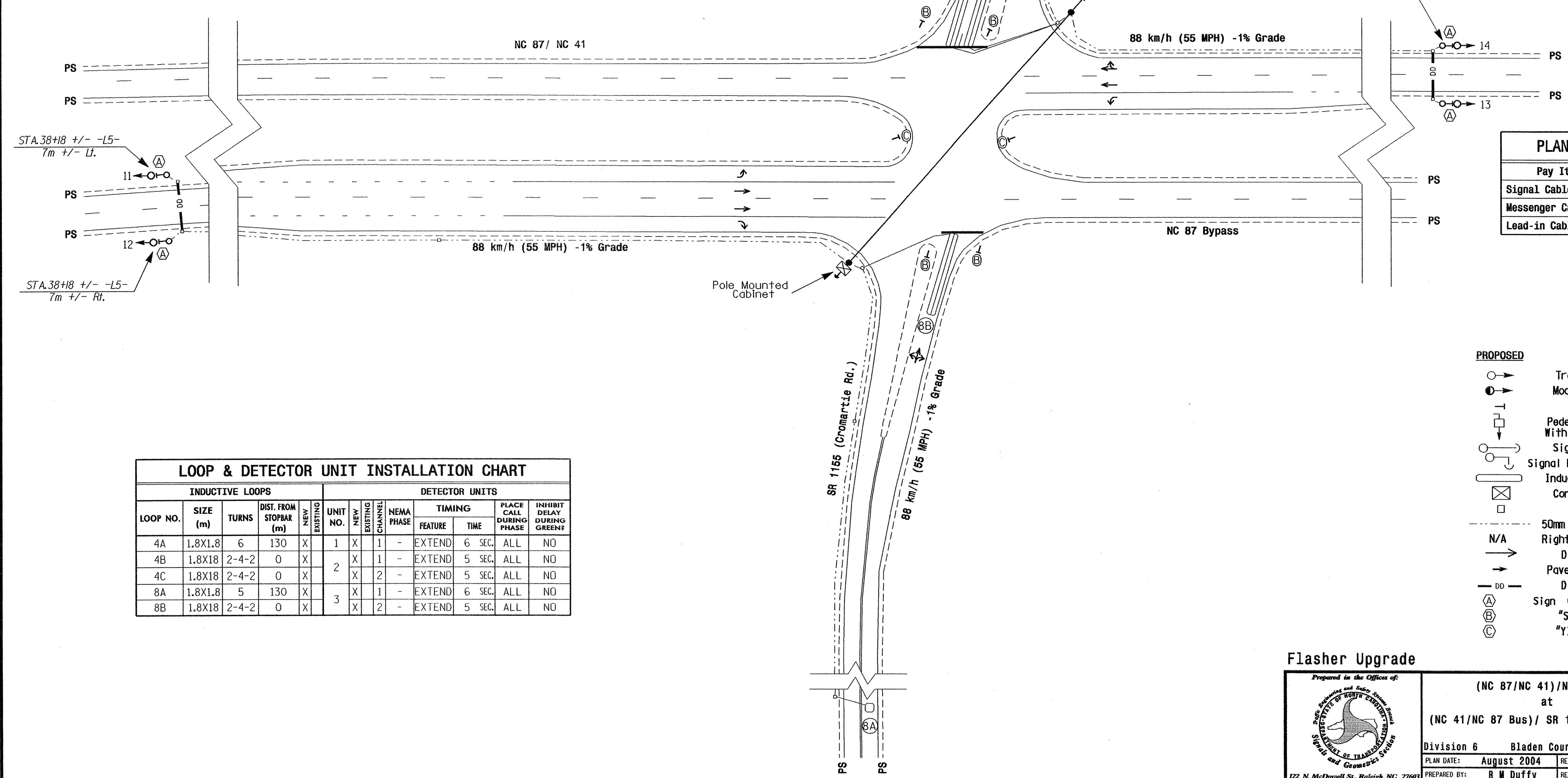

Place signs 290m from Center Line of intersection

**PLAN QUANTITIES**

Pay Item	Meters
Signal Cable	1310
Messenger Cable	0
Lead-in Cable	445

**LOOP & DETECTOR UNIT INSTALLATION CHART**

INDUCTIVE LOOPS				DETECTOR UNITS										
LOOP NO.	SIZE (m)	TURNS	DIST. FROM STOPBAR (m)	NEW	EXISTING	UNIT NO.	NEW	EXISTING	CHANNEL	NEMA PHASE	TIMING	PLACE CALL DURING PHASE	INHIBIT DELAY DURING GREEN?	
											FEATURE	TIME		
4A	1.8X1.8	6	130	X		1	X		1	-	EXTEND	6 SEC.	ALL	NO
4B	1.8X1.8	2-4-2	0	X		2	X		1	-	EXTEND	5 SEC.	ALL	NO
4C	1.8X1.8	2-4-2	0	X		2	X		2	-	EXTEND	5 SEC.	ALL	NO
8A	1.8X1.8	5	130	X		3	X		1	-	EXTEND	6 SEC.	ALL	NO
8B	1.8X1.8	2-4-2	0	X		3	X		2	-	EXTEND	5 SEC.	ALL	NO

**LEGEND**

PROPOSED	EXISTING

**Flasher Upgrade**

Prepared in the Office of:  
  
 DIVISION OF TRANSPORTATION  
 Signs and Geometric Section  
 122 N. McDowell St., Raleigh, NC 27603

(NC 87/NC 41)/NC 87 Bypass  
 at  
 (NC 41/NC 87 Bus)/ SR 1155 (Cromartie Rd.)

Division 6 Bladen County Dublin  
 PLAN DATE: August 2004 REVIEWED BY: C J Collins  
 PREPARED BY: R M Duffy REVIEWED BY:

SCALE: 1:500

REVISIONS: \_\_\_\_\_

INIT. DATE: \_\_\_\_\_

Signature: DATE: 9/2/04  
 SEAL: TIMOTHY J. WILLIAMS, ENGINEER, 24393  
 SIG. INVENTORY NO. 06-0939

01-SEP-2004 08:40  
 \\s:\p00\es-un1\m\k\groups\TIP Projects\SR-2562\Drawings\Signal\060939.slg  
 m:\c\j\collins