

~~-L- REV CURVE DATA~~
~~PI Sta 157+04.436~~
~~Δ = 0°00'32.9" (RT)~~
~~L = 1118 m~~
~~T = 0.559 m~~
~~R = 7,000,000 m~~
~~NORMAL CROWN~~

~~-L- CURVE DATA~~
~~PI Sta 156+81.474~~
~~Δ = 0°00'32.9" (RT)~~
~~L = 1118 m~~
~~T = 0.559 m~~
~~R = 7,000,000 m~~

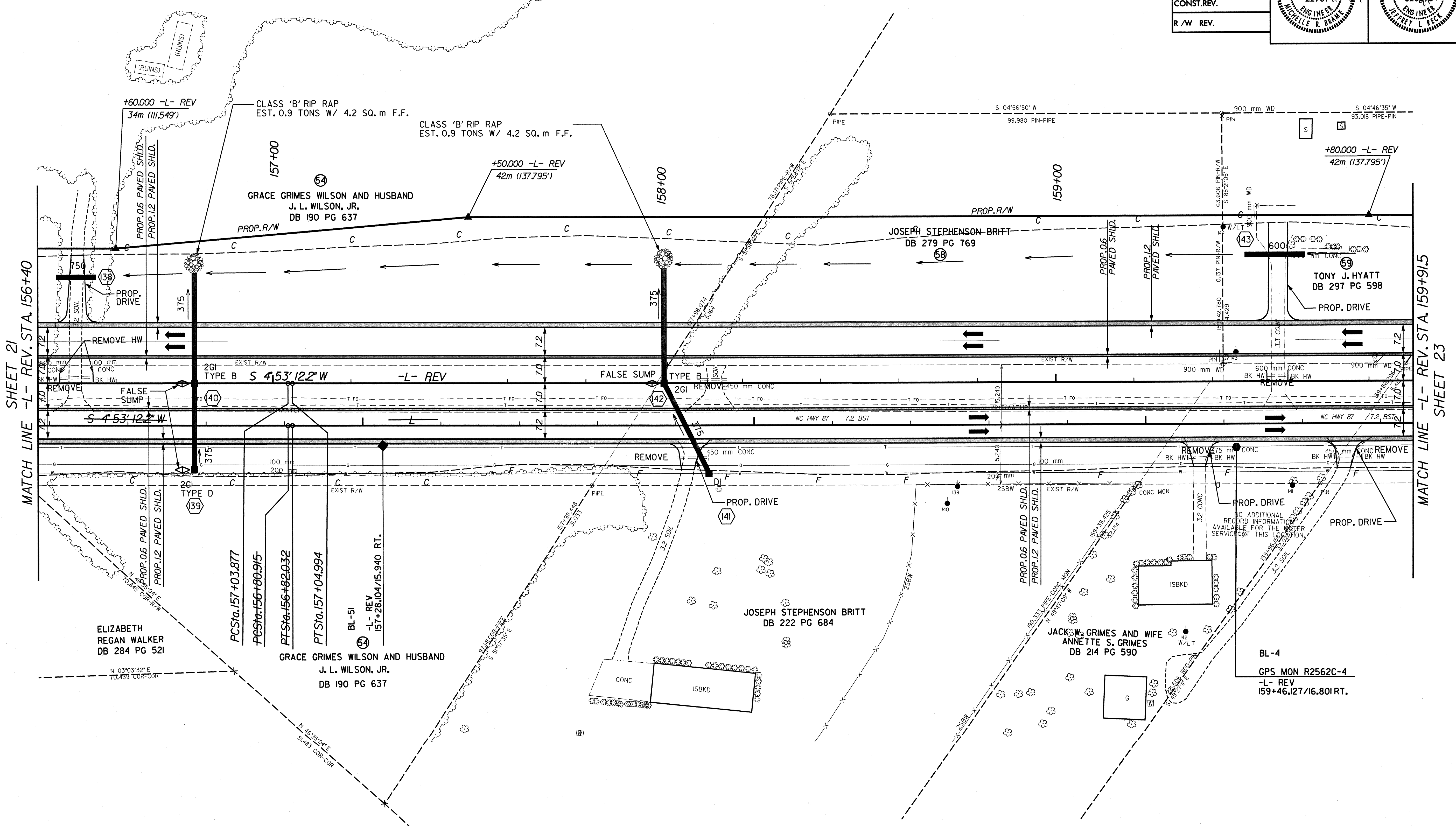

SHEET 21
MATCH LINE -L- REV. STA. 156+40

MATCH LINE -L- REV. STA. 159+91.5
SHEET 23

- DRIVEWAY NOTES:**
1. ALL PROP. DRIVEWAY RADII 3.0m UNLESS OTHERWISE SHOWN.
 2. PROP. DRIVEWAY WIDTHS AT END OF RADII SHALL BE 4.9m MIN. UNLESS OTHERWISE SHOWN. TAPER DRIVEWAY TO EXISTING DRIVEWAY WIDTH.

SEE SHEET 41 FOR -L- REV. PROFILE