

**-L- REV CURVE DATA**

Pls Sta 176+69.676	PI Sta 177+76.959	Pls Sta 178+94.304
$\Theta s = 3^{\circ} 43' 27.2''$	$\Delta = 19^{\circ} 26' 07.5''$ (LT)	$\Theta s = 5^{\circ} 43' 46.5''$
$Ls = 65.000$	$L = 169.606$	$Ls = 100.000$
$LT = 43.343$	$T = 85.626$	$LT = 66.702$
$ST = 21.675$	$R = 500.000$	$ST = 33.365$
	$SE = 0.078$	

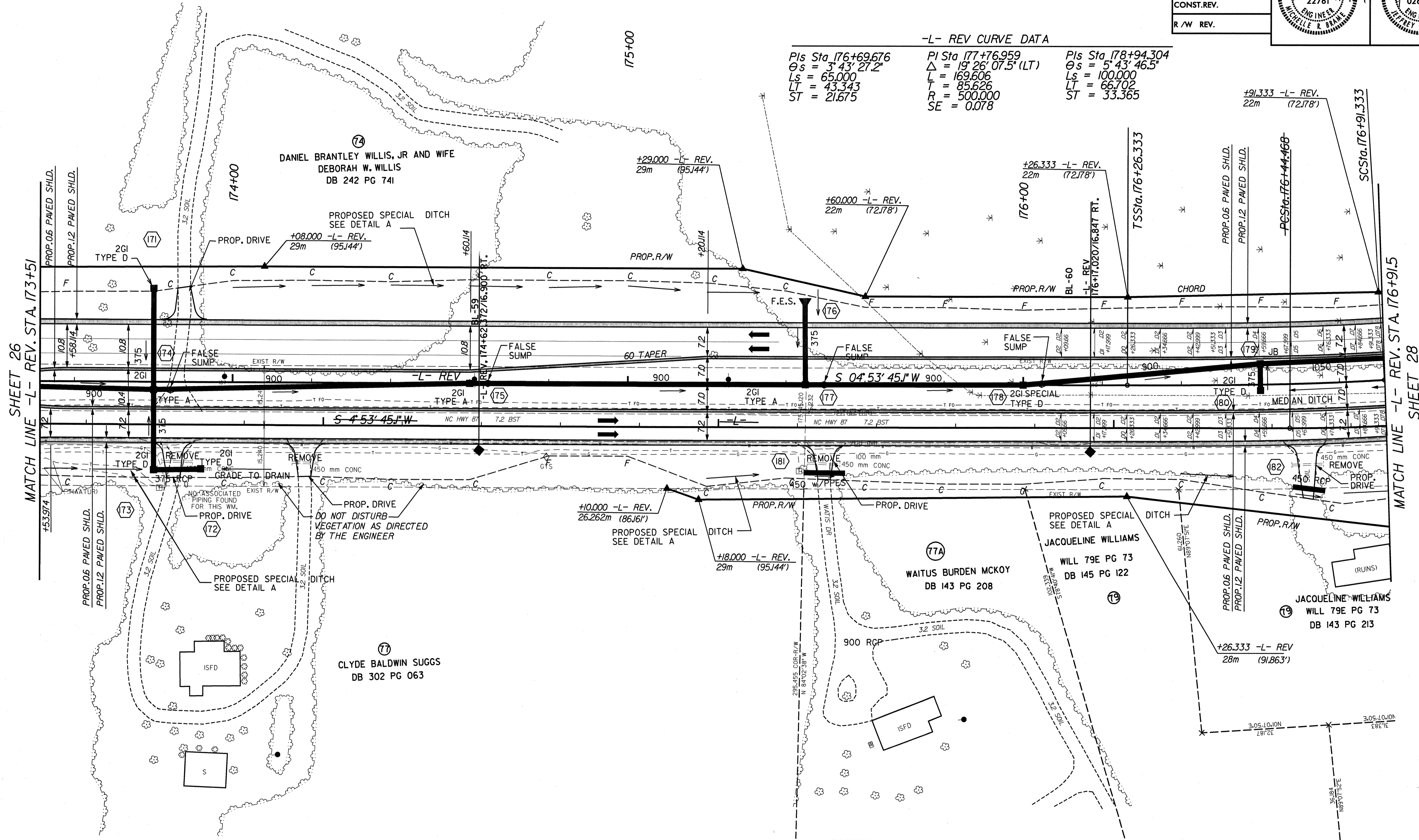

- DRIVEWAY NOTES:**
1. ALL PROP. DRIVEWAY RADII 3.0m UNLESS OTHERWISE SHOWN.
  2. PROP. DRIVEWAY WIDTHS AT END OF RADII SHALL BE 4.9m MIN. UNLESS OTHERWISE SHOWN. TAPER DRIVEWAY TO EXISTING DRIVEWAY WIDTH.

SEE SHEET 43 FOR -L- REV. PROFILE