



INCOMPLETE PLANS
DO NOT USE FOR R/W ACQUISITION
PRELIMINARY PLANS
DO NOT USE FOR CONSTRUCTION

CONST. REV.
R/W REV.

NOTE:
FOR THE 5-LANE SECTION, THE 'PROPOSED PROFILE' IS AT THE GRADE POINT OF '-L- REV.' AND THE 'EXISTING PROFILE' IS LOCATED DIRECTLY UNDER THE GRADE POINT OF '-L- REV.' FOR THE 4-LANE DIVIDED SECTION, THE 'PROPOSED PROFILE' IS AT THE GRADE POINT OF BOTH '-L- REV(LT)' AND '-L- REV(RT)', AND THE 'EXISTING PROFILE' IS DIRECTLY UNDER THE GRADE POINT ON THE SIDE WHERE 'EXISTING PAVEMENT' IS UNDER 'PROPOSED PAVEMENT'.

BMP#5: ELEV. 44.90m SURVEY BL. STA. 31+73 OFFSET 25m RIGHT RR SPIKE SET IN ROOT OF 24" PINE TREE.

SAMPLE NO.	STATION	DEPTH INTERVAL	AASHTO CLASS	L.L.	P.I.	% BY WEIGHT			% PASSING (SIEVES)			MOISTURE	ORGANIC
						G.SAND	F.SAND	SILT	CLAY	30mm	75mm		
SS-18	124+00	9 m L.L.	A-2.4(0)	15	NP	24.6	55.4	9.9	10.1	100	89	20	
SS-19	124+00	9 m L.L.	A-4(0)	32	15	22.2	44.3	4.1	28.3	100	88	20.9	
SS-20	124+00	9 m L.L.	A-2.4(0)	23	NP	30.0	48.5	2.4	10.1	100	80	3	
S-26	124+80	14 m L.L.	A-2.4(0)	13	NP	27.9	59.9	6.2	6.1	100	88	3	

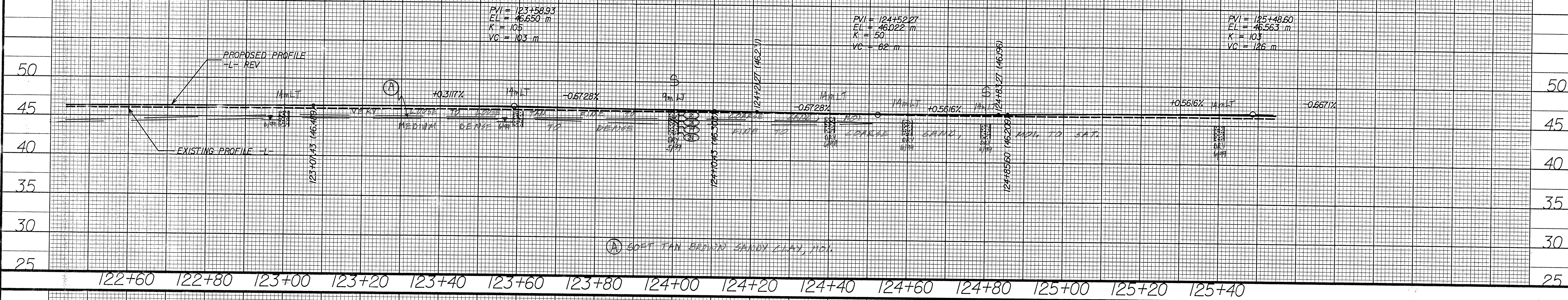

SAMPLE NO.	STATION	DEPTH INTERVAL	AASHTO CLASS	L.L.	P.I.	% BY WEIGHT			% PASSING (SIEVES)			MOISTURE	ORGANIC
						G.SAND	F.SAND	SILT	CLAY	30mm	75mm		
SS-21	126+00	12 m L.L.	A-2.4(0)	18	NP	24.4	58.0	9.3	8.1	100	89	16	
SS-22	126+00	12 m L.L.	A-4(2)	27	14	18.6	43.6	7.5	30.3	100	91	39	16.1
SS-23	126+00	12 m L.L.	A-2.4(0)	21	NP	28.1	55.6	7.3	14.1	100	86	17	
S-27	127+80	14 m L.L.	A-2.4(0)	15	NP	31.8	52.1	11.9	14.1	100	89	27	
S-28	127+80	14 m L.L.	A-6(2)	34	13	20.0	38.3	8.9	37.3	99	88	41	
S-29	127+80	14 m L.L.	A-2.4(0)	32	15	22.3	46.3	6.7	24.3	100	87	32	

