



NOTE:
FOR THE 5-LANE SECTION, THE 'PROPOSED PROFILE' IS AT THE GRADE POINT OF -L- REV. AND THE 'EXISTING PROFILE' IS LOCATED DIRECTLY UNDER THE GRADE POINT OF -L- REV. FOR THE 4-LANE DIVIDED SECTION, THE 'PROPOSED PROFILE' IS AT THE GRADE POINT OF BOTH -L- REV(LT) AND -L- REV(RT), AND THE 'EXISTING PROFILE' IS DIRECTLY UNDER THE GRADE POINT ON THE SIDE WHERE EXISTING PAVEMENT IS UNDER PROPOSED PAVEMENT.

BM#9: ELEV. 46.289m SURVEY BL STA. 56+69 OFFSET 34m LEFT RR SPIKE SET IN ROOT OF 24" PINE TREE

SAMPLE NO.	STATION	DEPTH INTERVAL	MOISTURE CLASS	L.L.	P.L.	% BY WEIGHT			% PASSING (SIEVES)			MOISTURE	ORGANIC
						ESAND	ESILT	CLAY	2.0mm	425um	75um		
SS-37	150+60	13m Lt.	0.30-0.45	A-2-4(0)	15	NP	9.30	64.7	25.9	100	99	27	
SS-38	150+80	13m Lt.	2.20-2.74	A-7-6 (21)	81	20	1.6	14.4	13.2	100	100	73	26.6
S-45	151+80	14m Lt.	0.30-0.50	A-6(0)	33	10	7.7	81.3	17.7	100	99	42	21.8
S-46	151+80	14m Lt.	0.50-0.80	A-2-4(0)	27	3	9.1	60.2	10.5	100	98	32	
S-47	151+80	14m Lt.	1.10-1.30	A-2-4(0)	24	NP	18.5	65.9	8.5	100	98	20	

PVI = 150+48.63
EL = 46.986 m
K = 104
VC = 9 m

(A) SOFT BROWN SANDY CLAY, M.D.I.
STATION 150+36.10
EL = 47.550 m
K = 102
VC = 17 m

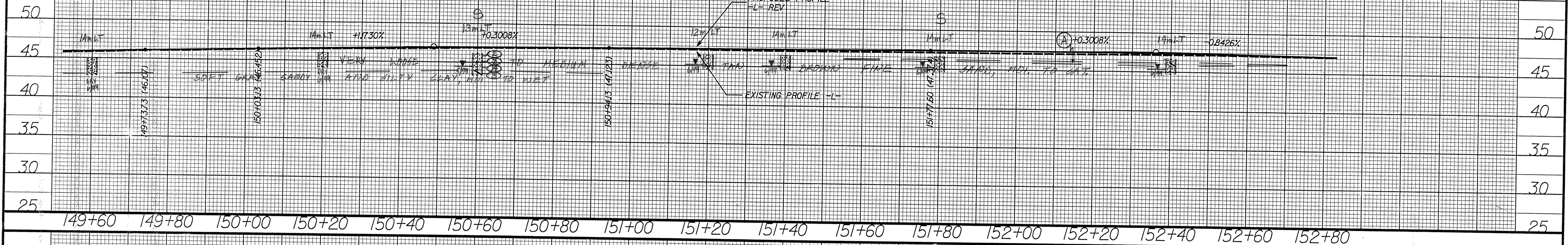

SAMPLE NO.	STATION	DEPTH INTERVAL	MOISTURE CLASS	L.L.	P.L.	% BY WEIGHT			% PASSING (SIEVES)			MOISTURE	ORGANIC
						ESAND	ESILT	CLAY	2.0mm	425um	75um		
SS-39	153+00	14m Lt.	0.30-0.45	A-2-4(0)	14	NP	17.4	65.3	3.8	100	97	18	
SS-40	153+00	14m Lt.	0.76-1.21	A-2-6 (0)	26	11	15.2	54.9	3.6	100	97	30	20.5
SS-41	153+00	14m Lt.	1.52-1.97	A-2-4 (0)	21	NP	31.5	58.2	3.4	100	97	11	
S-48	154+80	14m Lt.	0.30-0.80	A-2-4(0)	15	NP	21.8	60.0	8.4	100	97	19	
S-49	154+80	14m Lt.	0.80-1.20	A-2-4(0)	20	S	18.2	58.0	7.7	100	97	24	
S-50	154+80	14m Lt.	1.20-1.90	A-3-0 (0)	20	NP	23.6	70.5	3.8	100	98	6	
S-51	155+00	12m Lt.	0.30-0.60	A-2-4(0)	20	NP	24.6	61.4	13.9	100	99	14	45.4

STATION	OFFSET	DEPTH (m)	SR(kPa)
153+00	17m Lt.	0.2	8.86
155+00	17m Lt.	0.4	16.06
155+00	17m Lt.	0.6	26.58
155+00	17m Lt.	0.8	36.33
155+00	17m Lt.	1.0	28.36

(B) VERY LOOSE BLANK MODERATELY DRUMMED SAND, M.D.I. TO SHT. (CALCULATED)

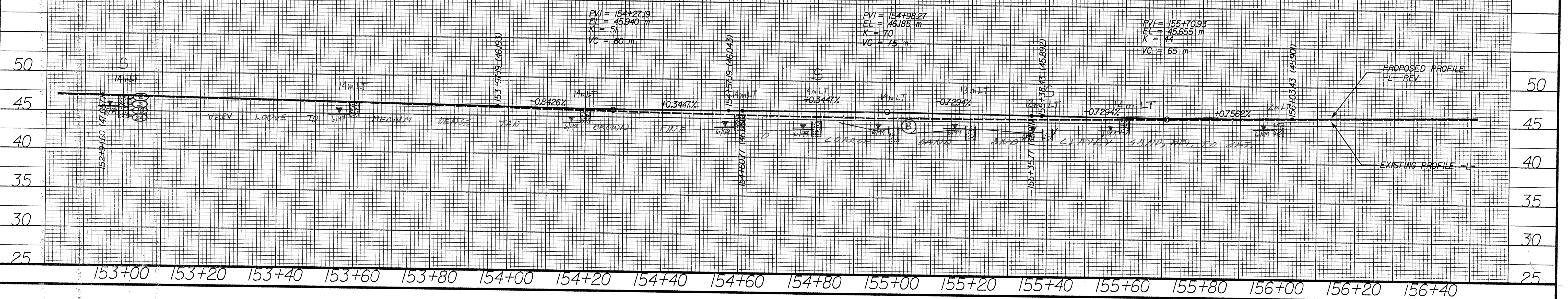

PVI = 154+27.19
EL = 45.940 m
K = 51
VC = 80 m

PVI = 154+38.27
EL = 45.885 m
K = 70
VC = 75 m

PVI = 155+70.98
EL = 45.655 m
K = 44
VC = 65 m

2025 RELEASE UNDER E.O. 14176
 FEDERAL BUREAU OF SURVEYING
 NATIONAL CENTER FOR GEODETIC SURVEILLANCE
 WASHINGTON, DC 20540-0001
 2025 RELEASE UNDER E.O. 14176