

CONST. REV.
 R/W REV.

INCOMPLETE PLANS
 DO NOT USE FOR R/W ACQUISITION
 PRELIMINARY PLANS
 DO NOT USE FOR CONSTRUCTION

SAMPLE NO.	STATION	DEPTH	AASHTO CLASS	L.L.	P.L.	% BY WEIGHT			% PASSING (SIEVES)			% MOISTURE	% ORGANIC
						ESAND	FSAND	SILT	CLAY	20mm	425um		
SS-50	170+20	14m LL	A-3(0)	16	NP	28.4	43.1	2.4	6.1	100	94	9	
SS-51	171+80	14m LL	A-3(0)	17	NP	29.1	42.6	4.2	4.0	100	93	9	
SS-52	173+00	14m LL	A-2-4(0)	16	NP	23.0	42.0	5.9	9.1	100	95	16	
SS-53	173+00	14m LL	A-2-4(0)	27	7	20.2	46.7	6.9	26.3	100	98	33	
SS-53	173+00	14m LL	A-2-4(0)	18	NP	26.7	39.6	5.7	8.1	100	97	14	

NOTE:
 FOR THE 5-LANE SECTION, THE 'PROPOSED PROFILE' IS AT THE GRADE POINT OF 'L- REV.' AND THE 'EXISTING PROFILE' IS LOCATED DIRECTLY UNDER THE GRADE POINT OF '-L- REV.' FOR THE 4-LANE DIVIDED SECTION, THE 'PROPOSED PROFILE' IS AT THE GRADE POINT OF BOTH '-L- REV(L)' AND '-L- REV(R)', AND THE 'EXISTING PROFILE' IS DIRECTLY UNDER THE GRADE POINT ON THE SIDE WHERE EXISTING PAVEMENT IS UNDER PROPOSED PAVEMENT.

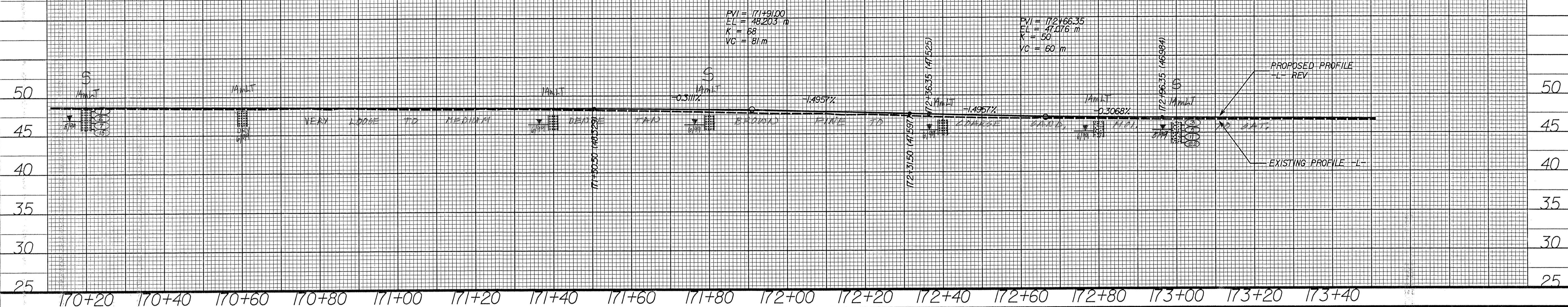

BM#13: ELEV. 46.13m SURVEY BL STA. 80+28 OFFSET 52m LEFT RR SPIKE SET IN ROOT OF 26' POST OAK TREE

SAMPLE NO.	STATION	DEPTH	AASHTO CLASS	L.L.	P.L.	% BY WEIGHT			% PASSING (SIEVES)			% MOISTURE	% ORGANIC
						ESAND	FSAND	SILT	CLAY	20mm	425um		
SS-54	174+00	9m LL	A-3(0)	16	NP	26.5	35.1	4.2	4.0	100	94	9	
SS-54	175+40	9m LL	A-3(0)	24	NP	37.6	54.0	5.4	3.0	100	89	9	
SS-55	175+40	9m LL	A-3(0)	20	NP	35.3	60.0	2.7	2.0	100	90	5	

