

**NOTE:**  
UTILIZE TEMPORARY ROCK SEDIMENT DAM TYPE - B AND/OR SPECIAL STILLING BASIN AS STILLING BASIN WHERE APPLICABLE.

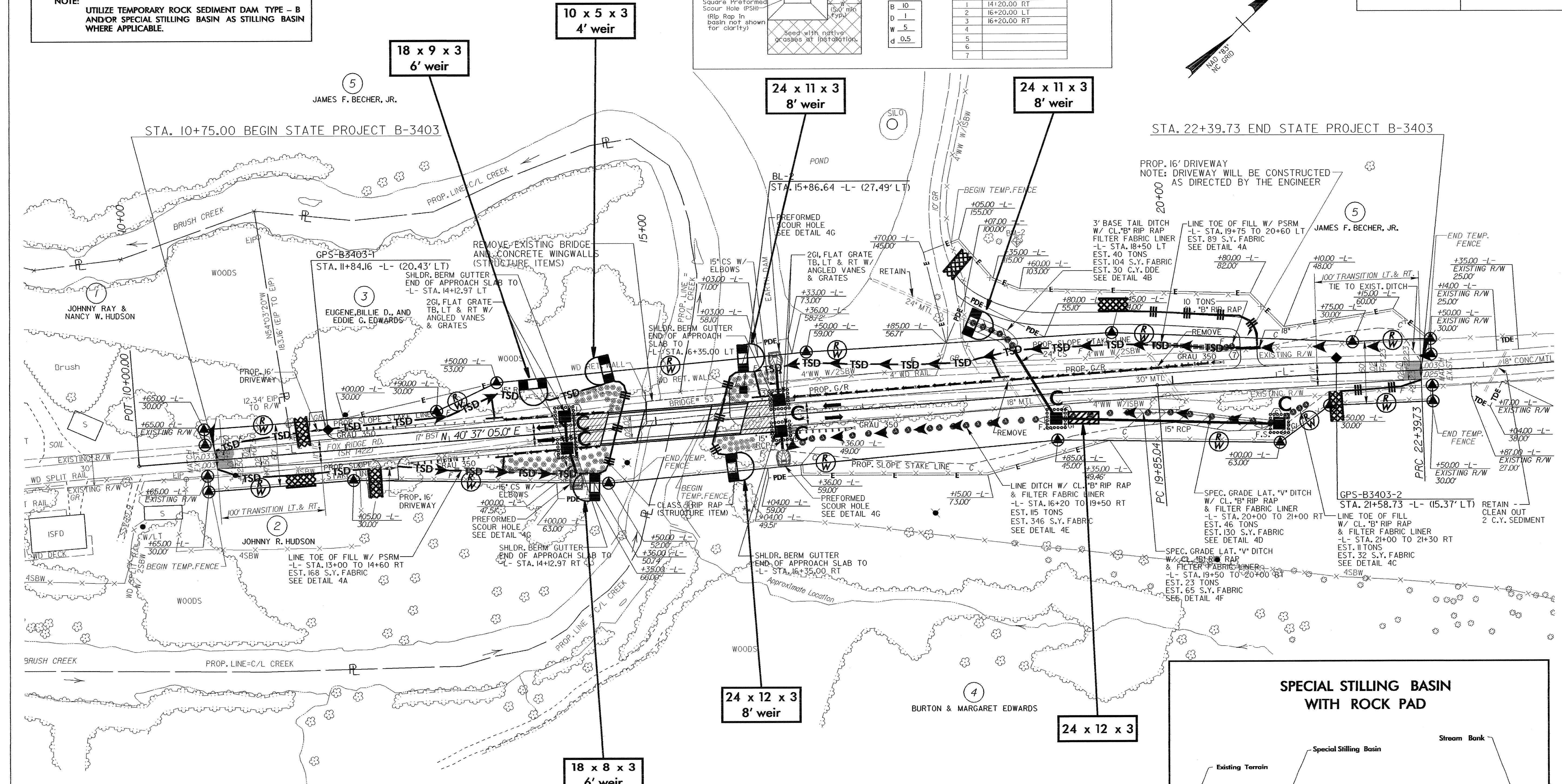

**DATUM DESCRIPTION**  
THE LOCALIZED COORDINATE SYSTEM DEVELOPED FOR THIS PROJECT IS BASED ON THE STATE PLANE COORDINATES ESTABLISHED BY NCOS FOR MONUMENT "SALMON" WITH NAD 83 STATE PLANE GRID COORDINATES OF NORTHING: 1025541.023(f1) EASTING: 1408379.739(f1) THE AVERAGE COMBINED GRID FACTOR USED ON THIS PROJECT (GROUND TO GRID) IS: 0.999997490 THE N.C. LAMBERT GRID BEARING LOCALIZED HORIZONTAL GROUND DISTANCE FROM "SALMON" TO -L- STATION 10+00.00 IS S 0° 12' 51.8" E 13250.95 ft ALL LINEAR DIMENSIONS ARE LOCALIZED HORIZONTAL DISTANCES VERTICAL DATUM USED IS NGVD 29

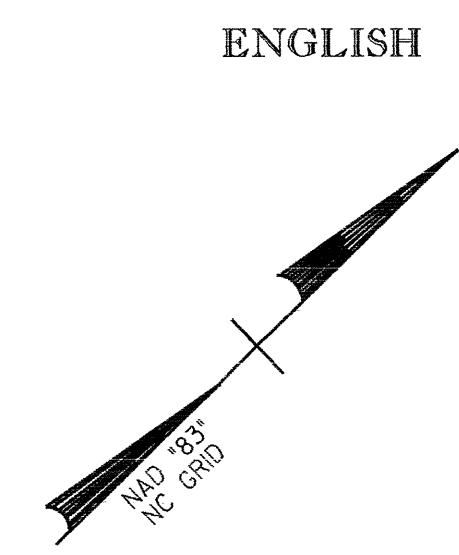
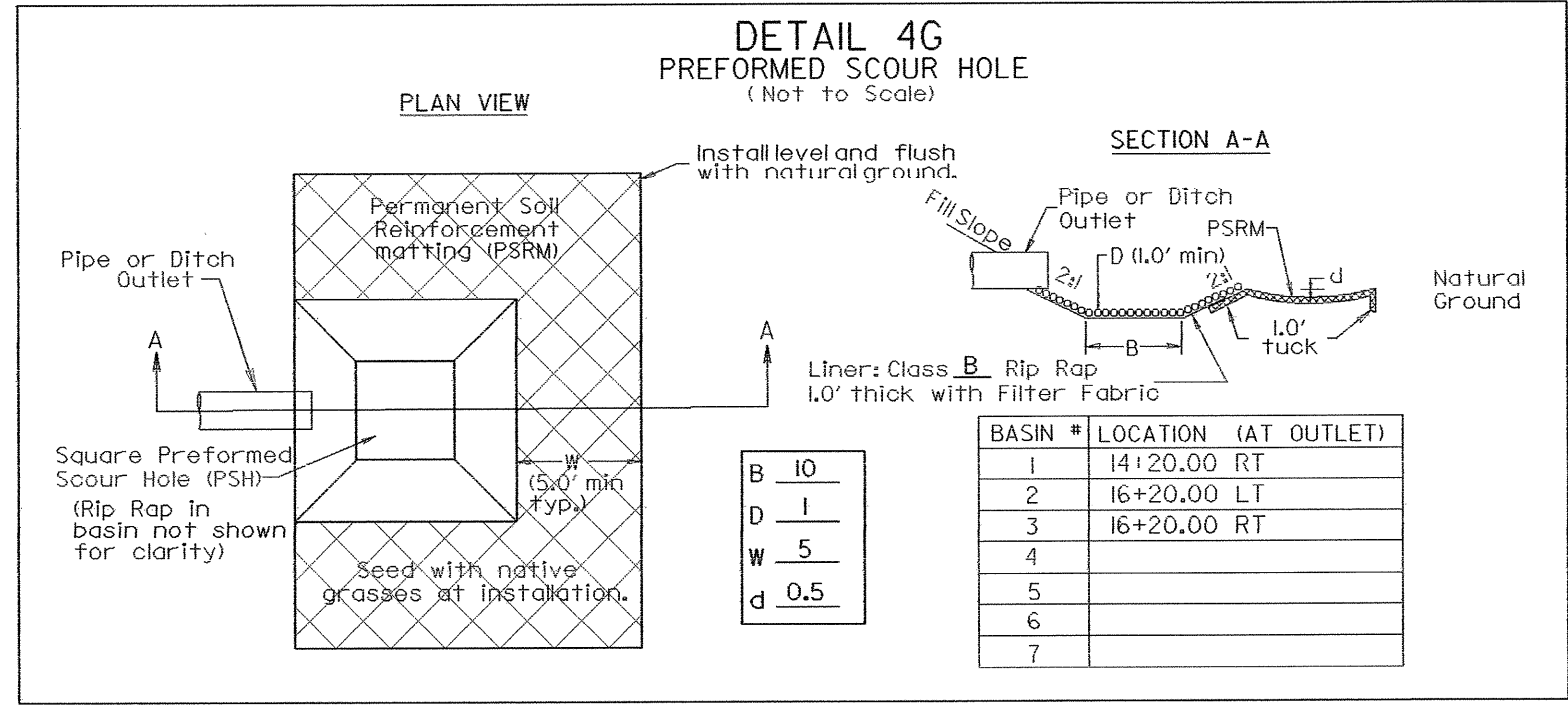