

5/14/99

BM# 1
12" SPIKE IN BASE OF 20" MAPLE TREE
-BL- STA 5+55.31 101.59' LT
WEST OF -SBL- 1-77 STA. 11+48.31 43.97' RT
ELEV = 951.50'

PROJECT REFERENCE NO. I-4025A	SHEET NO. 7
ROADWAY DESIGN ENGINEER WARREN F. LAMB	HYDRAULICS ENGINEER W. HERBERT TURNER
SEAL 13747	SEAL 21162
6-24-04	6-24-04

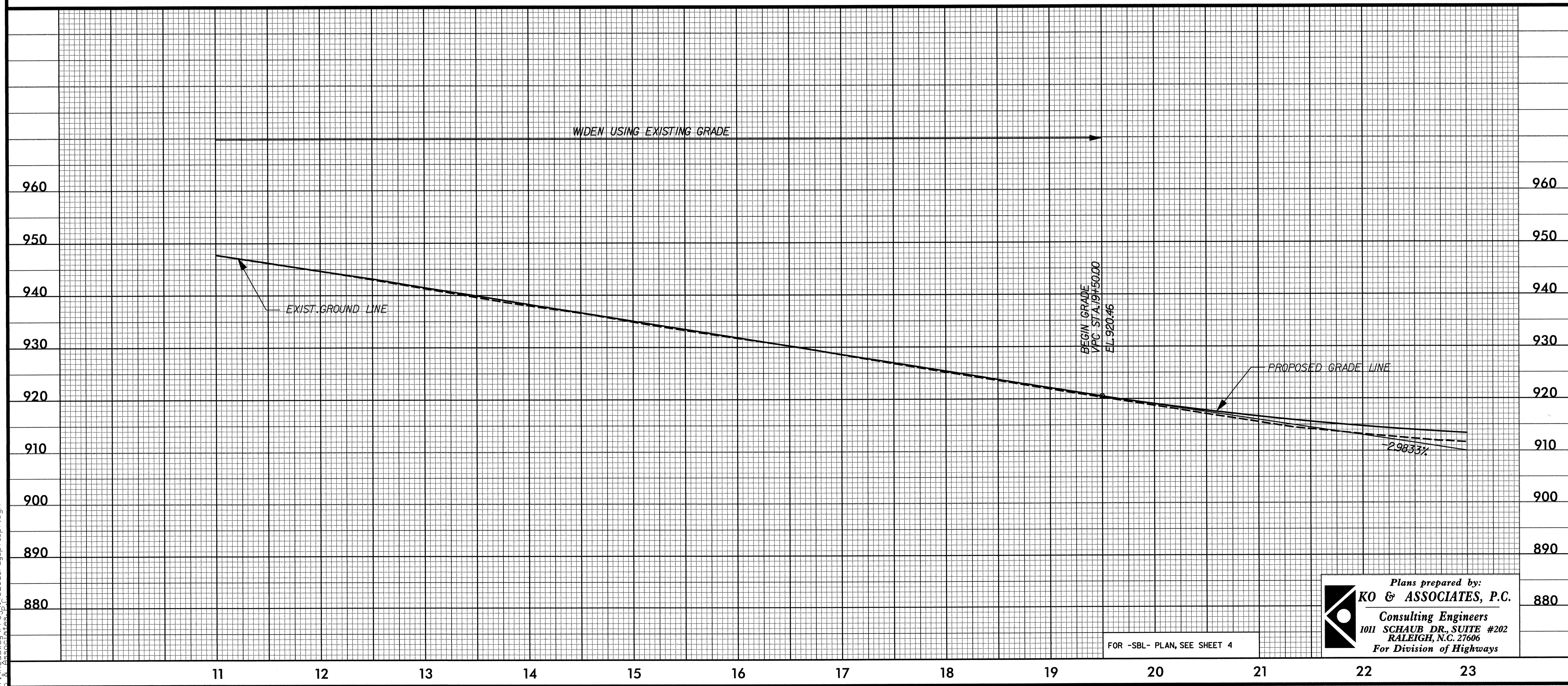
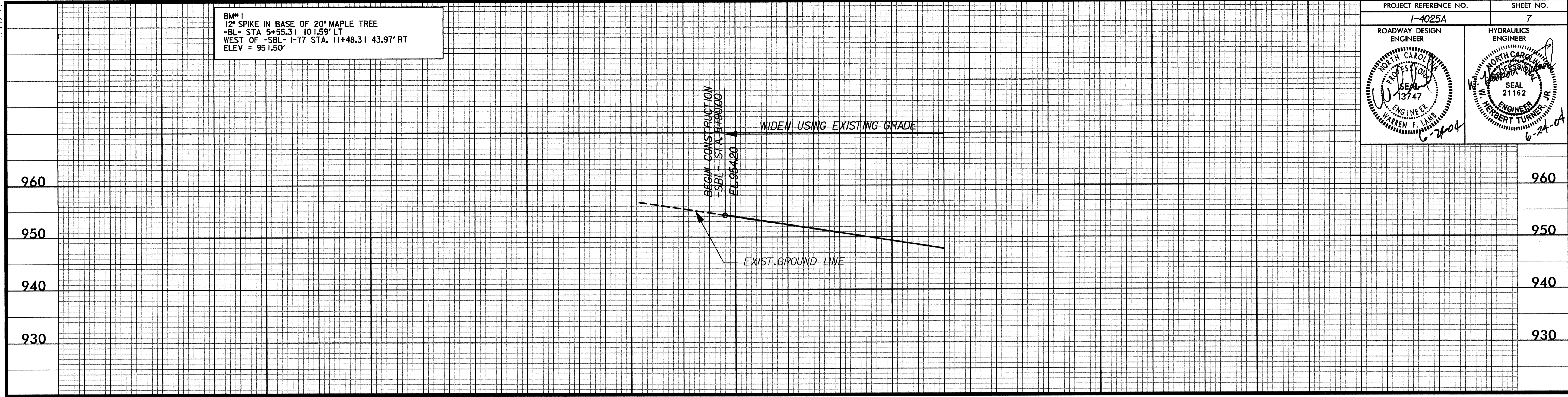

06/18/2004
r:\Roadway\Proj\4025a_rdy_pfl.p7.dgn

FOR -SBL- PLAN, SEE SHEET 4

Plans prepared by:
KO & ASSOCIATES, P.C.
Consulting Engineers
1011 SCHAUB DR., SUITE #202
RALEIGH, N.C. 27606
For Division of Highways

880