

-SBL-

PI Sta	PI Sta	PI Sta
36+49.47	41+73.92	47+66.79
$\Delta = 1' 44' 53.3''$ (RT)	$\Delta = 1' 44' 53.3''$ (LT)	$\Delta = 2' 54' 55.4''$ (LT)
$D = 0' 20' 00.0''$	$D = 0' 20' 00.0''$	$D = 0' 30' 05.4''$
$L = 524.44'$	$L = 524.44'$	$L = 581.35'$
$T = 262.24'$	$T = 262.24'$	$T = 290.74'$
$R = 17,188.73'$	$R = 17,188.73'$	$R = 11,425.16'$
SE = NC	SE = NC	SE = EXISTING
DS = 70 MPH	DS = 70 MPH	DS = 70 MPH

**LEGEND**

	PAVED SHOULDER
	PAVEMENT REMOVAL

-MATCHLINE- STA. 36 + 50 SEE SHEET NO. 5

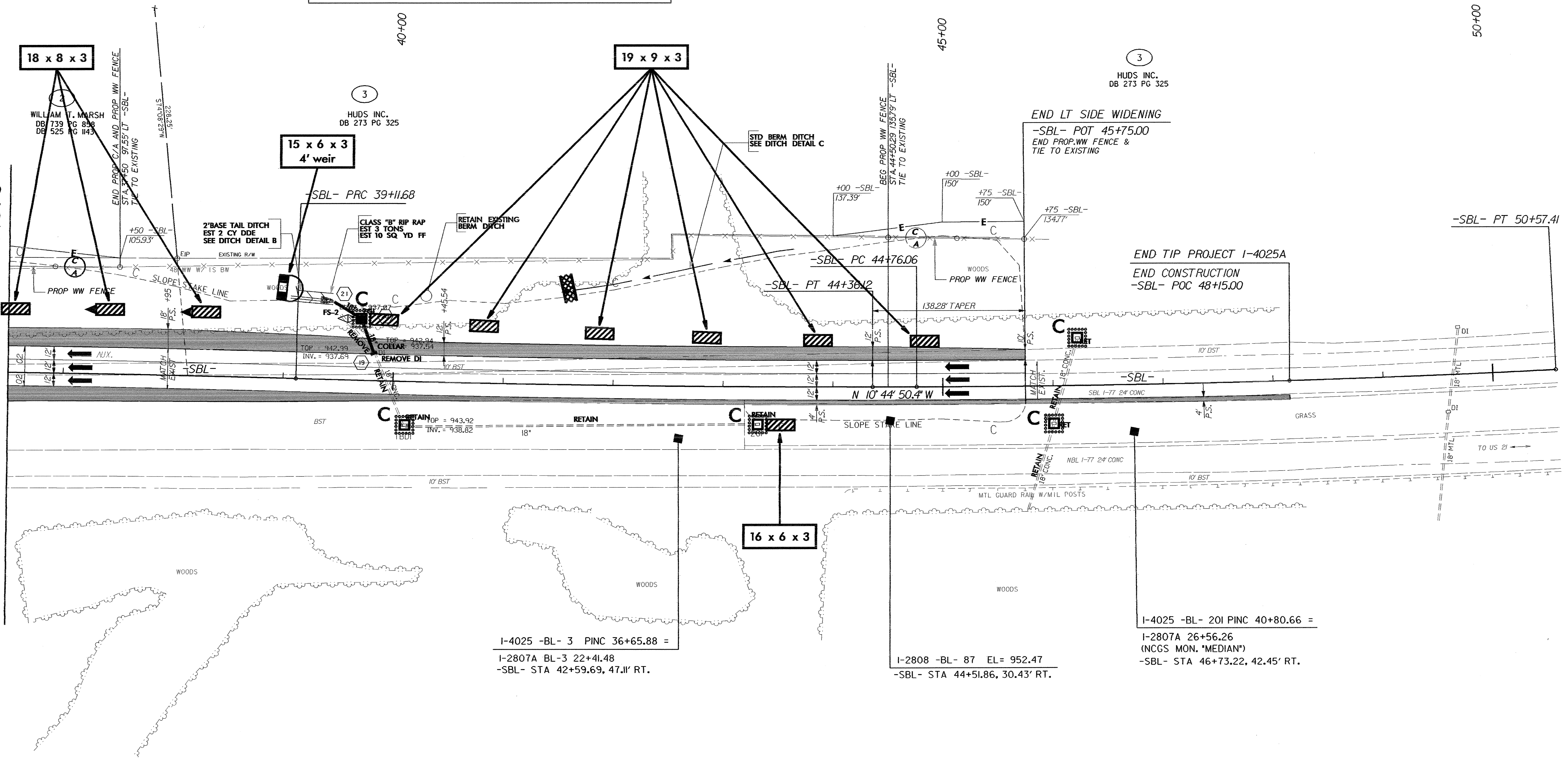

I-4025 -BL- 3 PINC 36+65.88 =  
I-2807A BL-3 22+41.48  
-SBL- STA 42+59.69, 47.11' RT.

I-2808 -BL- 87 EL = 952.47  
-SBL- STA 44+51.86, 30.43' RT.

I-4025 -BL- 20I PINC 40+80.66 =  
I-2807A 26+56.26  
(NCGS MON. 'MEDIAN')  
-SBL- STA 46+73.22, 42.45' RT.