

END ELEVATION NORMAL TO SKEW
 (LOOKING DOWNSTREAM)

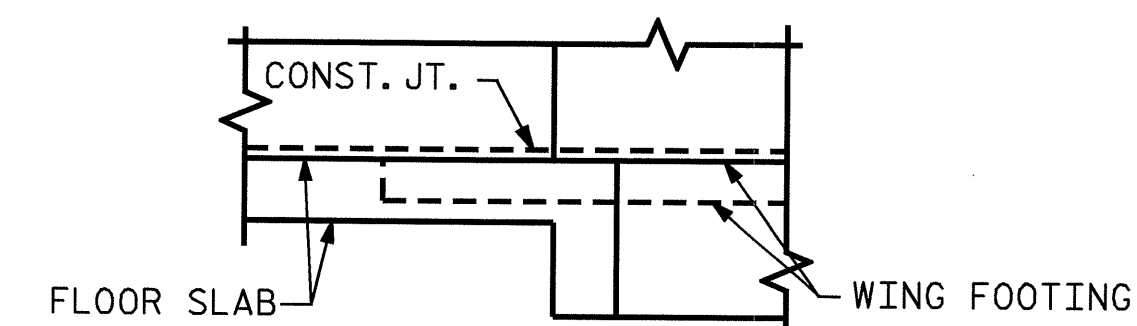

DETAIL
CONNECTION OF WING FOOTING
AND FLOOR SLAB WHEN SLAB
IS THICKER THAN FOOTING

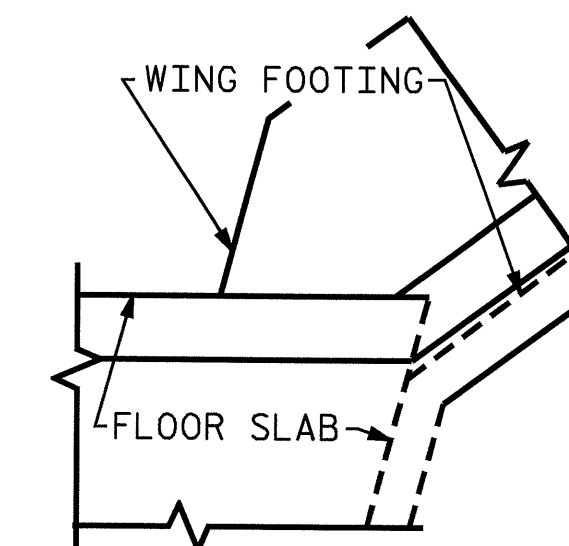
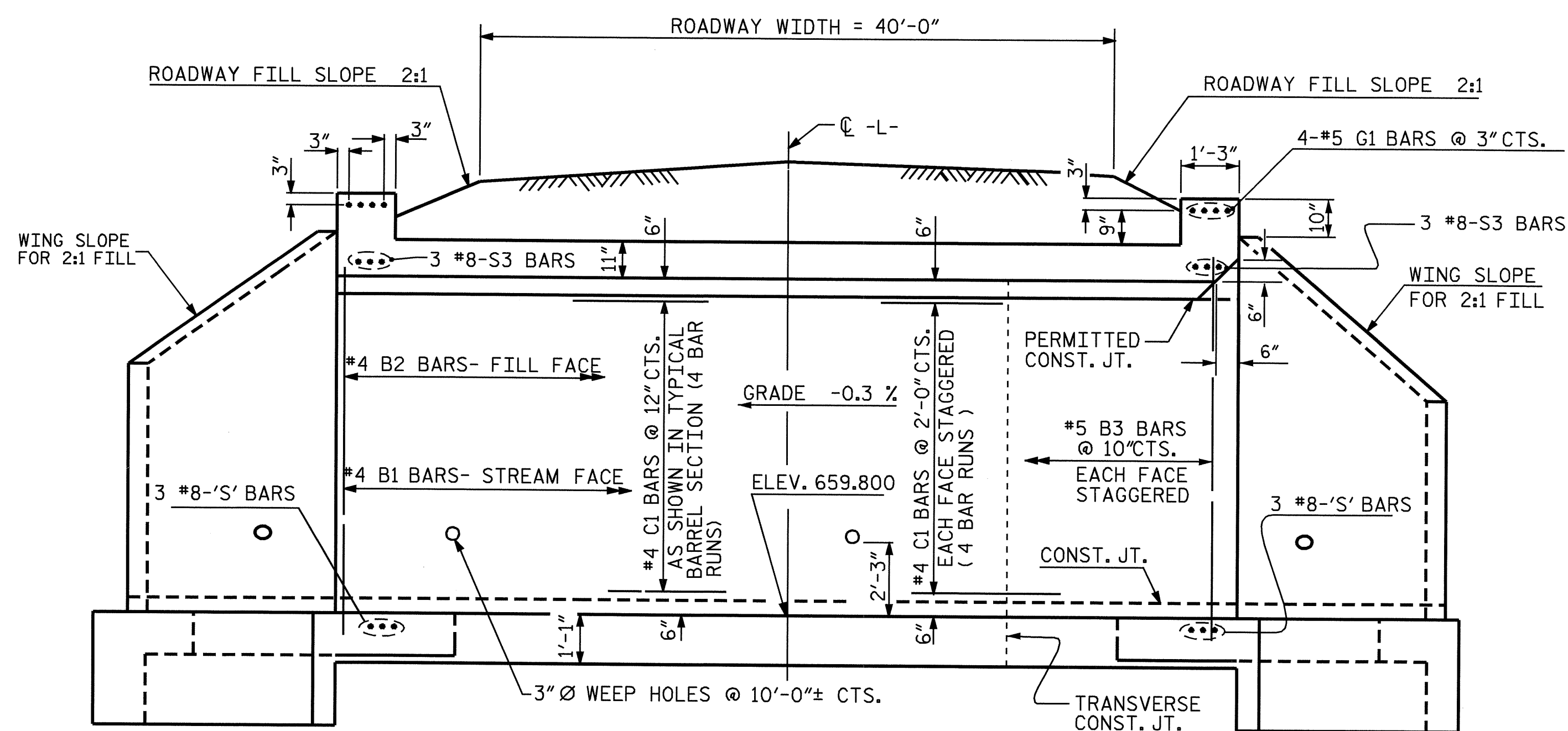

EXTERIOR WALL **INTERIOR WALL**
CULVERT SECTION NORMAL TO ROADWAY

PROJECT NO. B-3695
ROCKINGHAM COUNTY
 STATION: 20+78.00 -L-
 SHEET 2 OF 7

STATE OF NORTH CAROLINA
 DEPARTMENT OF TRANSPORTATION
 RALEIGH
 TRIPLE 8 FT. X 8 FT.
 CONCRETE BOX CULVERT
 70° SKEW

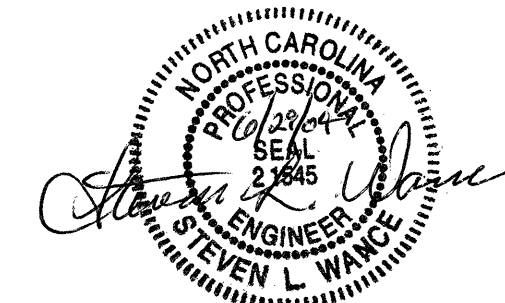

REVISED 11-19-99 BY M.M. CHECKED BY R.W.W.
 REVISED 8-28-92 BY E.L.R. / BY G.R.P.
 REDRAWN 10-16-89 BY R.W.W. / BY A.R.B.

ASSEMBLED BY : <u>SWANc@PE</u>	DATE : <u>02 /04</u>	SPECIAL
CHECKED BY : <u>N.Q. TRAN</u>	DATE : <u>02 /04</u>	
DRAWN BY : <u>R.F. HOLMES</u>	DATE : <u>NOV. 1971</u>	STANDARD
CHECKED BY : <u>J.A. JOHNSON</u>	DATE : <u>NOV. 1971</u>	

REVISIONS						SHEET NO.
NO.	BY:	DATE:	NO.	BY:	DATE:	C-2
1			3			TOTAL SHEETS
2			4			7