

9/09/99

PROJECT: 6.469002T

R-0513BA

See Sheet 1-A For Index of Sheets

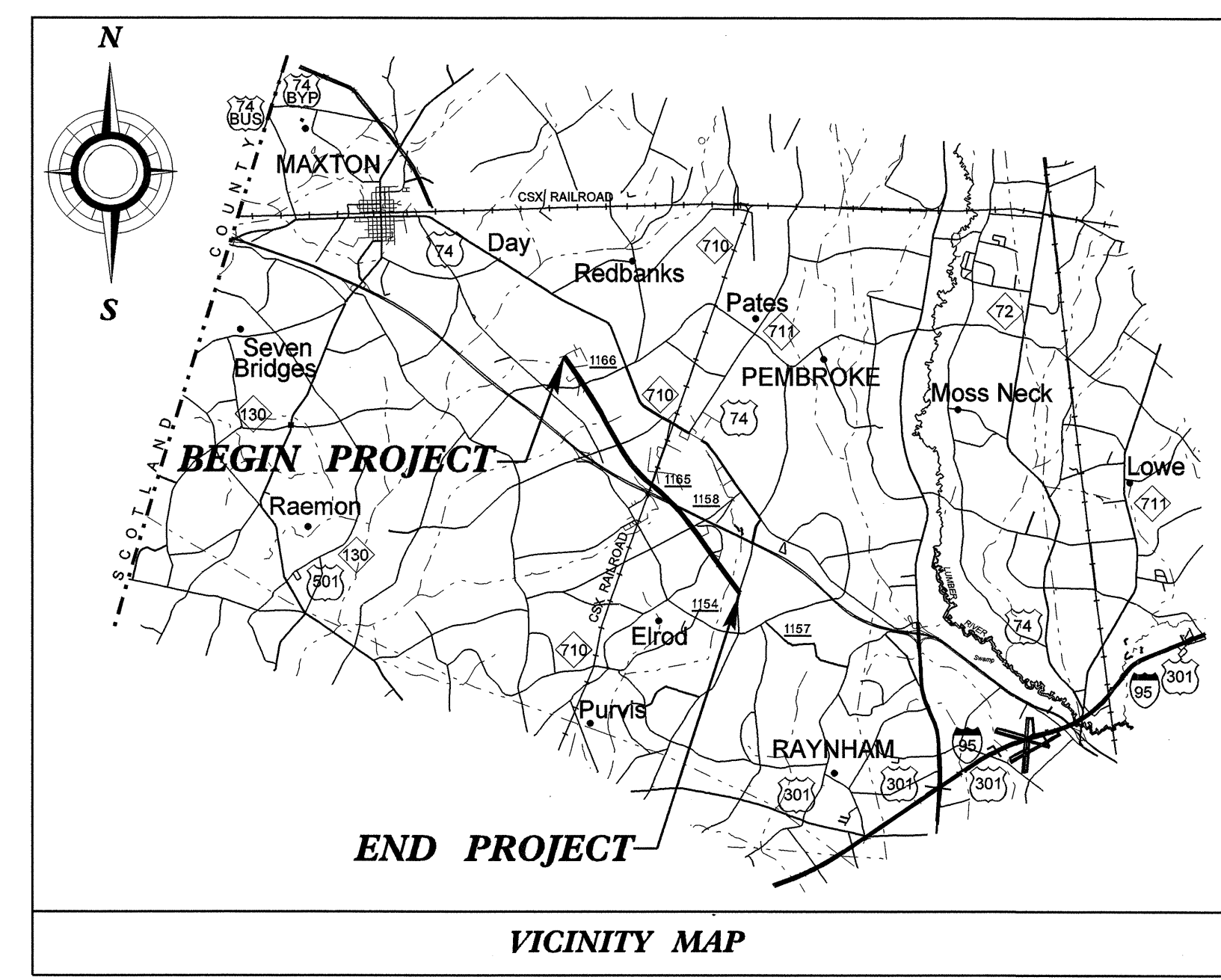

STATE OF NORTH CAROLINA
DIVISION OF HIGHWAYS

ROBESON COUNTY

LOCATION: US 74 FROM EAST OF SR 1166 TO WEST OF SR 1157

TYPE OF WORK: GRADING, PAVING, DRAINAGE, STRUCTURES, GUARDRAIL & SIGNING

STATE	STATE PROJECT REFERENCE NO.	SHEET NO.	TOTAL SHEETS
N.C.	R-0513BA	2A	47
STATE PROJ. NO.	F.A. PROJ. NO.	DESCRIPTION	
6.469002T		PE	
ALL DIMENSIONS IN THESE PLANS ARE IN METERS			

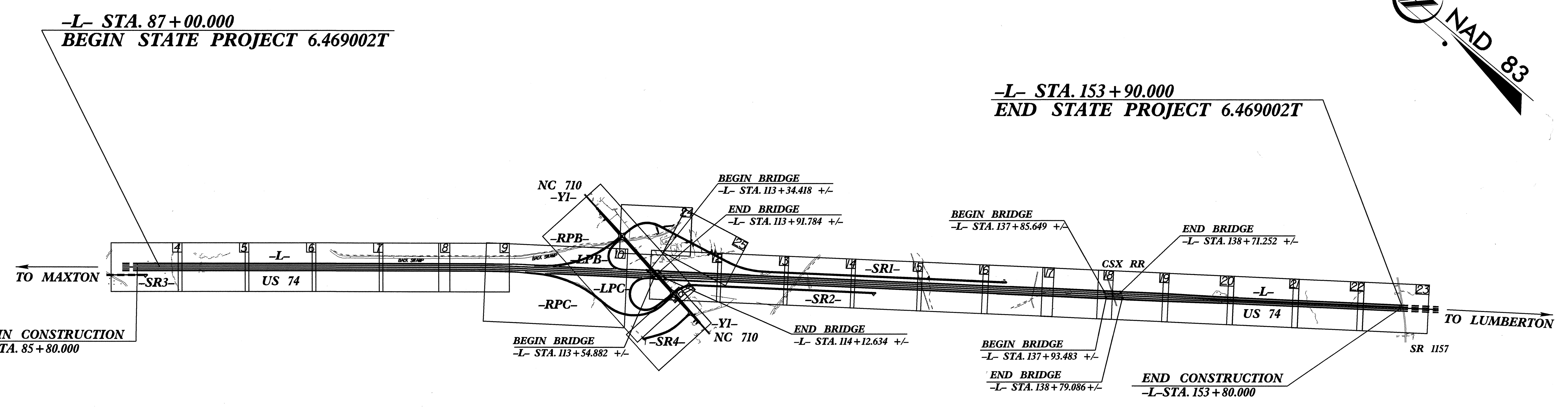

CLEARING ON THIS PROJECT SHALL BE PERFORMED TO THE LIMITS ESTABLISHED BY METHOD

PRELIMINARY PLANS
DO NOT USE FOR CONSTRUCTION
INCOMPLETE PLANS
DO NOT USE FOR R/W ACQUISITION

<p>GRAPHIC SCALES</p> <p>5 0 10 PLANS</p> <p>5 0 10 PROFILE (HORIZONTAL)</p> <p>1 0 2 PROFILE (VERTICAL)</p>	<p>DESIGN DATA</p> <p>ADT 2003 = 13,700</p> <p>ADT 2023 = 28,300</p> <p>DHV = 10 %</p> <p>D = 55 %</p> <p>T = 32 % *</p> <p>V = 110 km/h</p> <p>* TTST 22% DUAL 10%</p>	<p>PROJECT LENGTH</p> <p>LENGTH ROADWAY F.A. PROJECT = 6.547KM</p> <p>* LENGTH STRUCTURE F.A. PROJECT = 0.143KM</p> <p>TOTAL LENGTH STATE PROJECT 6.469002T = 6.690KM</p> <p>* LENGTHS BASED ON EBL BRIDGES</p>	<p>Prepared In the Office of:</p> <p>DIVISION OF HIGHWAYS</p> <p>1000 Birch Ridge Dr., Raleigh, NC 27610</p>		<p>HYDRAULICS ENGINEER</p> <p>SIGNATURE: _____ P.E.</p>	<p>DIVISION OF HIGHWAYS STATE OF NORTH CAROLINA</p> <p>STATE DESIGN ENGINEER</p> <p>DEPARTMENT OF TRANSPORTATION FEDERAL HIGHWAY ADMINISTRATION</p> <p>APPROVED DIVISION ADMINISTRATOR</p>
			<p>1995 STANDARD SPECIFICATIONS</p> <p>RIGHT OF WAY DATE: * DECEMBER 21, 2001</p> <p>LETTING DATE: * DECEMBER 16, 2003</p> <p>* PRODUCTION DATES</p>	<p>SUE R. FLOWERS PROJECT ENGINEER</p> <p>STEPHEN E. ROBERTS, PE PROJECT DESIGN ENGINEER</p>	<p>ROADWAY DESIGN ENGINEER</p> <p>SIGNATURE: _____ P.E.</p>	<p>DATE</p>

28-DEC-2000 13:33
R:\R0513BA\proj\vr-0513ba.tsh