

PLAN

BAR TYPES

ALL BAR DIMENSIONS ARE OUT TO OUT.

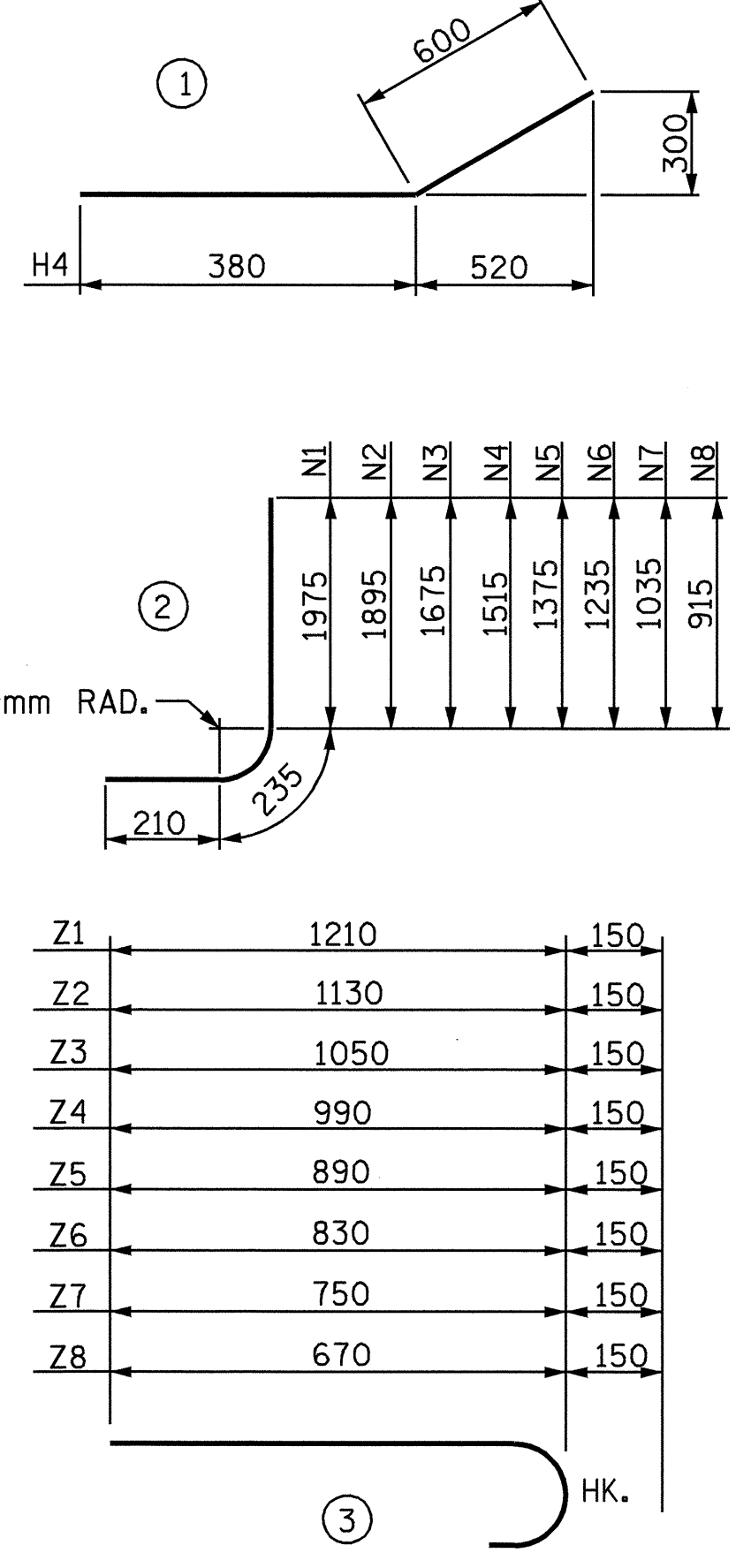

BILL OF MATERIAL

BAR NO.	SIZE	TYPE	LENGTH	WEIGHT
H1	4	13 STR	4800	19
H2	8	13 STR	4720	38
H3	4	13 STR	3460	14
H4	4	13 1	1780	7
H5	20	13 STR	980	19
N1	4	13 2	2420	10
N2	4	13 2	2340	9
N3	4	13 2	2120	8
N4	4	13 2	1960	8
N5	4	13 2	1820	7
N6	4	13 2	1680	7
N7	4	13 2	1480	6
N8	4	13 2	1360	5
T1	6	16 STR	9240	43
V1	4	13 STR	1740	7
V2	4	13 STR	1600	6
V3	4	13 STR	1420	6
V4	4	13 STR	1260	5
V5	4	13 STR	1120	4
V6	4	13 STR	980	4
V7	4	13 STR	780	3
V8	4	13 STR	660	3
Z1	4	13 3	1360	5
Z2	4	13 3	1280	5
Z3	4	13 3	1200	5
Z4	4	13 3	1140	5
Z5	4	13 3	1040	4
Z6	4	13 3	980	4
Z7	4	13 3	900	4
Z8	4	13 3	820	3

REINFORCING STEEL IN 2 WINGS 273 kg
 CLASS A CONCRETE
 2 WINGS 12.4 m³
 2 HEADWALLS 1.2 m³
 1 END CURTAIN WALLS 0.5 m³
 TOTAL 14.1 m³

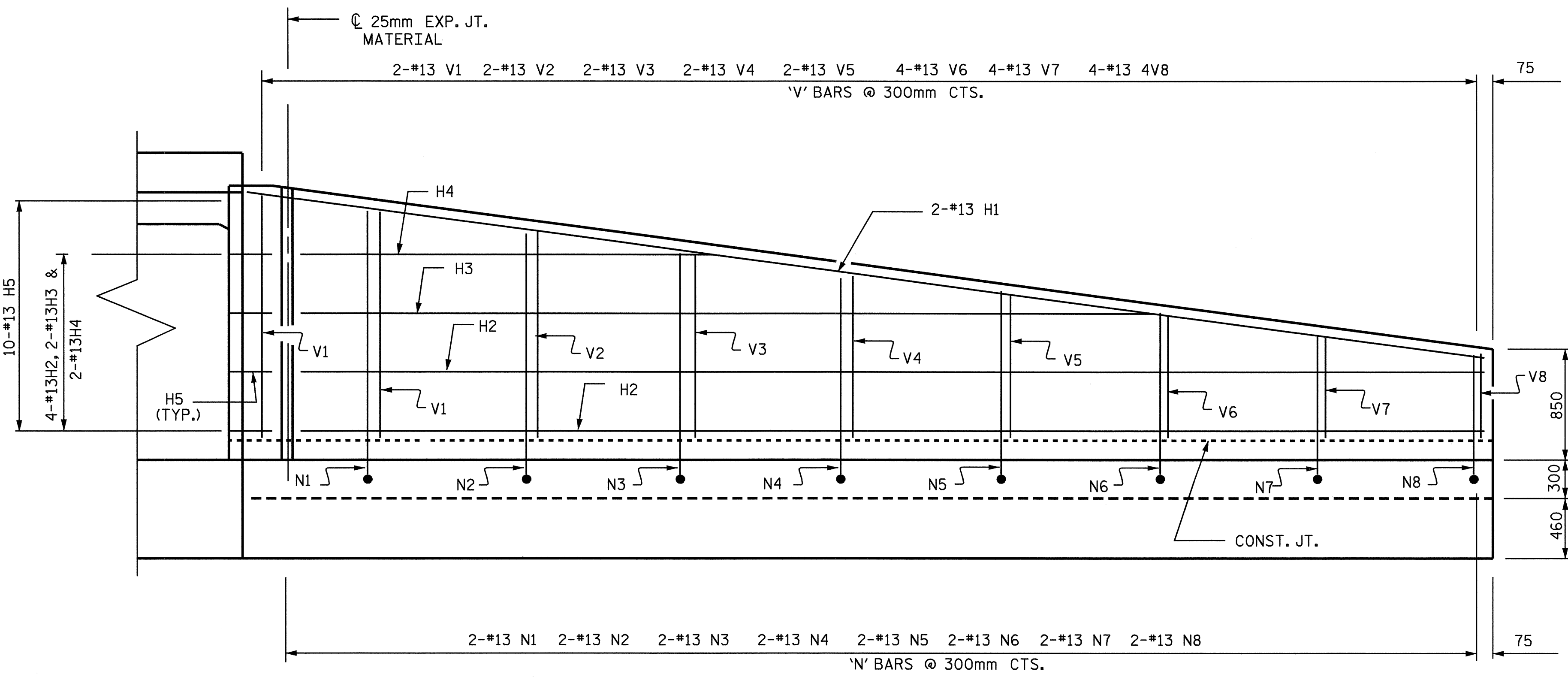

ELEVATION

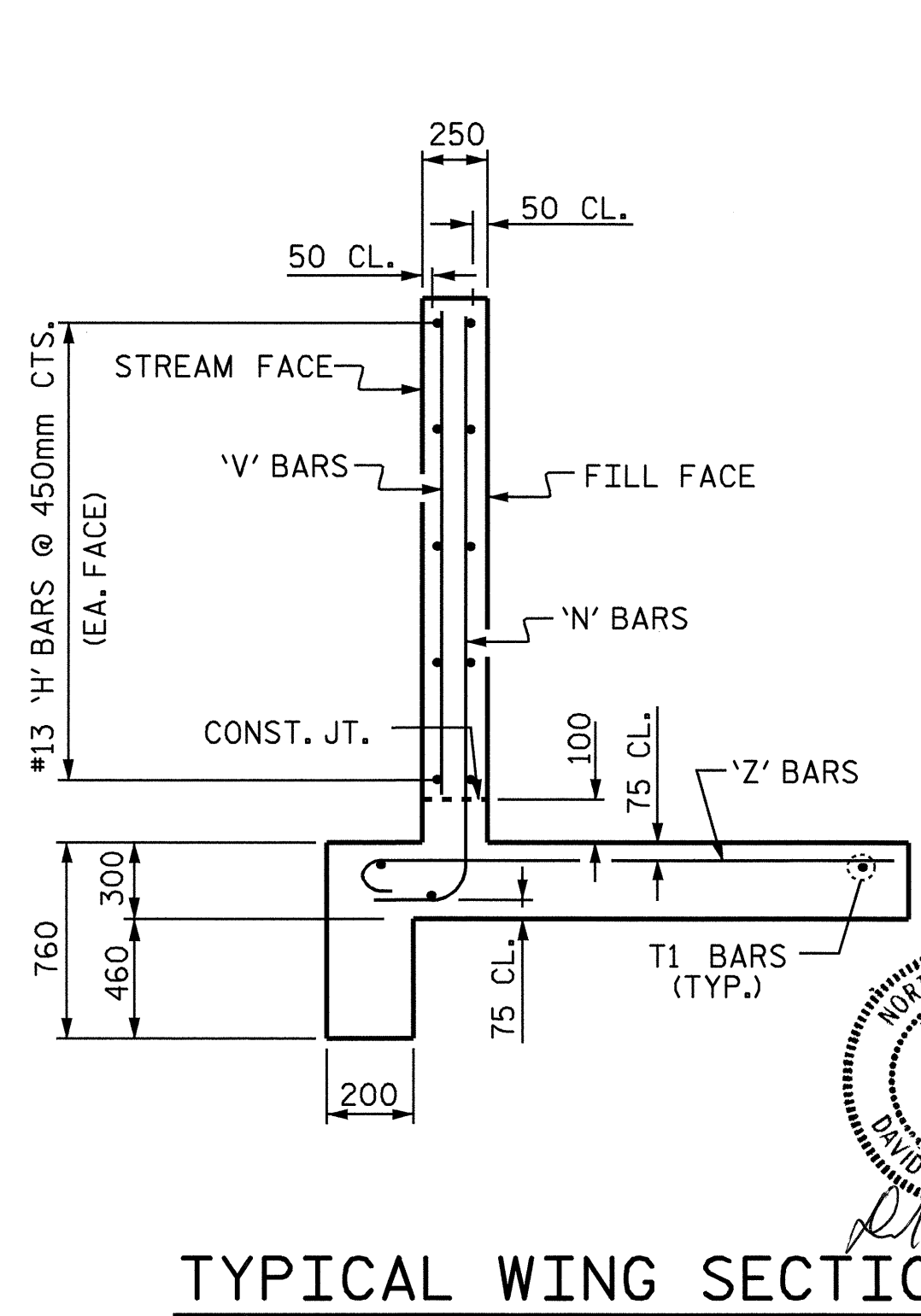

TYPICAL WING SECTION

SPLICE LENGTH CHART

BAR SIZE	SPLICE LENGTH
"H"	13 540

PROJECT NO. R-513BA
 ROBESON COUNTY
 STATION: 14+40.000 -Y1-

SHEET 5 OF 5

STATE OF NORTH CAROLINA
 DEPARTMENT OF TRANSPORTATION
 RALEIGH
 WINGS FOR INLET END
 CONCRETE BOX CULVERT
 H = 1.800m SLOPE = 3 : 1
 90° FOR INLET WING

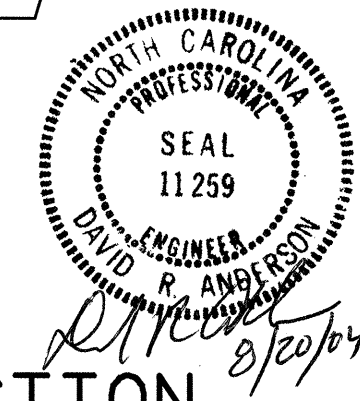

ASSEMBLED BY : N. Q. TRAN DATE : 2-14-03
 CHECKED BY : T. A. WALTER DATE : 4-10-03
 DRAWN BY : KJA 06/97
 CHECKED BY : VAP 06/97

REVISIONS					SHEET NO.
NO.	BY:	DATE:	NO.	BY:	DATE:
1			3		
2			4		

TOTAL SHEETS 24