

ALL WATER LINES OWNED BY ROBESON COUNTY

PROP. 501M OF 300MM PVC WATER PIPE, SDR 21, 1.38MPA WP
 6 - 300MM 22 1/2° DI BENDS
 2 - 300MM 45° DI BENDS
 2 - 300MM 11 1/4° DI BENDS
 CONNECT USING NECESSARY FITTINGS

PROP. 504M - FILL OR REMOVE ABANDONED 300MM PIPE, PVC WATER

MATCHLINE SEE SHEET UC-4 -Y1- Sta. 19+75

MATCHLINE -SR2- Sta. 15+30

MATCHLINE -L- Sta. 27+40

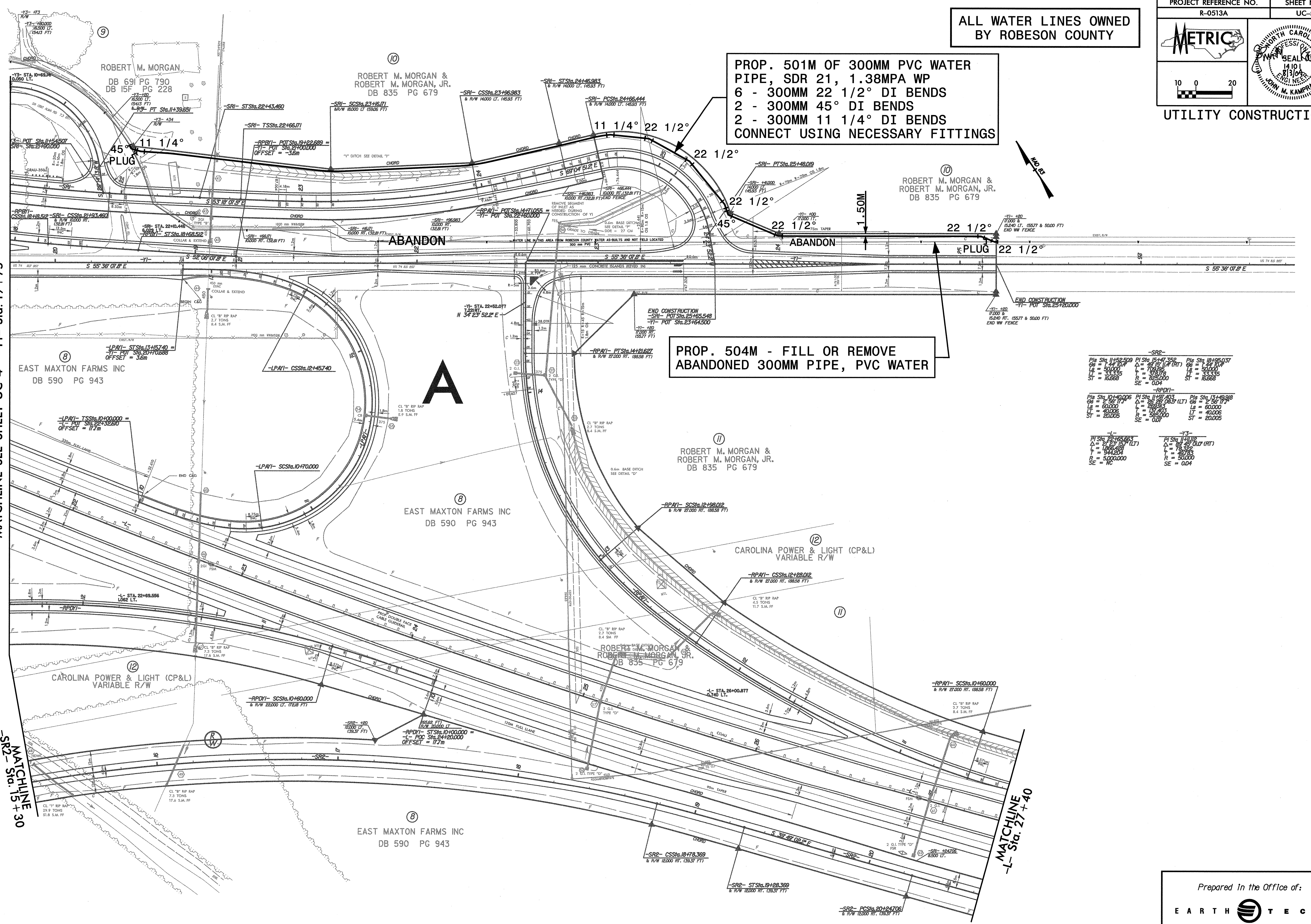

-SR2-		
Pile Sta. 11+52.509	Pile Sta. 15+47.352	Pile Sta. 16+35.037
Δ = 14.077	Δ = 34.771 (RT)	Δ = 22.077
L = 50.000	L = 76.979	L = 50.000
LT = 33.335	LT = 33.335	LT = 33.335
ST = 16.668	R = 825.000	ST = 16.668
	SE = 0.04	

-RPOY-		
Pile Sta. 10+40.006	Pile Sta. 11+47.403	Pile Sta. 13+49.918
Δ = 7.367	Δ = 36.387 (LT)	Δ = 2.581 (RT)
L = 50.000	L = 60.000	L = 50.000
LT = 40.000	L = 131.403	LT = 40.000
ST = 20.000	R = 500.000	ST = 20.000
	SE = 0.07	

-T3-		
Pile Sta. 22+55.663	Pile Sta. 11+11.112	
Δ = 9.275 (LT)	Δ = 83.275 (RT)	
L = 50.000	L = 76.979	
R = 500.000	R = 50.000	
SE = NC	SE = 0.04	

8/17/2015 10:05:05 AM 5/14/2015 10:05:05 AM
 5/14/2015 10:05:05 AM 5/14/2015 10:05:05 AM