

UTILITIES BY OTHERS

NOTE: ALL PROPOSED UTILITY WORK SHOWN ON THIS SHEET WILL BE DONE BY OTHERS

-Y2-		-DW1-	
PIs Sta. 13+03.675 Os = 3° 20' 32.11" Ls = 70.000 T = 46.675 ST = 23.341	PI Sta. 14+17.781 Δ = 17° 12' 26.8" (LT) L = 180.196 T = 90.781 R = 600.000 SE = 0.07	PI Sta. 15+30.537 Os = 3° 20' 32.11" Ls = 70.000 T = 46.675 ST = 23.341	PI Sta. 10+23.763 Δ = 39° 22' 56.7" (RT) L = 13.747 T = 7.158 R = 20.000
-DW2-		-DW3-	-DW4-
PI Sta. 10+17.931 Δ = 26° 10' 09.5" (RT) L = 9.135 T = 4.649 R = 20.000	PI Sta. 10+21.902 Δ = 20° 50' 56.7" (RT) L = 7.278 T = 3.680 R = 20.000	PI Sta. 10+55.949 Δ = 21° 02' 28.5" (RT) L = 7.345 T = 3.714 R = 20.000	-SR4- PI Sta. 10+35.026 Δ = 73° 13' 13.0" (LT) L = 38.338 T = 22.288 R = 30.000 SE = SEE PLANS
-DW6-			
PI Sta. 10+11.584 Δ = 26° 55' 37.3" (RT) L = 7.049 T = 3.591 R = 15.000	PI Sta. 10+41.327 Δ = 10° 41' 50.9" (LT) L = 2.801 T = 1.404 R = 15.000		

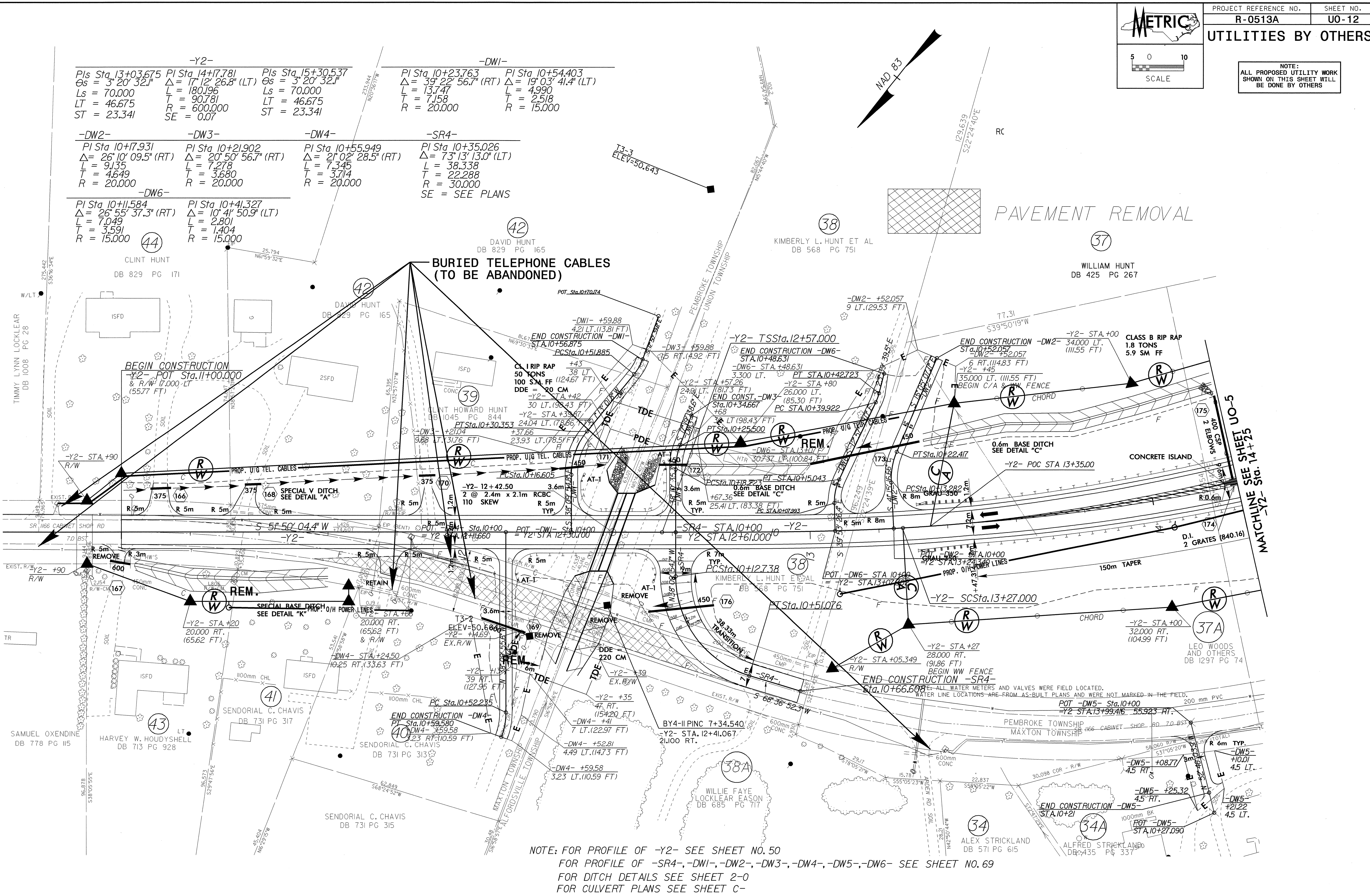

NOTE: FOR PROFILE OF -Y2- SEE SHEET NO. 50  
 FOR PROFILE OF -SR4-, -DW1-, -DW2-, -DW3-, -DW4-, -DW5-, -DW6- SEE SHEET NO. 69  
 FOR DITCH DETAILS SEE SHEET 2-0  
 FOR CULVERT PLANS SEE SHEET C-

RIGHT OF WAY REVISION 05/28/03 ADDED ADD'L DRIVEWAY AND EASEMENT TO PARCEL 38. ALSO MODIFIED EASEMENT ON PARCEL 38

16-JUL-2004 08:41  
 96000131 16-JUL-2004 08:41  
 96000131