

**TIP PROJECT: R-0513A**

STATE OF NORTH CAROLINA  
 DIVISION OF HIGHWAYS  
 PLAN FOR PROPOSED  
 HIGHWAY EROSION CONTROL

**ROBESON COUNTY**

**LOCATION: US 74 FROM MAXTON BYPASS TO 1.82 KILOMETERS  
 EAST OF SR 1166 (CABINET SHOP RD)**

**TYPE OF WORK: GRADING, DRAINAGE, PAVING, STRUCTURES,  
 SIGNING, SIGNALS AND GUIDERAIL**

|                             |                |             |              |
|-----------------------------|----------------|-------------|--------------|
| STATE PROJECT REFERENCE NO. |                | SHEET NO.   | TOTAL SHEETS |
| N.C. R-0513A                |                | EC-1        |              |
| STATE PROJ. NO.             | F.A. PROJ. NO. | DESCRIPTION |              |
|                             |                |             |              |
|                             |                |             |              |
|                             |                |             |              |
|                             |                |             |              |

ALL DIMENSIONS IN THESE  
 PLANS ARE IN METERS  
 UNLESS OTHERWISE SHOWN

**EROSION AND SEDIMENT CONTROL MEASURES**

| Std. #  | Description                          | Symbol |
|---------|--------------------------------------|--------|
|         | Reforestation                        |        |
| 1630.03 | Temporary Silt Ditch                 |        |
| 1630.05 | Temporary Diversion                  |        |
| 1605.01 | Temporary Silt Fence                 |        |
| 1606.01 | Special Sediment Control Fence       |        |
| 1622.01 | Temporary Berms and Slope Drains     |        |
| 1630.01 | Riser Basin                          |        |
| 1630.02 | Silt Basin Type B                    |        |
| 1633.01 | Temporary Rock Silt Check Type-A     |        |
| 1633.02 | Temporary Rock Silt Check Type-B     |        |
| 1634.01 | Temporary Rock Sediment Dam Type-A   |        |
| 1634.02 | Temporary Rock Sediment Dam Type-B   |        |
| 1635.01 | Rock Pipe Inlet Sediment Trap Type-A |        |
| 1635.02 | Rock Pipe Inlet Sediment Trap Type-B |        |
| 1636.01 | Rock Silt Screen                     |        |
| 1630.04 | Stilling Basin                       |        |
|         | Rock Inlet Sediment Trap:            |        |
| 1632.01 | Type A                               |        |
| 1632.02 | Type B                               |        |
| 1632.03 | Type C                               |        |

**THIS PROJECT CONTAINS  
 EROSION CONTROL PLANS  
 FOR CLEARING AND  
 GRUBBING PHASE OF  
 CONSTRUCTION.**

**ENVIRONMENTALLY  
 SENSITIVE AREA(S) EXIST  
 ON THIS PROJECT**  
 Refer To E. C. Special Provisions  
 for Special Considerations.

**HIGH QUALITY WATER(S) EXIST  
 ON THIS PROJECT**  
 High Quality Water Zone(s) Exist  
 From Sta. 8+73.3666  
 to Sta. 65+00 +/-  
 Refer To E. C. Special Provisions  
 for Special Considerations.

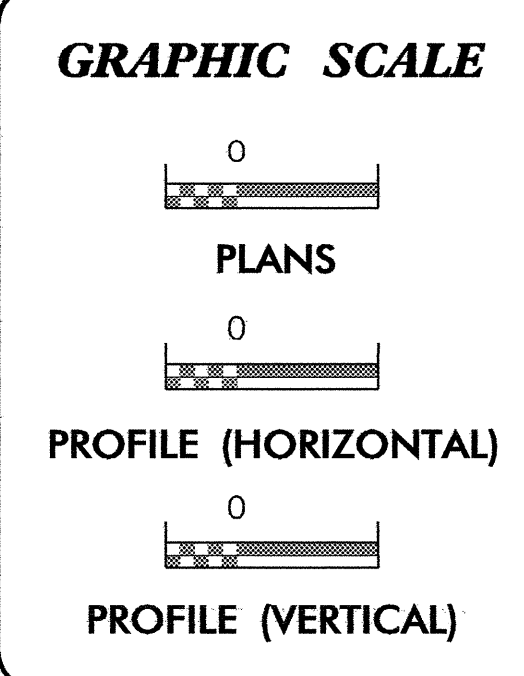
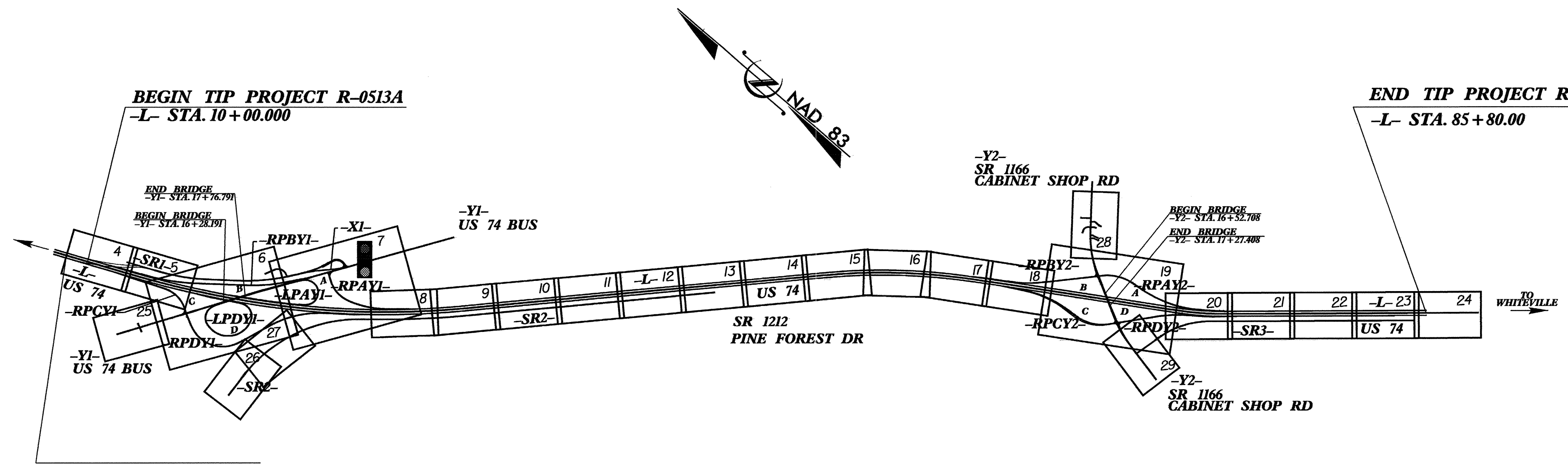

ROADSIDE ENVIRONMENTAL UNIT  
 DIVISION OF HIGHWAYS  
 STATE OF NORTH CAROLINA

Prepared In the Office of:  
**ROADSIDE ENVIRONMENTAL UNIT**  
 1 South Wilmington St.  
 Raleigh, NC 27611  
**2002 STANDARD SPECIFICATIONS**

Roadway Standard Drawings

The following roadway metric standards as appear in "Roadway Standard Drawings"- Roadway Design Unit - N. C. Department of Transportation - Raleigh, N. C., dated January, 2002 and the latest revision thereto are applicable to this project and by reference hereby are considered a part of these plans.

|  |  |
|--|--|
| 1605.01 Temporary Silt Fence             | 1632.03 Rock Inlet Sediment Trap Type C      |
| 1606.01 Special Sediment Control Fence   | 1633.01 Temporary Rock Silt Check Type A     |
| 1622.01 Temporary Berms and Slope Drains | 1633.02 Temporary Rock Silt Check Type B     |
| 1630.02 Silt Basin Type B                | 1634.02 Temporary Rock Sediment Dam Type B   |
| 1630.03 Temporary Silt Ditch             | 1635.01 Rock Pipe Inlet Sediment Trap Type A |
| 1630.04 Stilling Basin                   |  |
| 1630.05 Temporary Diversion              |  |

01-OCT-2004 08:53  
 d:\paw\Ncar\paw\0513A\proj\Proj\0513a.tsh