	PROJECT REFERENCE NO.	SHEET NO.
	R-0513A	EC-41/CONST.16
	R/W SHEET NO.	
ROADWAY DESIGN ENGINEER	HYDRAULICS ENGINEER	
CONST. REV.		
R/W REV.		

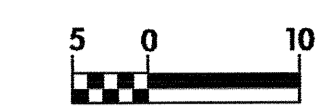

-L-  
 PI Sta 56+80.564  
 $\Delta = 13^{\circ} 53' 46.3''$  (RT)  
 $L = 848.870$   
 $T = 426.528$   
 $R = 3,500.000$   
 SE = REVERSE CROWN

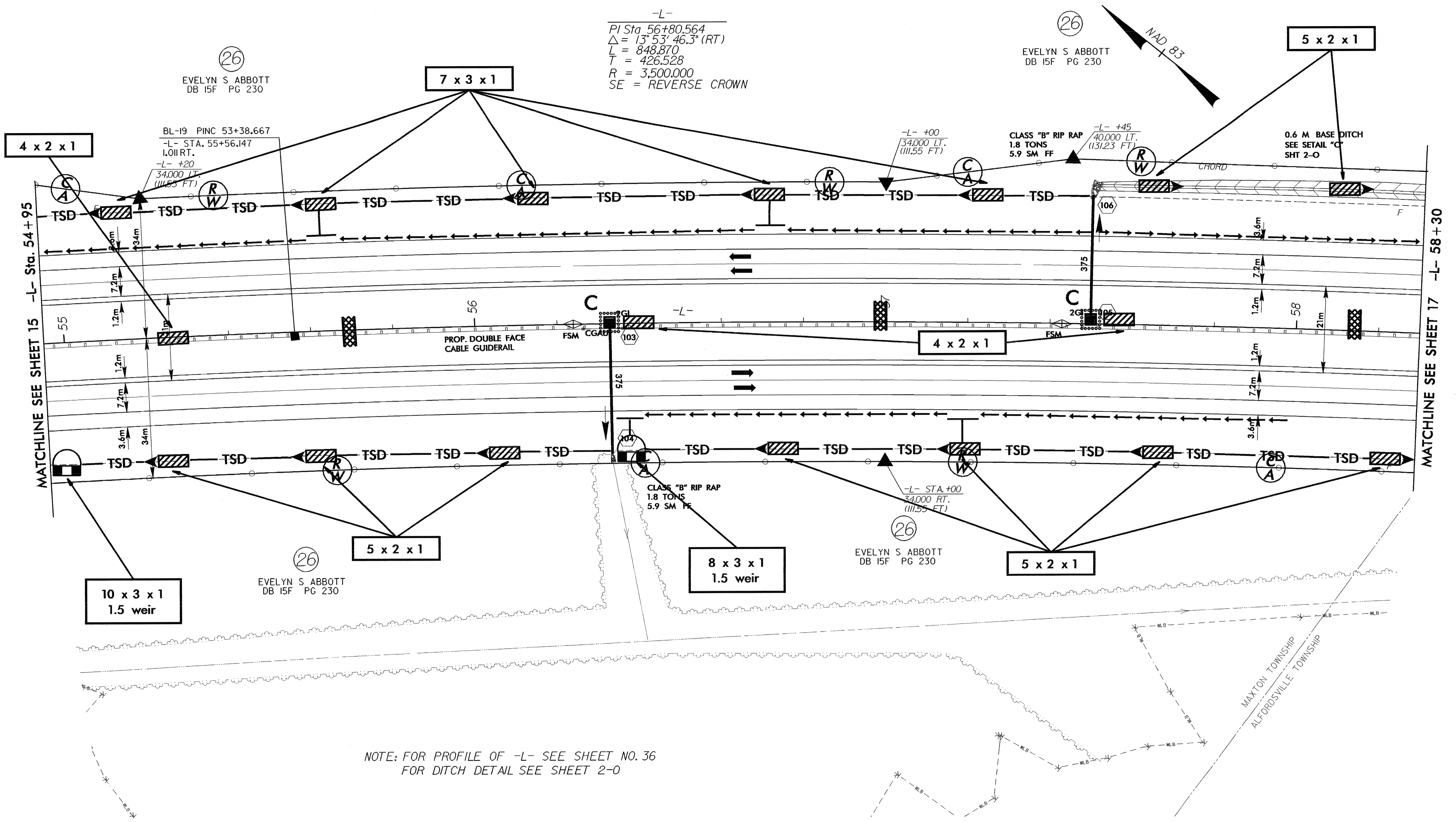

NOTE: FOR PROFILE OF -L- SEE SHEET NO. 36  
 FOR DITCH DETAIL SEE SHEET 2-0

8/17/99

mhaugisch RT