

9/17/25

METRIC

PROJECT REFERENCE NO. R-0513A SHEET NO. 18

R/W SHEET NO.

ROADWAY DESIGN ENGINEER: [Signature]

HYDRAULICS ENGINEER: [Signature]

CONST. REV.

R/W REV.

5 0 10

NAD 83

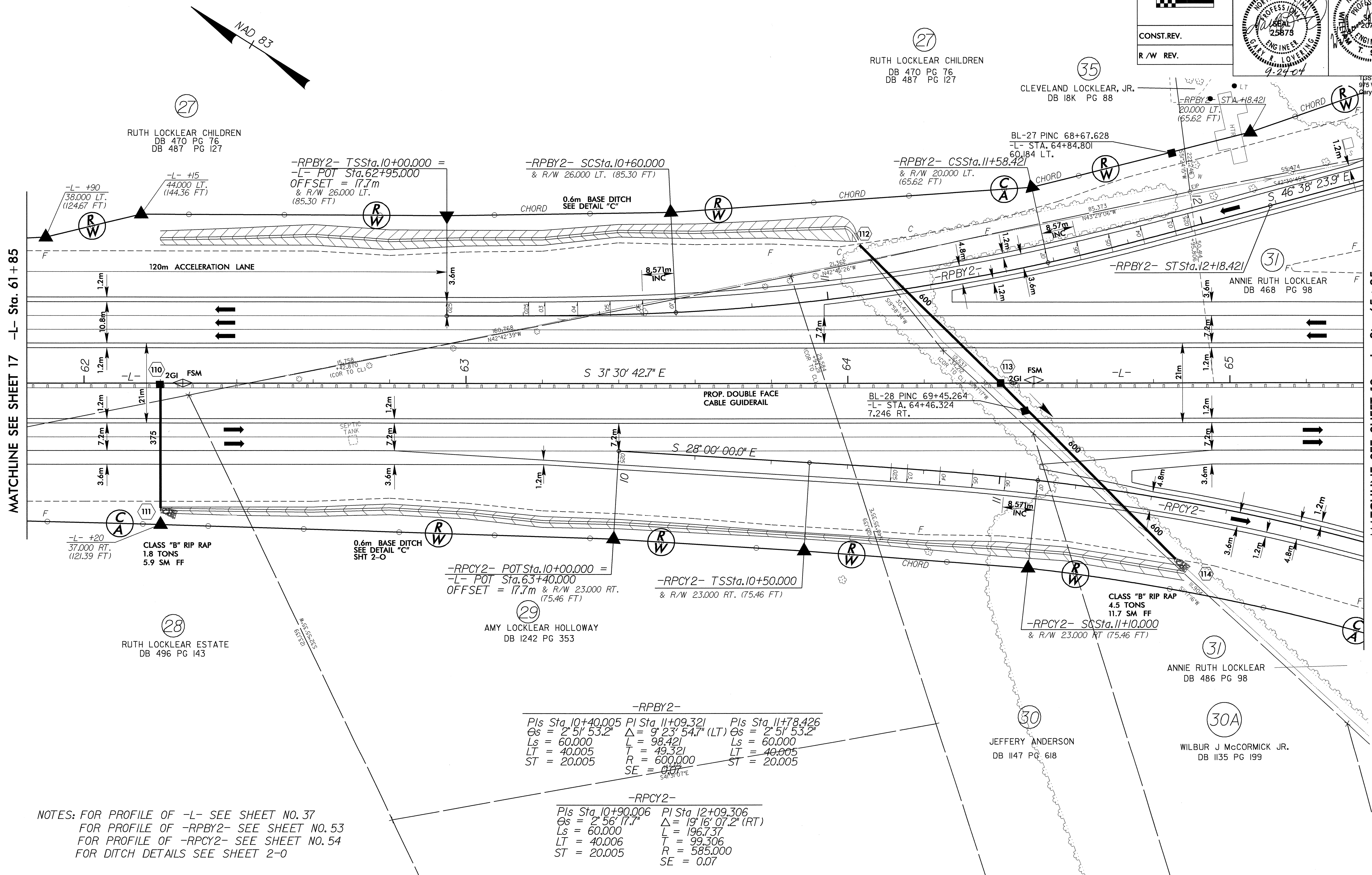

MATCHLINE SEE SHEET 17 -L- Sta. 61 + 85

MATCHLINE SEE SHEET 19 -L- Sta. 65 + 35

NOTES: FOR PROFILE OF -L- SEE SHEET NO. 37
 FOR PROFILE OF -RPBY2- SEE SHEET NO. 53
 FOR PROFILE OF -RPCY2- SEE SHEET NO. 54
 FOR DITCH DETAILS SEE SHEET 2-0

-RPBY2-		
Pls Sta 10+40.005	PI Sta 11+09.321	Pls Sta 11+78.426
$\Theta_s = 2' 51' 53.2''$	$\Delta = 9' 23' 54.7''$ (LT)	$\Theta_s = 2' 51' 53.2''$
$L_s = 60.000$	$L = 98.421$	$L_s = 60.000$
$LT = 40.005$	$T = 49.321$	$LT = 40.005$
$ST = 20.005$	$R = 600.000$	$ST = 20.005$
	$SE = 0.07$	

-RPCY2-	
Pls Sta 10+90.006	PI Sta 12+09.306
$\Theta_s = 2' 56' 17.7''$	$\Delta = 19' 16' 07.2''$ (RT)
$L_s = 60.000$	$L = 196.737$
$LT = 40.006$	$T = 99.306$
$ST = 20.005$	$R = 585.000$
	$SE = 0.07$

21-SEP-2004 11:37
 837-111-1111
 837-111-1111