

8/17/05
 85-AUG-2005 1444
 METRIC
 ROY CHAVIS, JR.
 DB 705 PG 887

 -5 0 10 CONST. REV. _____ R/W REV. _____	PROJECT REFERENCE NO. R-0513A	SHEET NO. 20
	R/W SHEET NO. ROADWAY DESIGN ENGINEER 	HYDRAULICS ENGINEER 

TGS Engineers
 975 Walnut Street, Suite 141
 Cary, NC 27511

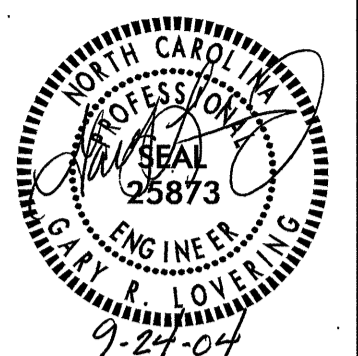
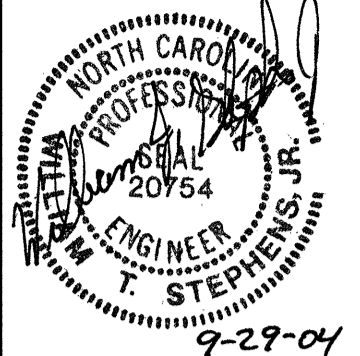
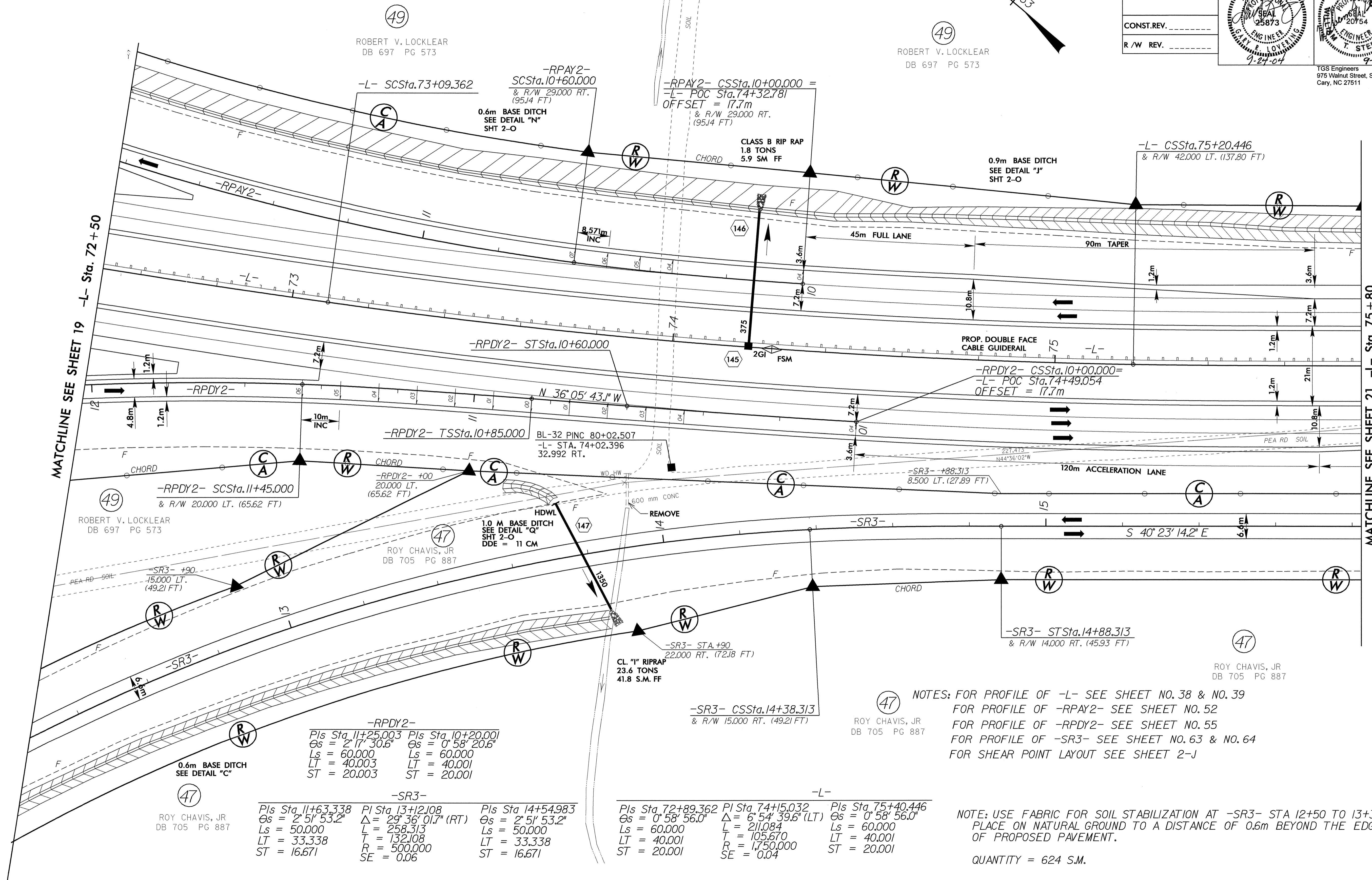

(49)
 ROBERT V. LOCKLEAR
 DB 697 PG 573

(49)
 ROBERT V. LOCKLEAR
 DB 697 PG 573

(49)
 ROBERT V. LOCKLEAR
 DB 697 PG 573

(47)
 ROY CHAVIS, JR.
 DB 705 PG 887

(47)
 ROY CHAVIS, JR.
 DB 705 PG 887

(47)
 ROY CHAVIS, JR.
 DB 705 PG 887

(47)
 ROY CHAVIS, JR.
 DB 705 PG 887

-RPDY2-

Pls Sta. 11+25.003	Pls Sta. 10+20.001
Os = 2° 17' 30.6"	Os = 0° 58' 20.6"
Ls = 60.000	Ls = 60.000
LT = 40.003	LT = 40.001
ST = 20.003	ST = 20.001

-SR3-

Pls Sta. 11+63.338	Pls Sta. 13+12.108	Pls Sta. 14+54.983
Os = 2° 51' 53.2"	Δ = 29° 36' 01.7" (RT)	Os = 2° 51' 53.2"
Ls = 50.000	L = 258.313	Ls = 50.000
LT = 33.338	T = 132.108	LT = 33.338
ST = 16.671	R = 500.000	ST = 16.671
	SE = 0.06	

-L-

Pls Sta. 72+89.362	Pls Sta. 74+15.032	Pls Sta. 75+40.446
Os = 0° 58' 56.0"	Δ = 6° 54' 39.6" (LT)	Os = 0° 58' 56.0"
Ls = 60.000	L = 211.084	Ls = 60.000
LT = 40.001	T = 105.670	LT = 40.001
ST = 20.001	R = 1,750.000	ST = 20.001
	SE = 0.04	

(47) NOTES: FOR PROFILE OF -L- SEE SHEET NO. 38 & NO. 39
 FOR PROFILE OF -RPAY2- SEE SHEET NO. 52
 FOR PROFILE OF -RPDY2- SEE SHEET NO. 55
 FOR PROFILE OF -SR3- SEE SHEET NO. 63 & NO. 64
 FOR SHEAR POINT LAYOUT SEE SHEET 2-J

NOTE: USE FABRIC FOR SOIL STABILIZATION AT -SR3- STA 12+50 TO 13+30,
 PLACE ON NATURAL GROUND TO A DISTANCE OF 0.6m BEYOND THE EDGE
 OF PROPOSED PAVEMENT.
 QUANTITY = 624 S.M.