

6/09/04

BM*4 - RR SPIKE IN BASE OF 250mm OAK
67.562m LT. -L- STA. 36+98.197 EL= 52.892

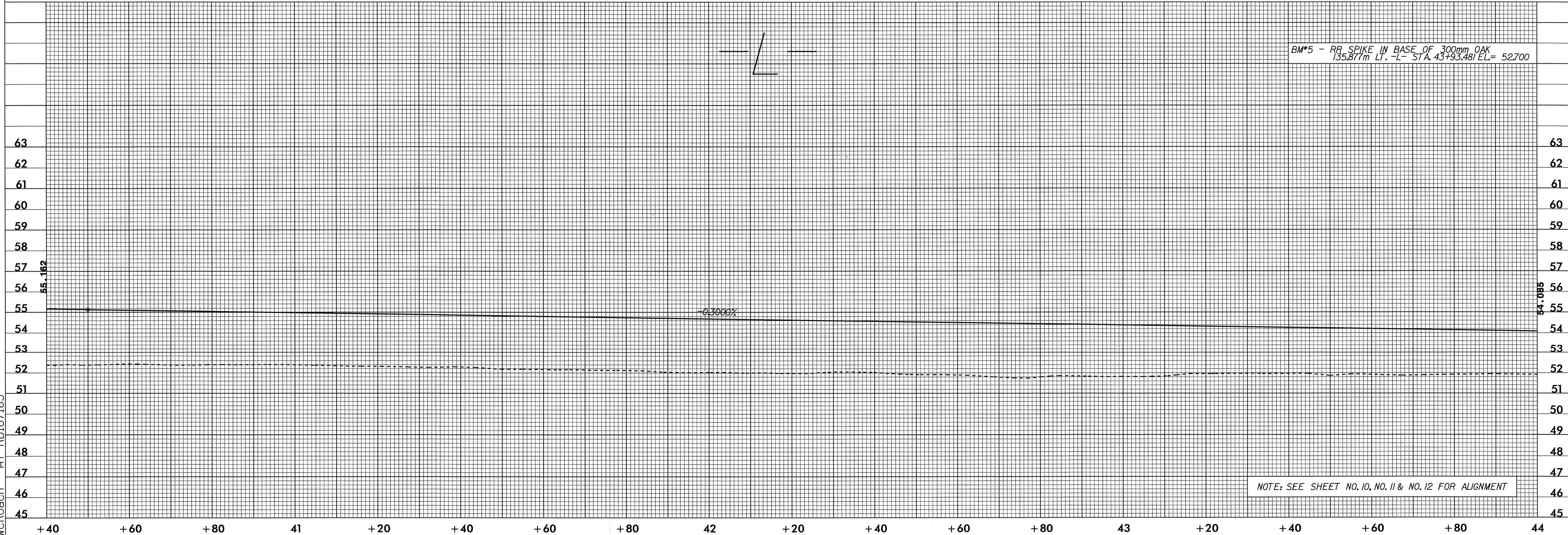

PROJECT REFERENCE NO. R-0513A	SHEET NO. 34
ROADWAY DESIGN ENGINEER	HYDRAULICS ENGINEER
CONST. REV.	TGS ENGINEERS 975 Walnut Street, Suite 141 Cary, NC 27511
R/W REV.	9-24-04

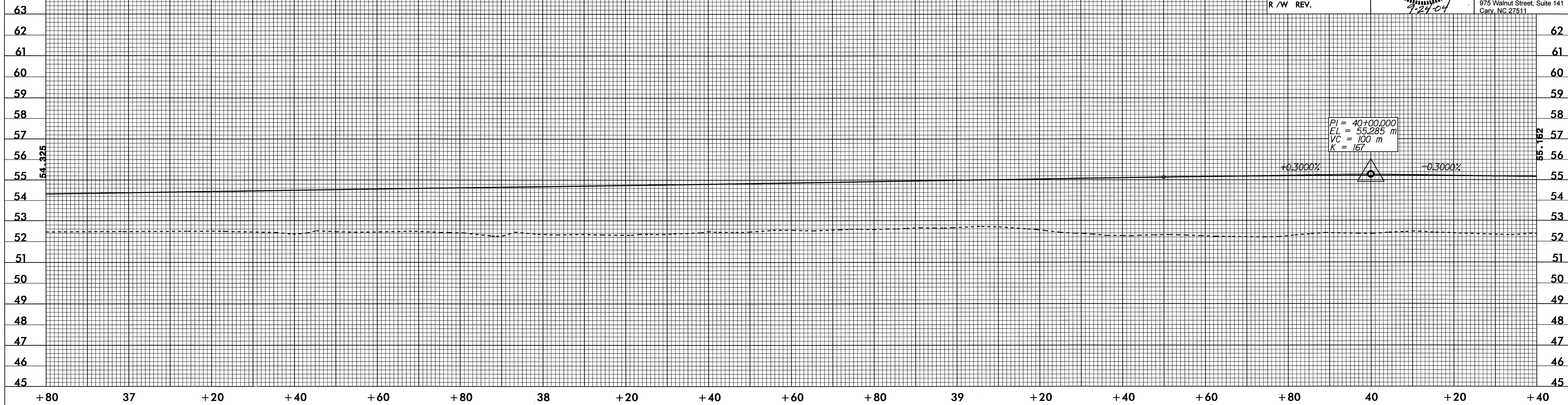
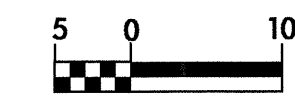

NOTE: SEE SHEET NO. 10, NO. 11 & NO. 12 FOR ALIGNMENT

08-JUL-2004 14:56
R:\Proj\0513\01
McRoach AT RD187165