

5/09/05

DITCH LEGEND  
RIGHT DITCH -----

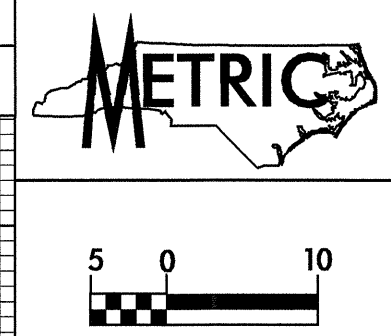

PROJECT REFERENCE NO. R-0513A	SHEET NO. 61
ROADWAY DESIGN ENGINEER <i>[Signature]</i>	HYDRAULICS ENGINEER <i>[Signature]</i>
TGS ENGINEERS 975 Walnut Street, Suite 141 Cary, NC 27511	

—SR2—

$PI = 26+00.000$   
 $EL = 55.579 \text{ m}$   
 $VC = 100 \text{ m}$   
 $K = 167$

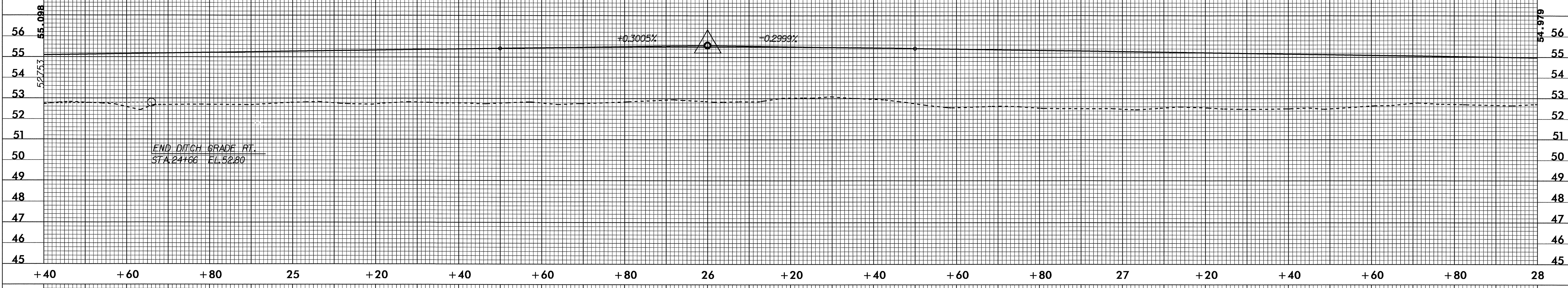

—SR2—

$PI = 29+38.167$   
 $EL = 54.565 \text{ m}$   
 $VC = 100 \text{ m}$   
 $K = 167$

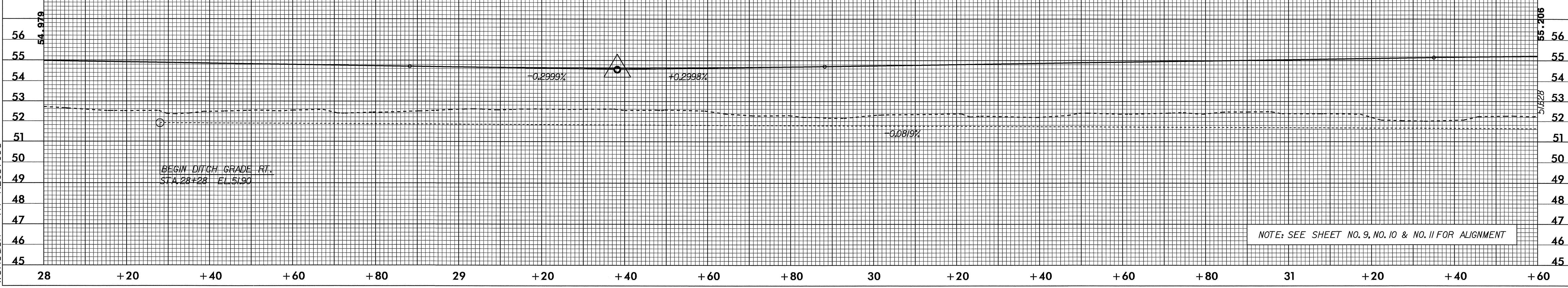

NOTE: SEE SHEET NO. 9, NO. 10 & NO. 11 FOR ALIGNMENT

08-JUL-2004 14:00  
 R:\Proj\0513\01 of 1  
 M. Roach AT RD187165