

R-2206B

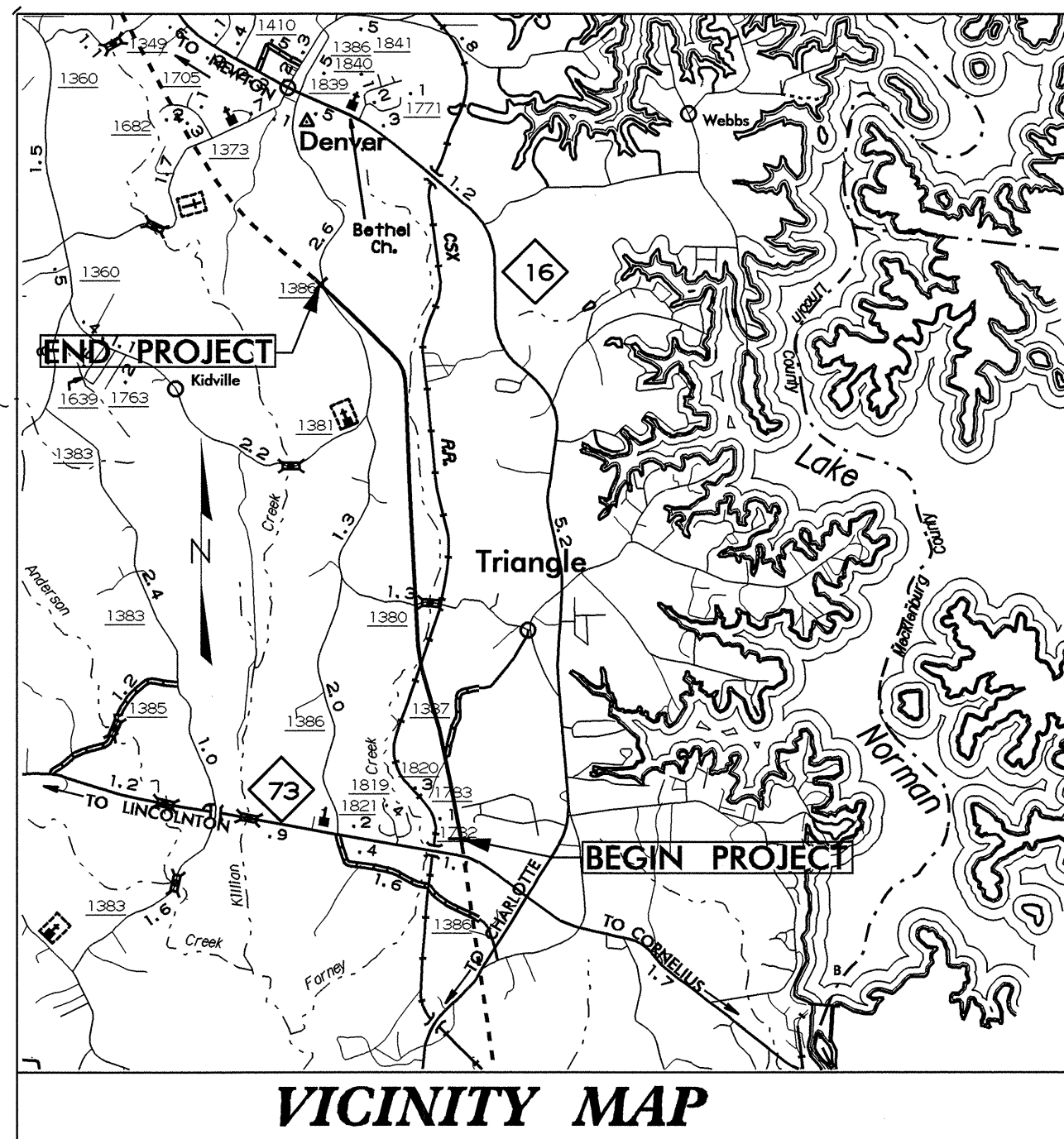

STATE OF NORTH CAROLINA
DIVISION OF HIGHWAYS

UTILITY CONSTRUCTION PLANS
LINCOLN COUNTY

LOCATION: NC 16 BYPASS FROM NORTH OF NC 73 TO NORTH OF SR 1386 (ST. JAMES CHURCH ROAD)

TYPE OF WORK: GRADING, DRAINAGE, STRUCTURES, AND Y'LINE PAVING

METRIC
ALL DIMENSIONS IN THESE PLANS ARE IN METERS AND/OR MILLIMETERS UNLESS OTHERWISE SHOWN

T.I.P. NO.	SHEET NO.
R-2206B	UC-1

VICINITY MAP

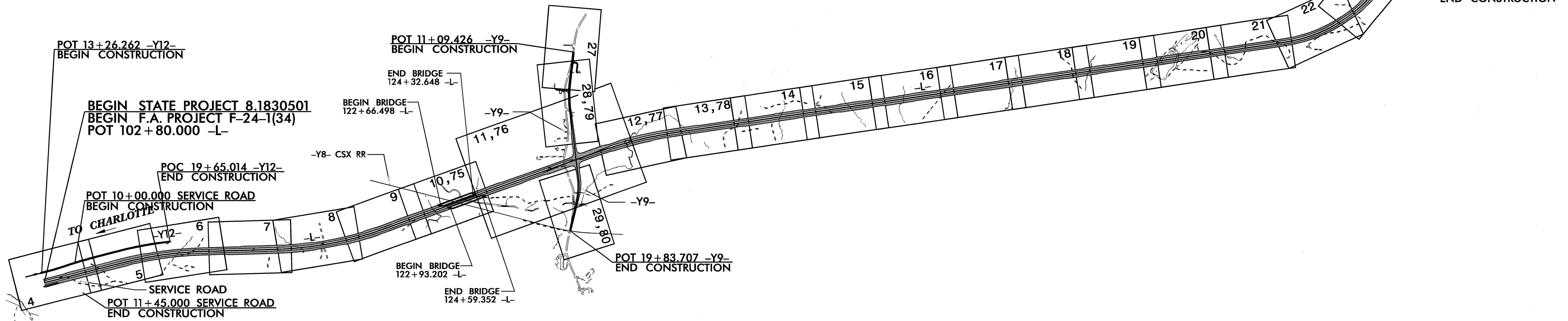
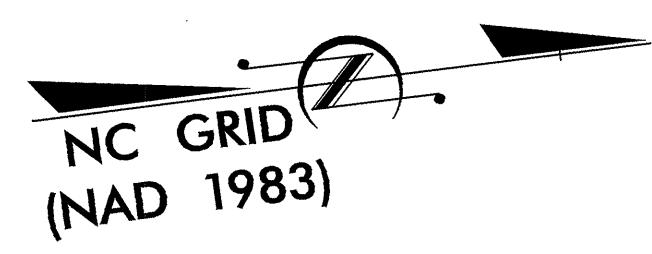
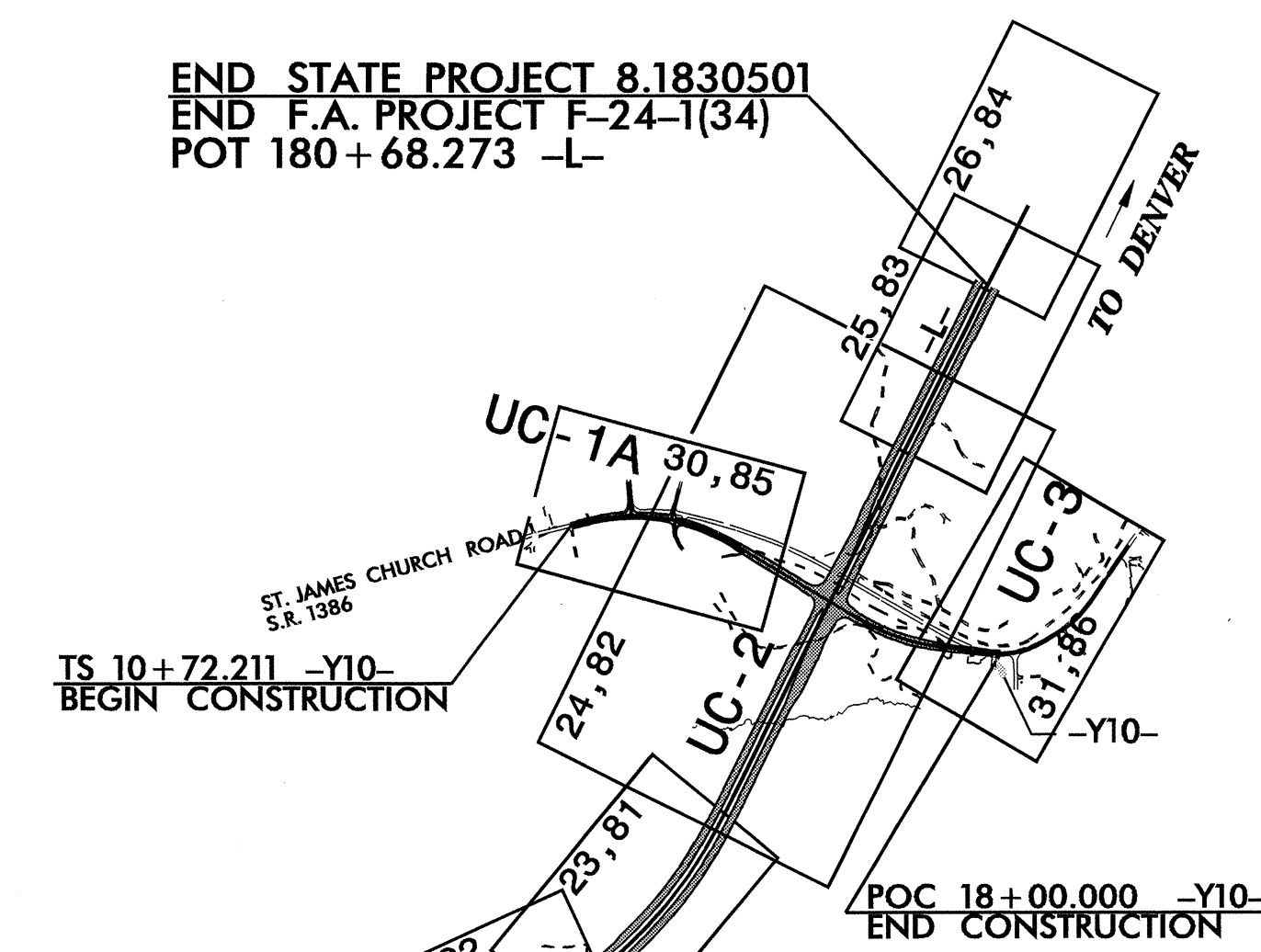

INDEX OF SHEETS	
SHEET NO.	DESCRIPTION
UC-1	TITLE SHEET
UC-1A THRU UC-3	UTILITY CONSTRUCTION PLAN SHEETS

WATER AND SEWER OWNERS ON PROJECT

(1) WATER : LINCOLN COUNTY
(2) SEWER : N/A

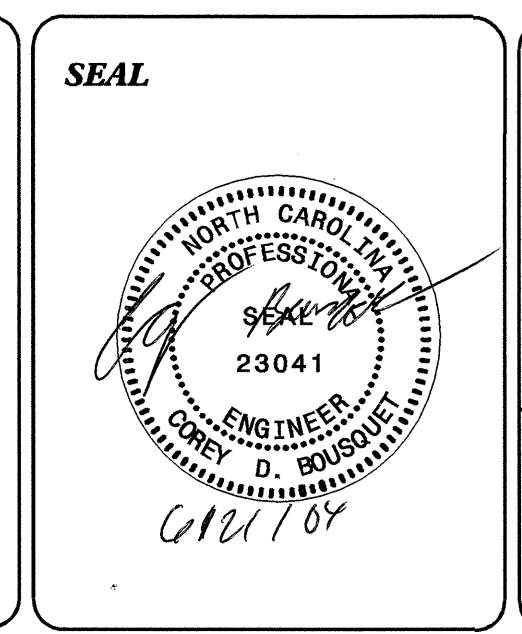

PREPARED IN THE OFFICE OF:
DIVISION OF HIGHWAYS
DESIGN SERVICES
UTILITY SECTION

1591 MAIL SERVICES CENTER
RALEIGH NC 27699-1591
PHONE (919) 250-4128
FAX (919) 250-4119

Roger Worthington, P.E. UTILITIES SECTION ENGINEER
Corey Bousquet, P.E. UTILITIES SQUAD LEADER PROJECT ENGINEER
Jamshid Hafshejani UTILITIES PROJECT DESIGNER