

TRAFFIC DATA

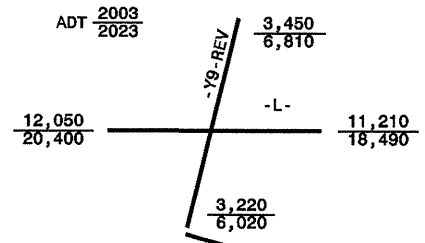

METRIC

PROJECT REFERENCE NO. R-2206B SHEET NO. 12
 R/W SHEET NO.
 ROADWAY DESIGN ENGINEER HYDRAULICS ENGINEER

PRELIMINARY PLANS
 DO NOT USE FOR CONSTRUCTION
INCOMPLETE PLANS
 DO NOT USE FOR R/W ACQUISITION

CONST. REV.
 R/W REV.

WILBUR SMITH ASSOCIATES P.O. BOX 2478 84 E. 100 N. S. 27828-2478
 TRANSITE CONSULTING 1300 PADDOCK DRIVE, SUITE 9-10 84 E. 100 N. S. 27828-2478

-L-
 P.I. = 132+53.381
 $\Delta r = 11' 17" 15.0" (RT)$
 $\Delta c = 8' 58" 01.3" (RT)$
 Rc = 2,000.000
 Lc = 313.009
 Tc = 156.824
 $\theta_s = 1' 09" 36.9"$
 Ls = 81.000
 LT = 54.001
 ST = 27.001
 S.E. = 0.03
 D.S. = 100 kph

-Y9- REV.
 P.I. = 17+80.498
 $\Delta r = 20' 21" 25.8" (RT)$
 $\Delta c = 9' 21" 23.0" (RT)$
 Rc = 250.000
 Lc = 40.825
 Tc = 20.458
 $\theta_s = 5' 30" 01.4"$
 Ls = 48.000
 LT = 32.015
 ST = 16.014
 S.E. = 0.06
 D.S. = 80 kph

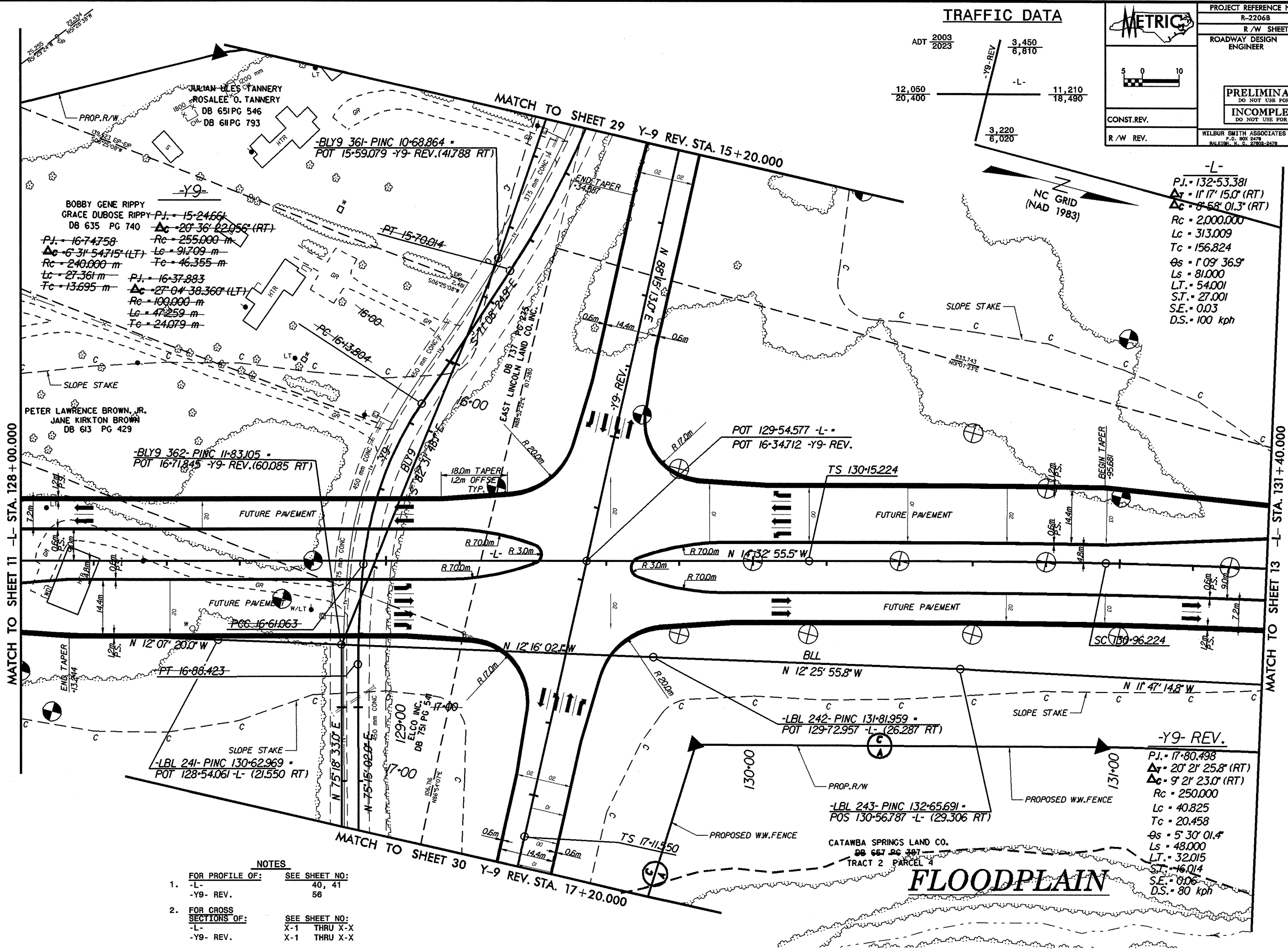

- NOTES**
- FOR PROFILE OF: SEE SHEET NO:
 -L- 40, 41
 -Y9- REV. 56
 - FOR CROSS SECTIONS OF: SEE SHEET NO:
 -L- X-1 THRU X-X
 -Y9- REV. X-1 THRU X-X