

**TYPICAL HALF SECTION @ INTERMEDIATE DIAPHRAGMS**

FOR INTERMEDIATE DIAPHRAGM LOCATIONS AND TYPES, SEE "STRUCTURAL STEEL DETAILS" SHEETS.  
FOR INTERMEDIATE DIAPHRAGM DETAILS, SEE "STRUCTURAL STEEL DETAILS" SHEETS.

**TYPICAL HALF SECTION @ BENT DIAPHRAGMS**

FOR BENT DIAPHRAGM LOCATIONS AND TYPES, SEE "STRUCTURAL STEEL DETAILS" SHEETS.  
FOR BENT DIAPHRAGM DETAILS, SEE "STRUCTURAL STEEL DETAILS" SHEETS.

**NOTES**

- PROVIDE 32mm HIGH BEAM BOLSTERS UPPER AT 1.200m CTS. ATOP THE METAL STAY-IN-PLACE FORMS TO SUPPORT THE BOTTOM MAT OF 'A' BARS. WHEN USING REMOVABLE FORMS, PROVIDE CONTINUOUS HIGH CHAIRS FOR METAL DECK (C.H.C.M.) @ 1.200m CTS. WITH A HEIGHT TO SUPPORT THE BOTTOM MAT OF 'A' BARS A CLEAR DISTANCE OF 65mm ABOVE THE TOP OF THE REMOVABLE FORM.
- THE JOINT BETWEEN THE DECK AND APPROACH SLAB SHALL BE SAWED PRIOR TO THE CASTING OF THE BARRIER RAIL.
- NO WELDING OF METAL STAY-IN-PLACE FORMS OR FALSEWORK TO THE TOP FLANGES OF CONTINUOUS GIRDERS WILL BE PERMITTED IN REGIONS REQUIRING A CHARTY V-NOTCH TEST. SEE STRUCTURAL STEEL DETAILS SHEETS 2 & 3 OF 6, "GIRDER ELEVATION" FOR REGIONS.
- PREVIOUSLY CAST CONCRETE IN A CONTINUOUS UNIT SHALL HAVE ATTAINED A MINIMUM COMPRESSIVE STRENGTH OF 20.7 MPa BEFORE ADDITIONAL CONCRETE IS CAST IN THE UNIT.
- STRUCTURAL STEEL ERECTION IN A CONTINUOUS UNIT SHALL BE COMPLETE BEFORE FALSEWORK OR FORMS ARE PLACED ON THE UNIT.
- THE CONTRACTOR MAY, WHEN NECESSARY, PROPOSE A SCHEME FOR AVOIDING INTERFERENCE BETWEEN METAL STAY-IN-PLACE FORM SUPPORTS OR FORMS AND GIRDER STIFFENERS OR CONNECTOR PLATES. THE PROPOSAL SHALL BE INDICATED, AS APPROPRIATE, ON EITHER THE STEEL WORKING DRAWINGS OR THE METAL STAY-IN-PLACE FORM WORKING DRAWINGS.
- THE CONTRACTOR SHALL ADJUST THE GIRDER BUILDUPS AS NECESSARY TO INCORPORATE A MAXIMUM PERMISSIBLE VARIATION IN POT BEARING DEPTH OF 13mm, SEE SPECIAL PROVISION FOR POT BEARINGS.

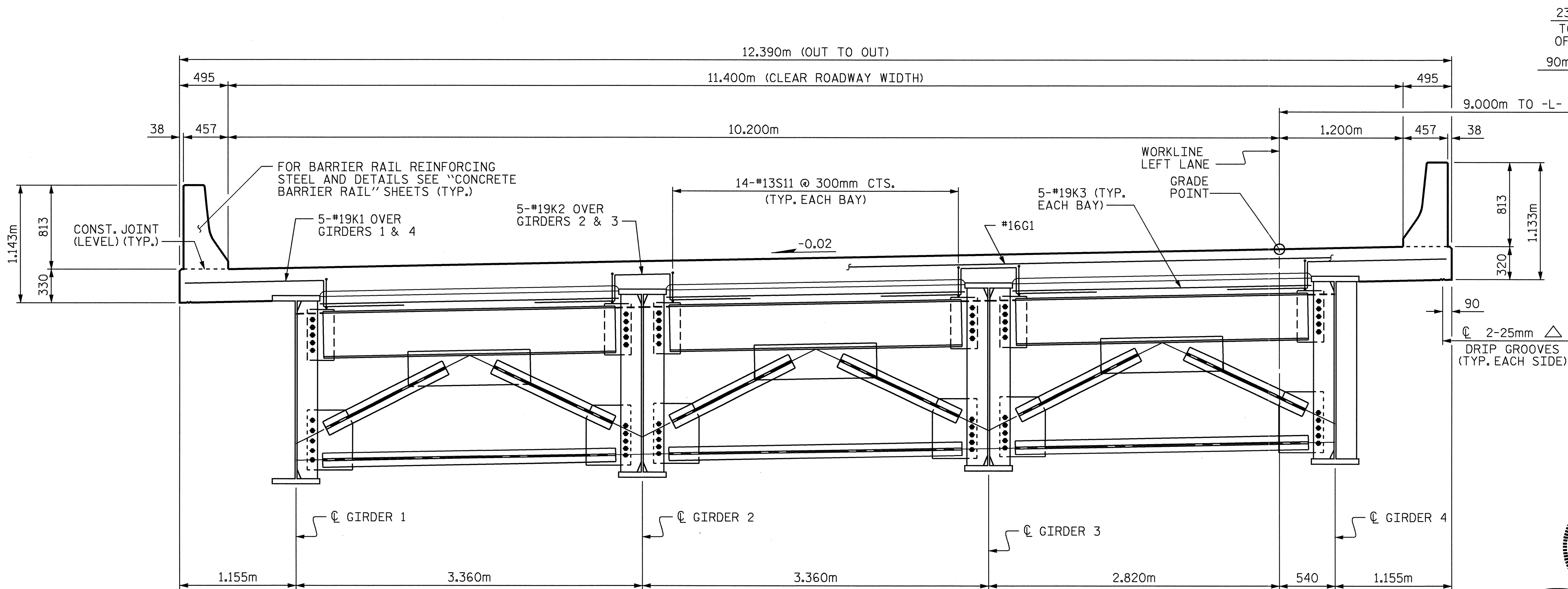

**TYPICAL SECTION @ END BENT DIAPHRAGMS**

FOR END BENT DIAPHRAGM LOCATIONS AND TYPES, SEE "STRUCTURAL STEEL DETAILS" SHEETS.  
FOR END BENT DIAPHRAGM DETAILS, SEE "STRUCTURAL STEEL DETAILS" SHEETS.

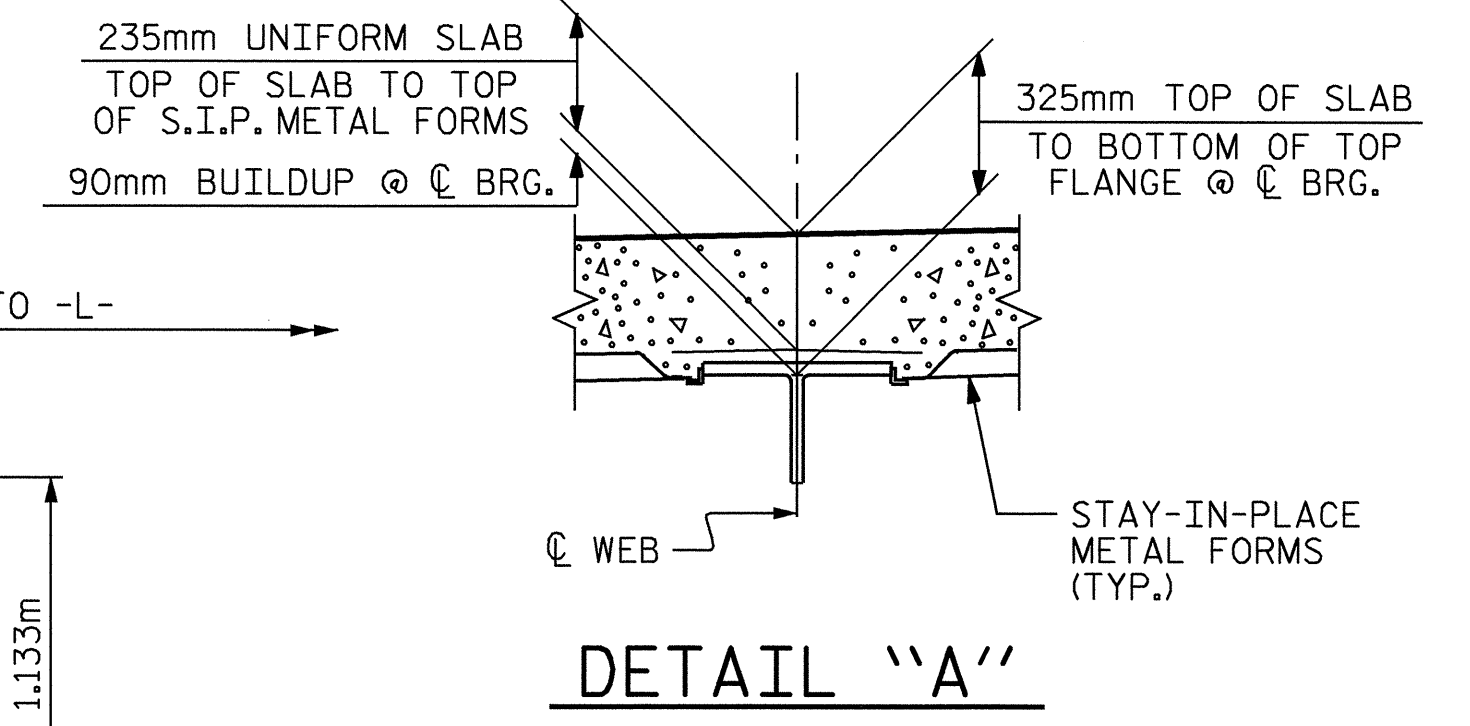

**DETAIL "A"**

PROJECT NO. R-2206B  
LINCOLN COUNTY  
STATION: 123+38.105 -L-

SHEET 1 OF 2

STATE OF NORTH CAROLINA  
DEPARTMENT OF TRANSPORTATION  
RALEIGH  
**SUPERSTRUCTURE**  
**TYPICAL SECTIONS**  
(LEFT LANE)

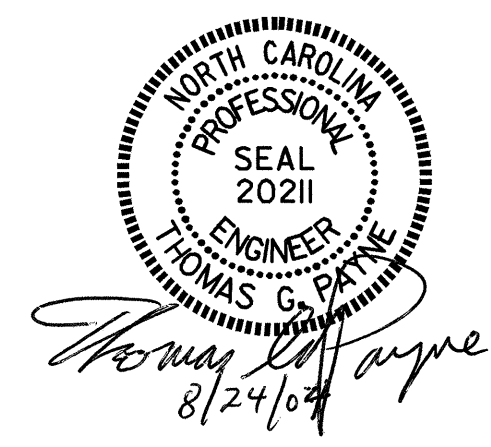

DRAWN BY: M. J. OSTRISHKO DATE: 4-2-01  
CHECKED BY: E. G. ALLEN DATE: 4-20-01

REVISIONS				SHEET NO.
NO.	BY:	DATE:	NO.	DATE:
1			3	
2			4	

S-6  
TOTAL SHEETS  
86