

NOTE:
TEMPORARY SILT FENCE SHALL BE INSTALLED A MINIMUM OF 1 METER FROM TOE OF FILL IN WETLAND AREAS

NOTES

- FOR PROFILE OF: SEE SHEET NO:
1. -L- 38 THRU 40
Y9 56 THRU 57
- FOR CROSS SECTIONS OF: SEE SHEET NO:
-L- X-38 THRU X-51
Y9 X-153 THRU X-161
- FOR 2 - 4.3 x 3.0 RCBC SEE SHEET NO:
C-



CONST. REV.

R/W REV.

| | |
|----------------------------------|------------------------------|
| PROJECT REFERENCE NO. R-2206B | SHEET NO. EC-40/CONST. 11 |
| R/W SHEET NO. | |
| ROADWAY DESIGN ENGINEER | HYDRAULICS ENGINEER |

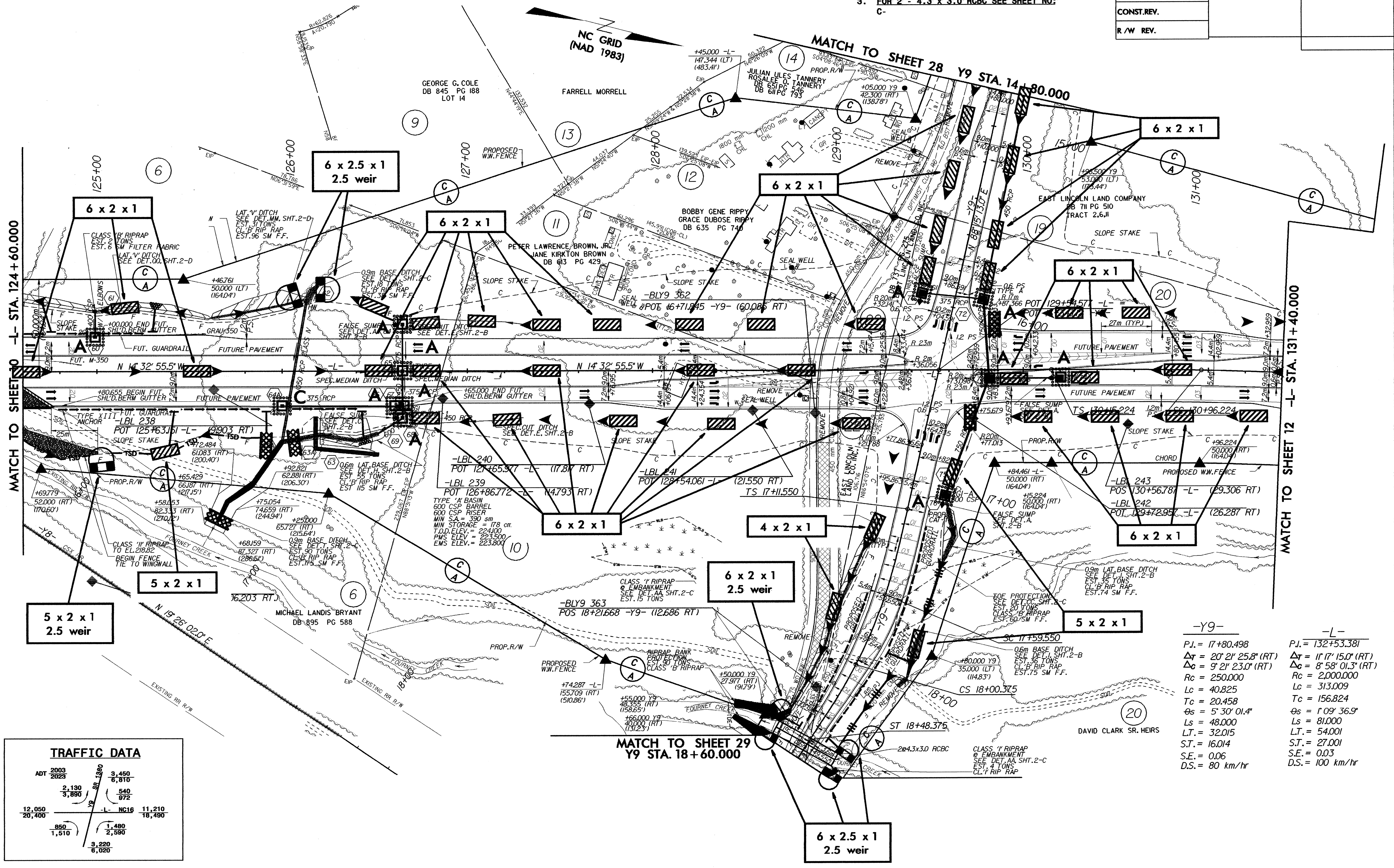

TRAFFIC DATA

| | |
|------------------|------------------|
| ADT 2003 2025 | 3,450 6,810 |
| 2,130 3,890 | 540 972 |
| 12,050 20,400 | 11,210 18,480 |
| 850 1,510 | 1,480 2,590 |
| | 3,220 6,020 |

| | |
|----------------------------------|----------------------------------|
| -Y9- | -L- |
| P.J. = 17+80.498 | P.J. = 132+53.381 |
| $\Delta T = 20' 21' 25.8''$ (RT) | $\Delta T = 11' 17' 15.0''$ (RT) |
| $\Delta C = 9' 21' 23.0''$ (RT) | $\Delta C = 8' 58' 01.3''$ (RT) |
| $R_c = 250.000$ | $R_c = 2,000.000$ |
| $L_c = 40.825$ | $L_c = 313.009$ |
| $T_c = 20.458$ | $T_c = 156.824$ |
| $\theta_s = 5' 30'' 01.4''$ | $\theta_s = 1' 09' 36.9''$ |
| $L_s = 48.000$ | $L_s = 81.000$ |
| $L.T. = 32.015$ | $L.T. = 54.001$ |
| $S.T. = 16.014$ | $S.T. = 27.001$ |
| $S.E. = 0.06$ | $S.E. = 0.03$ |
| $D.S. = 80$ km/hr | $D.S. = 100$ km/hr |