

AREA III



PROJ. REFERENCE NO.	SHEET NO.
R-2206C	TCP-14

PHASE II

STEP 1. USING RSD NO. 1101.02 (SHEET 1 OF 7), COMPLETE -Y14DET- CONSTRUCTION FROM STA. 11+80+/- TO STA. 18+20+/-, INCLUDING PROPOSED DRAINAGE AND TEMPORARY CAPS FOR GRATE INLETS (SEE ROADWAY PLANS) AND TEMPORARY DRAINAGE, UP TO FINAL LAYER OF SURFACE COURSE, SEE SECTION A-A.

CONSTRUCT -Y14DET- WIDENING FROM STA. 10+31+/- TO STA. 11+80+/- AND STA. 18+20+/- TO STA. 19+87+/- INCLUDING TEMPORARY DRAINAGE, UP TO EXISTING SHOULDER ELEVATIONS, MAINTAINING A TEMPORARY 2:1 SLOPE TO EXISTING SHOULDER BREAK POINT.

INSTALL ALL BARRICADES AND DRUMS AS SHOWN ON THIS SHEET. MAINTAIN EXISTING TRAFFIC PATTERN ON NC 150. MAINTAIN ACCESS TO ALL DRIVEWAYS WITHIN PROJECT LIMITS.

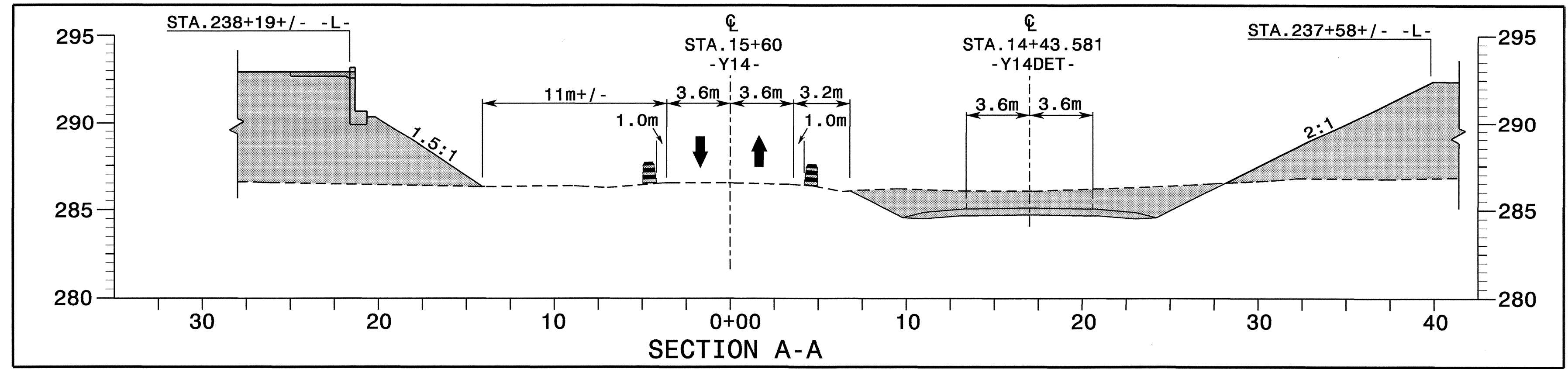
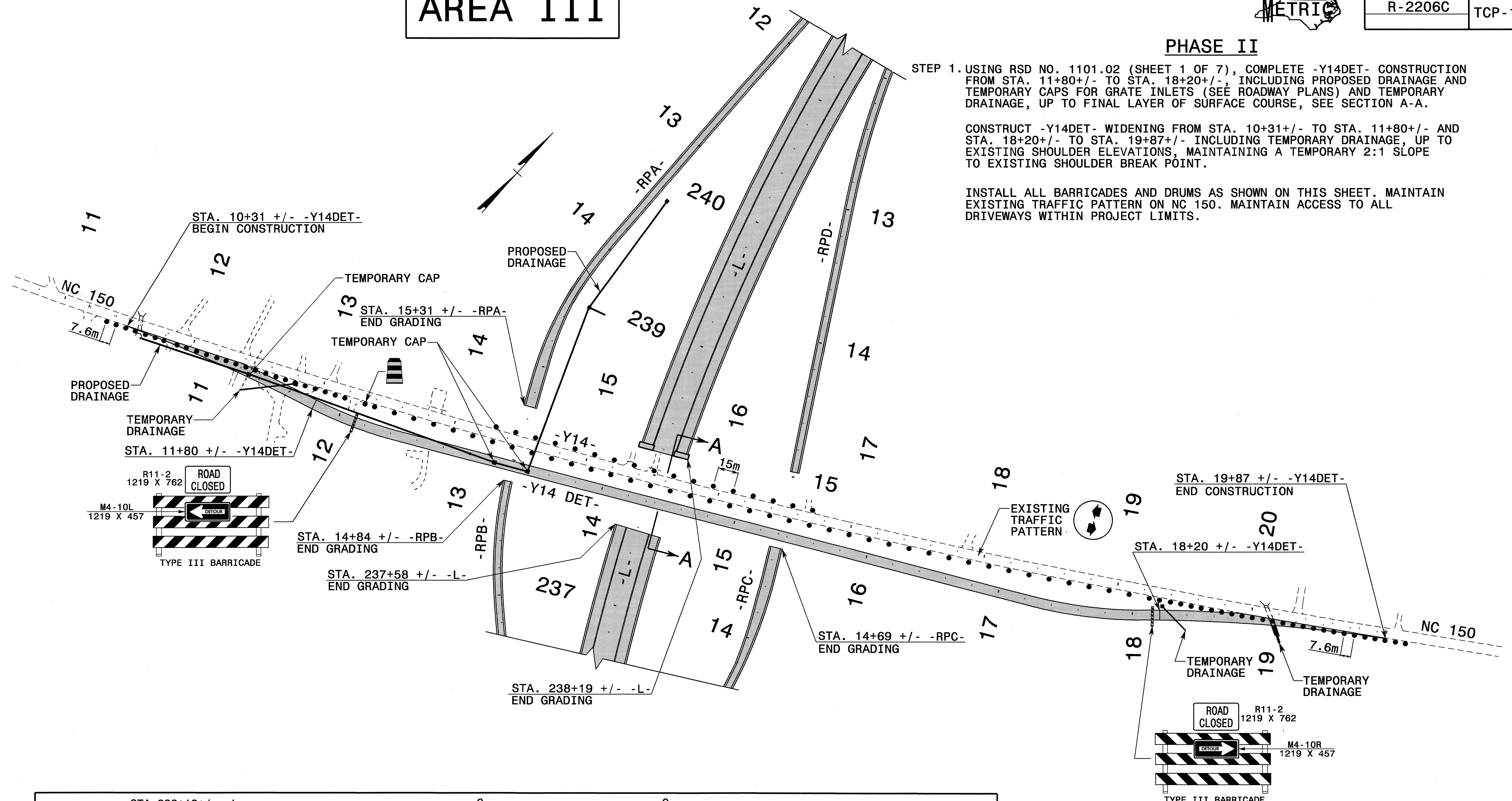

APPROVED: <i>[Signature]</i> DATE: 7/1/04	<h3>AREA 3 PHASE II DETAILS AND PHASING</h3>		REVISIONS			
			SCALE: 1:1500 DATE: 05-10-04 DWG. BY: SBC DESIGN BY: SBC REVIEWED BY: CLM	<table border="1"> <tr> <td> </td> <td> </td> </tr> <tr> <td> </td> <td> </td> </tr> </table>		

12-JUL-2004 15:28
 K:\TCP-AREAS\12206C.TC-AREA3-1\cp14.dgn
 S:\CP-AREAS\12206C.TC-AREA3-1\cp14.dgn