

AREA III

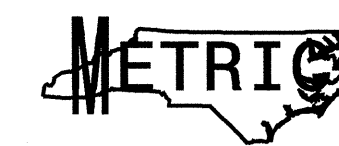

PROJ. REFERENCE NO.	SHEET NO.
R-2206C	TCP-15

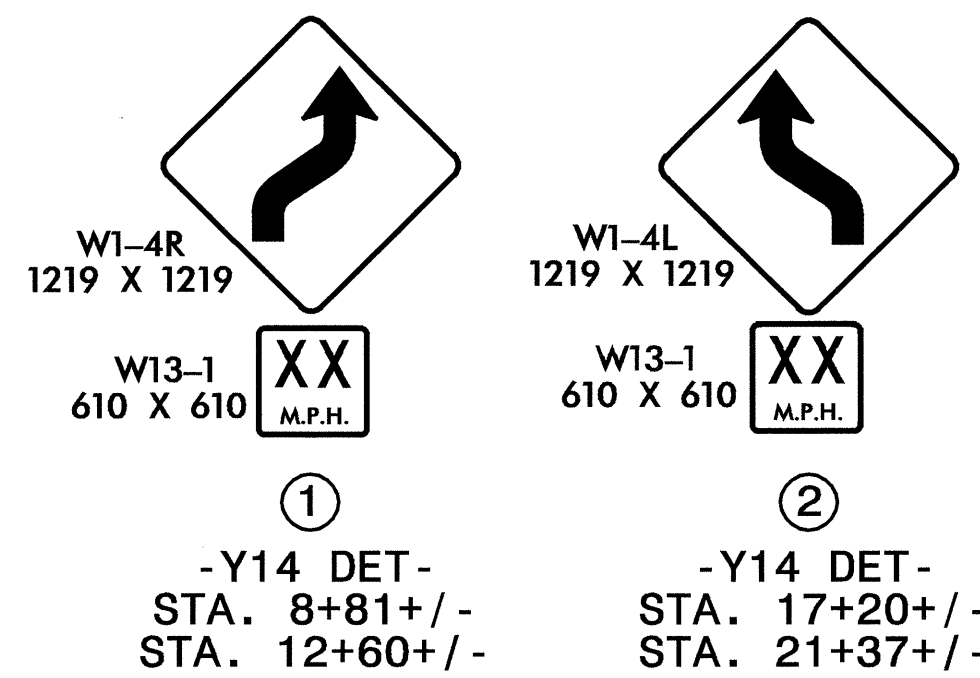

PHASE III

STEP 1. USING RSD NO. 1101.02 (SHEET 1 OF 7), CONSTRUCT -Y14- FROM STA. 12+70 +/- TO STA. 19+50 +/-, EXCLUDING RIGHT TURN LANE AND RIGHT PAVED SHOULDER FROM STA. 13+25 +/- TO STA. 16+25 +/-, INCLUDING DRAINAGE, UP TO BUT NOT INCLUDING FINAL LAYER OF SURFACE COURSE, (SEE SECTION A-A).

CONSTRUCT -Y14- WIDENING FROM STA. 12+20 +/- TO STA. 12+70 +/- AND STA. 19+50 +/- TO STA. 21+00 +/-, UP TO EXISTING EDGE OF SHOULDER ELEVATIONS, MAINTAINING A TEMPORARY 2:1 SLOPE TO EXISTING SHOULDER BREAK POINT.

INSTALL WATERFILLED BARRIER AS SHOWN ON THIS SHEET, (SEE SECTION B-B).

AWAY FROM TRAFFIC, CONSTRUCT PROPOSED LEFT SIDE EXTENSION TO EXISTING CULVERT.

INSTALL ALL BARRICADES AND DRUMS AS SHOWN ON THIS SHEET. MAINTAIN EXISTING TRAFFIC PATTERN ON -Y14DET- (NC 150). MAINTAIN ACCESS TO ALL DRIVEWAYS WITHIN PROJECT LIMITS.

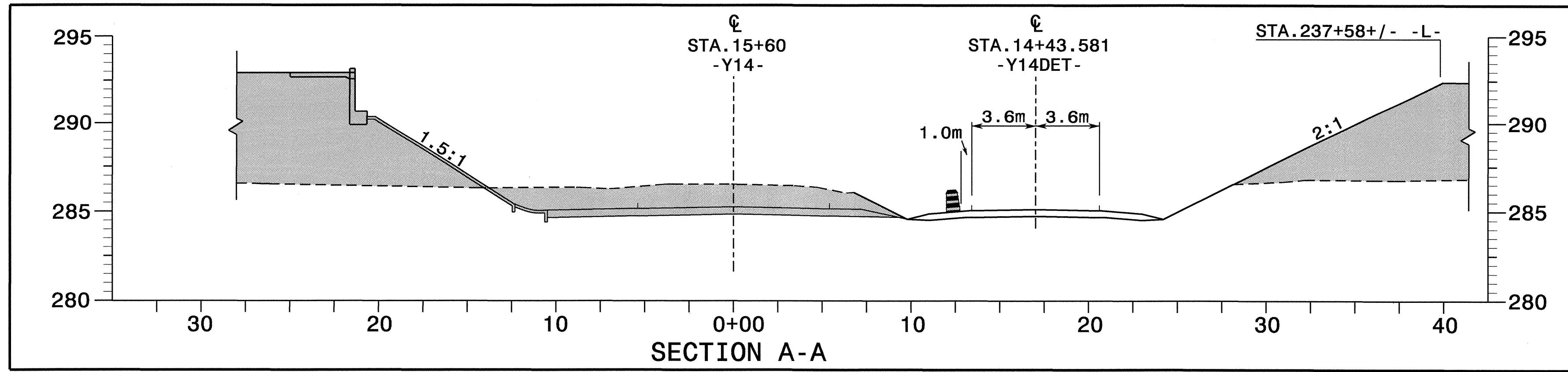
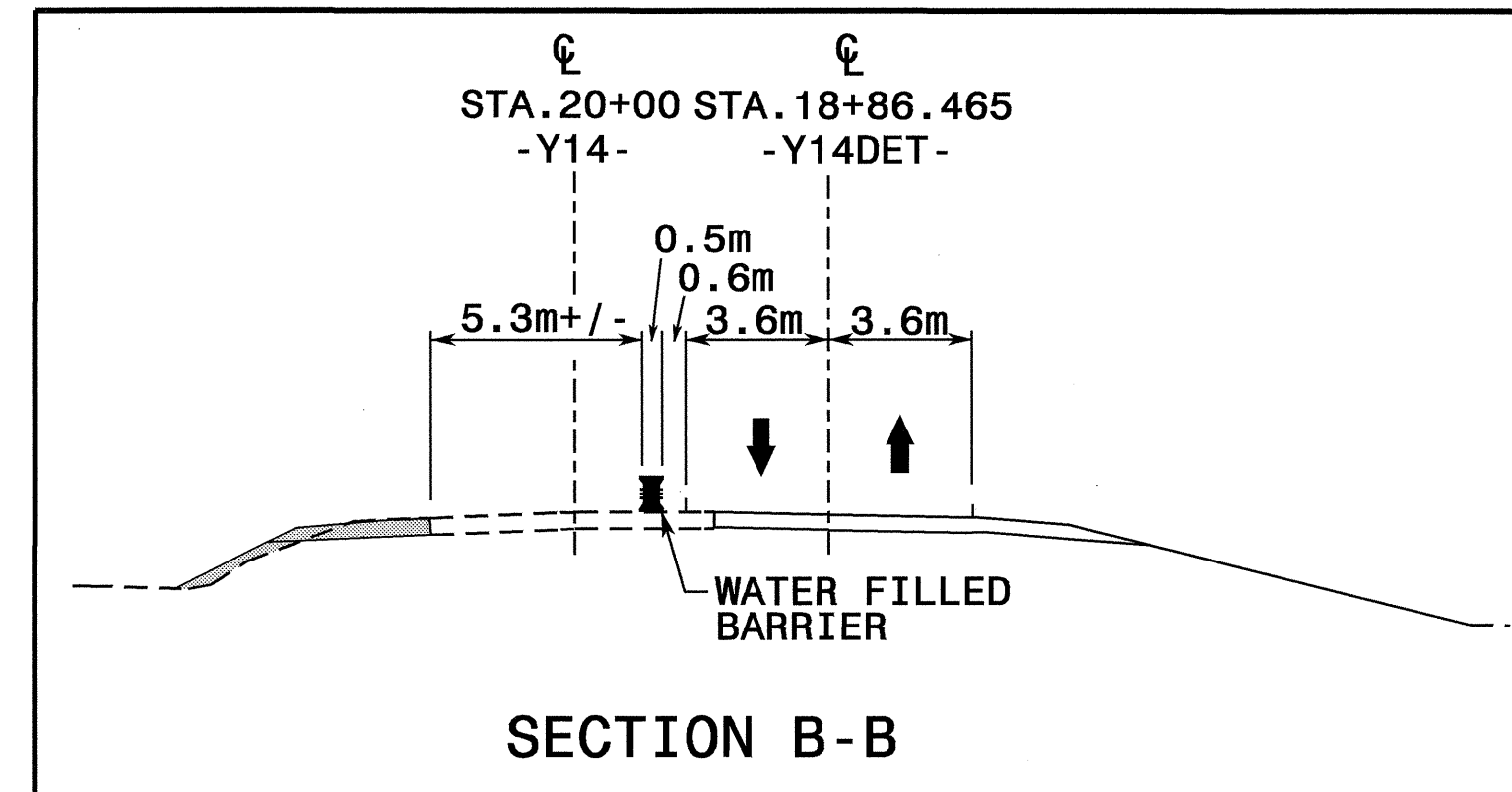
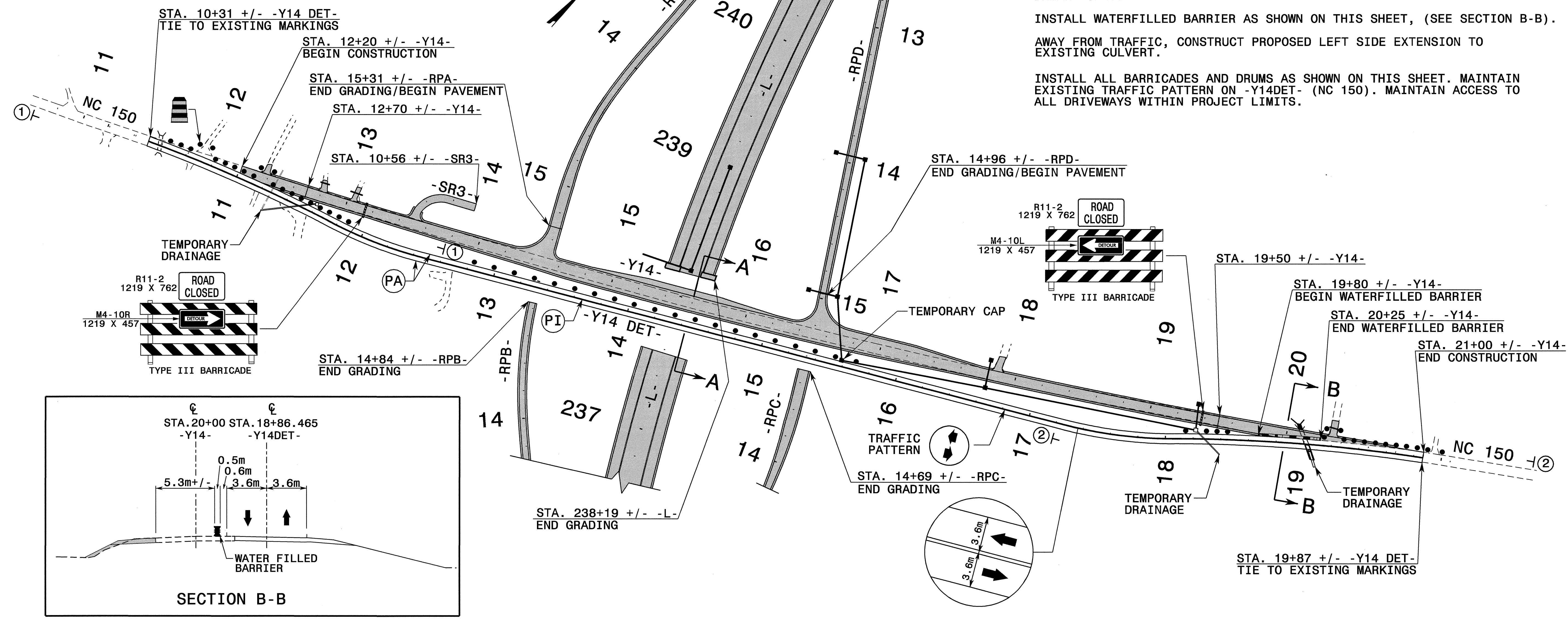

APPROVED: <i>[Signature]</i> DATE: <i>[Date]</i>	AREA 3 PHASE III DETAILS AND PHASING		SCALE: 1:1500		REVISIONS
SEAL			DATE: 05-10-04		DWG. BY: SBC

12-JUL-2004 15:35
 S:\CP-AREA3\2206C.TC-AREA3-top15.dgn
 SBCGTS AT TELC206428