



USE OFFSITE DETOUR SIGNING AS SHOWN AND RSD 1101.03 (SHEET 1 OF 9 )  
WHEN INSTALLING OVERHEAD BRIDGE GIRDERS OVER E. MAIDEN RD. (SR 1855)  
AND FOR INSTALLATION OF PROPOSED 1500mm RCP AT STA. 10+69+/-.

SIGN NUMR: 1  
TYPE: D  
QUANTITY: 4

TMv3.31  
BACKG COLOR:ORANGE  
COPY COLOR:BLACK

DESIGN BY: SBC  
PROJECT ID: R-2206C

CK BY: DIV: 12  
STD #: 0  
DATE: 6/17/02

VERTICAL SPACING (mm) [y]  
100 SPACE  
125 LINE 1  
C 225  
100 SPACE  
125 LINE 2  
C 450  
100 SPACE  
125 LINE 3  
C 675  
100 SPACE

SIGN WIDTH: 800 mm  
HEIGHT: 775 mm  
TOTAL AREA: 0.62 (S.M.)

MAJ. COPY SERIES:C

ROUTE MARKERS:

BORDR TYPE:RECESSED  
RECESS: 10 mm  
WIDTH: 15 mm  
RADII: 40 mm

ARROW TYPES:

NO. Z BARS: #N/A VHB:  
LENGTH: #N/A INCHES MAT'L: 1.6 mm ALUMINUM

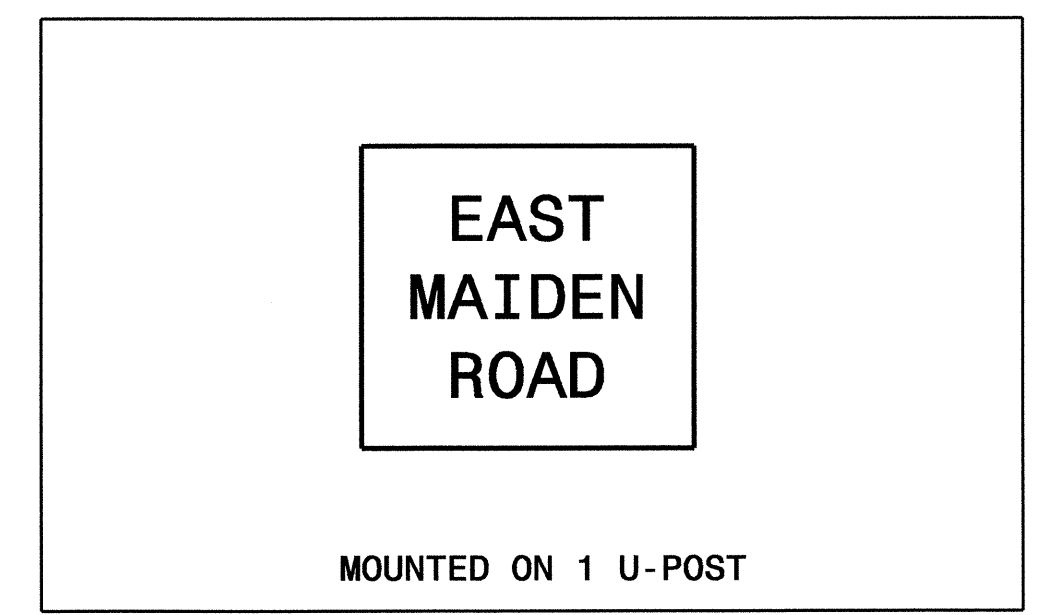

USE NOTES:  
1. Legend and border shall be direct applied non-reflective sheeting.  
2. Background to be Type I reflective sheeting.

SIZE/SERIES	LT MARGIN	SIGN COPY												RT MARGIN						
CHAR: 125 mm TYPE:C #/LC: 125 mm SPCE: 1.00 FACTOR LINE 1	239 [x]	E	A	S	T															
		64	104	91	64	0	0	0	0	0	0	0	0	0	0	0	0	0	0	0
		239	302	407	498	561	0	0	0	0	0	0	0	0	0	0	0	0	0	0
		0	0	0	0	0	0	0	0	0	0	0	0	0	0	0	0	0	0	239
CHAR: 125 mm TYPE:C #/LC: 125 mm SPCE: 1.00 FACTOR LINE 2	159 [x]	M	A	I	D	E	N													
		82	104	45	96	85	69	0	0	0	0	0	0	0	0	0	0	0	0	0
		159	241	346	390	486	571	641	0	0	0	0	0	0	0	0	0	0	0	0
		0	0	0	0	0	0	0	0	0	0	0	0	0	0	0	0	0	0	159
CHAR: 125 mm TYPE:C #/LC: 125 mm SPCE: 1.00 FACTOR LINE 3	222 [x]	R	A	D																
		91	95	101	69	0	0	0	0	0	0	0	0	0	0	0	0	0	0	0
		222	313	408	509	578	0	0	0	0	0	0	0	0	0	0	0	0	0	0
		0	0	0	0	0	0	0	0	0	0	0	0	0	0	0	0	0	0	222

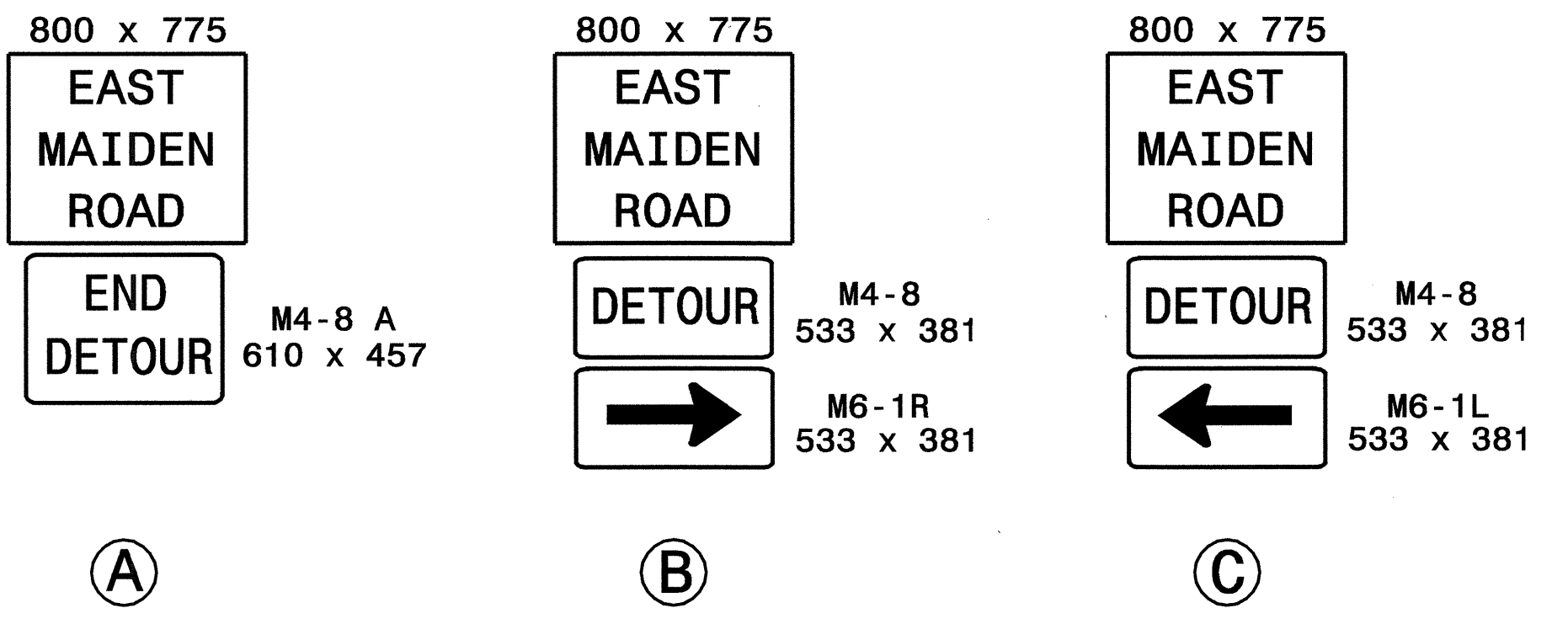
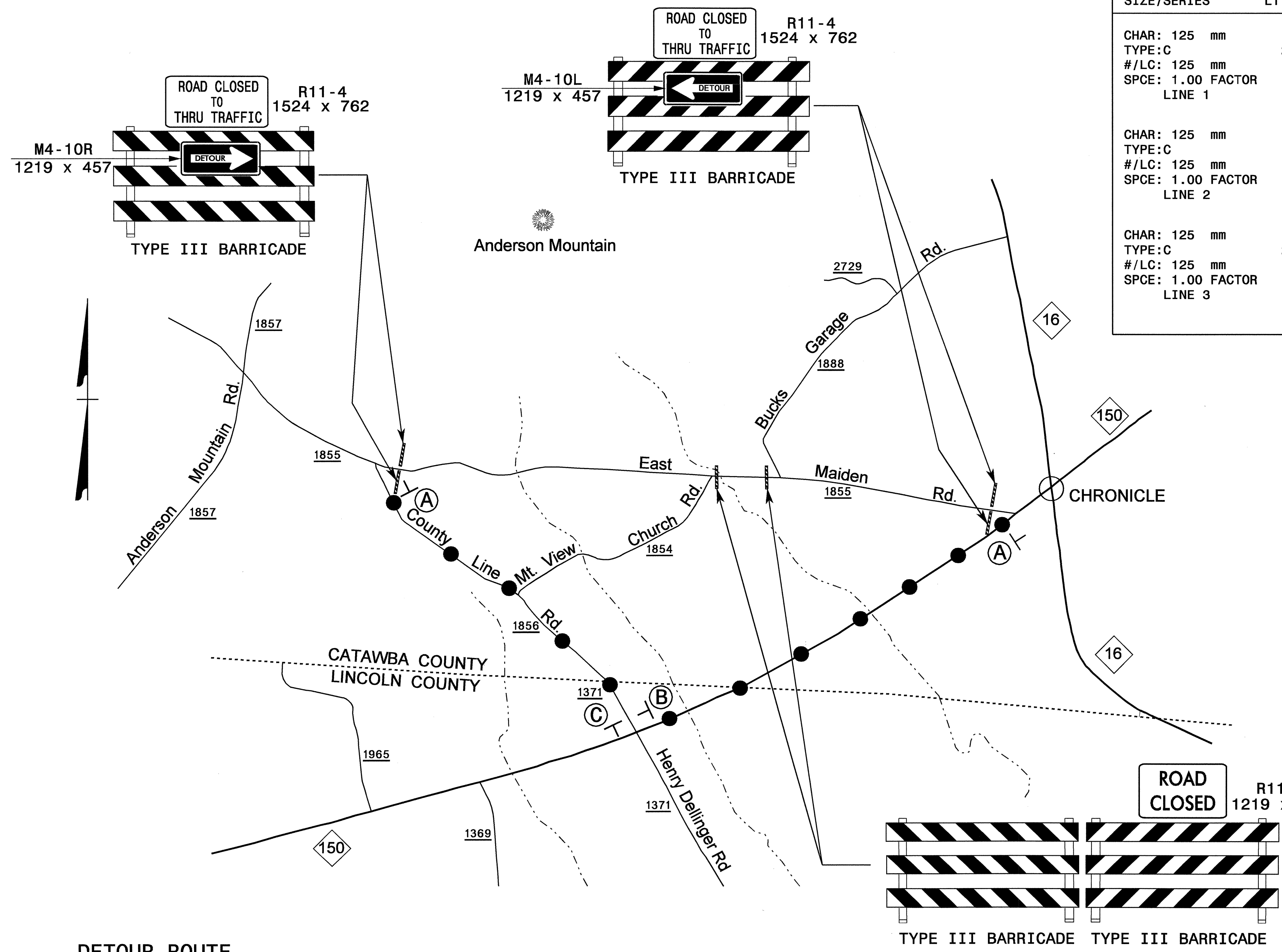

DETOUR SIGNING TO BE PAID FOR AS "STATIONARY WORK ZONE SIGNS"

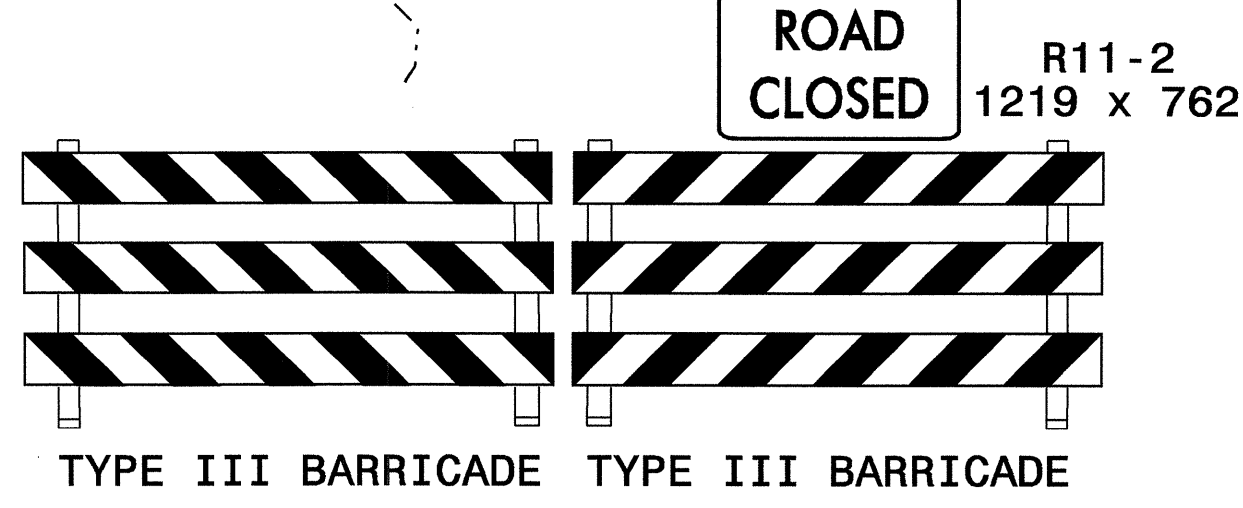

APPROVED: *John K. Koff* DATE: 7/12/04

SEAL:

SCALE: NONE  
DATE: 05-10-04  
DWG. BY: SBC  
DESIGN BY: SBC  
REVIEWED BY: CLM

AREA 4-PHASE I  
OFFSITE DETOUR SIGNING  
AND SIGN DESIGN

REVISIONS

09-JUL-2004 14:30  
J:\TCP\AREA4\R2206C-TC\AREA4\Fcp18.dgn  
SC00T5 AT TEL206428