

PROJECT REFERENCE NO. R-2206C
 SHEET NO. 60
 ROADWAY DESIGN ENGINEER
 HYDRAULICS ENGINEER
 METRIC
 5 0 10
 CONST. REV.
 R/W REV.

NORTH CAROLINA PROFESSIONAL SEAL 15356
 NORTH CAROLINA PROFESSIONAL SEAL 14160
 8-2-04
 9/16/04

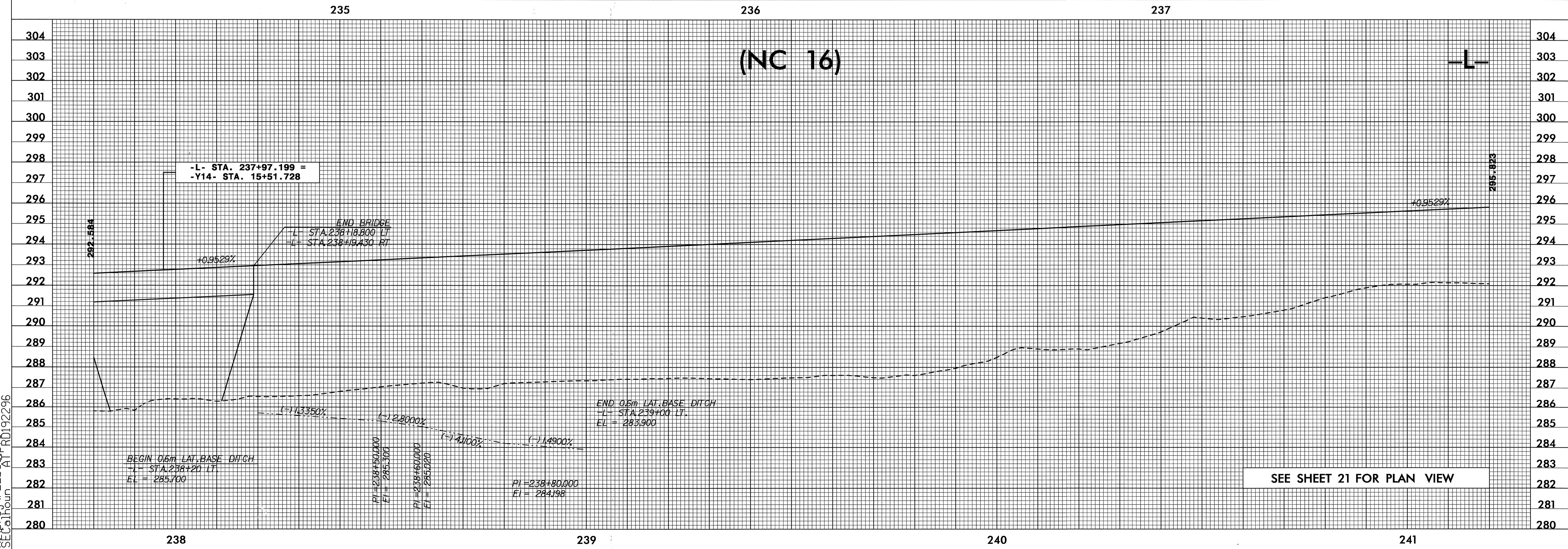

8/09/03
 15-JUL-2004 15:48
 R:\proj\rd2206\p1\SECalhoun AT RD192296