

8/09/2003

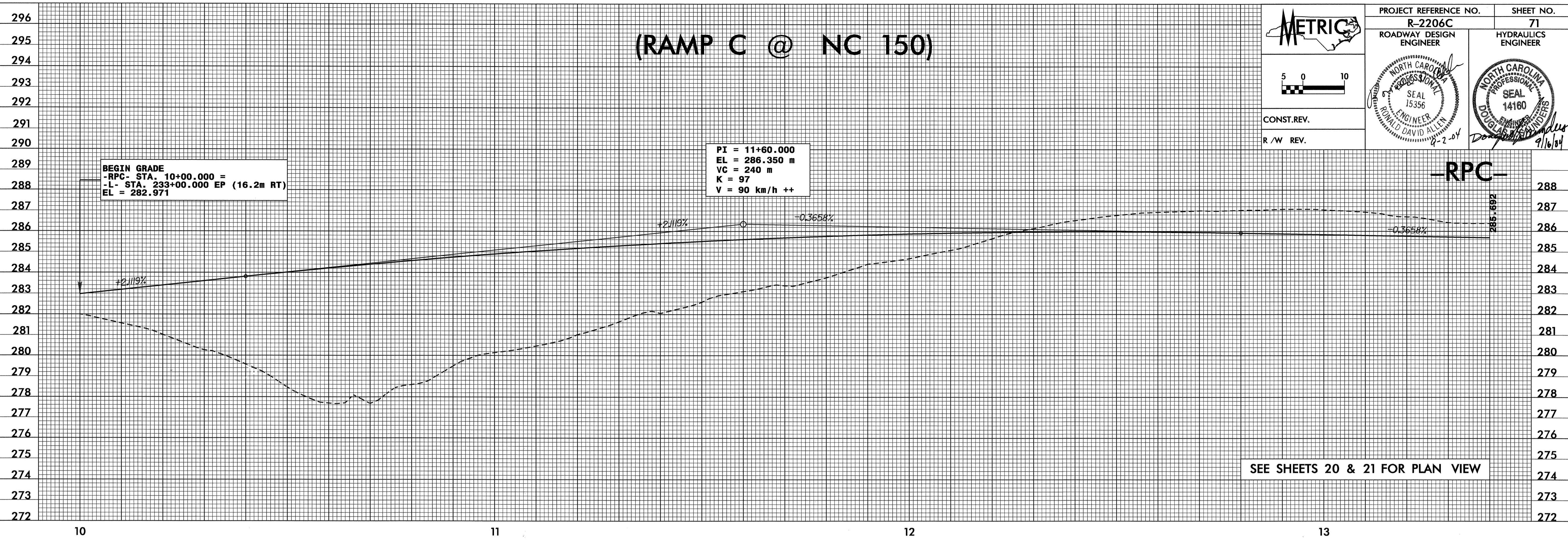

METRIC

5 0 10

CONST. REV.
R /W REV.

PROJECT REFERENCE NO. **R-2206C** SHEET NO. **71**

ROADWAY DESIGN ENGINEER
HYDRAULICS ENGINEER

PROFESSIONAL SEAL
 DONALD DAVID ALLEN
 ENGINEER
 15356
 8-2-04

PROFESSIONAL SEAL
 DOUGLAS B. WILSON
 ENGINEER
 14160
 9/16/04

15

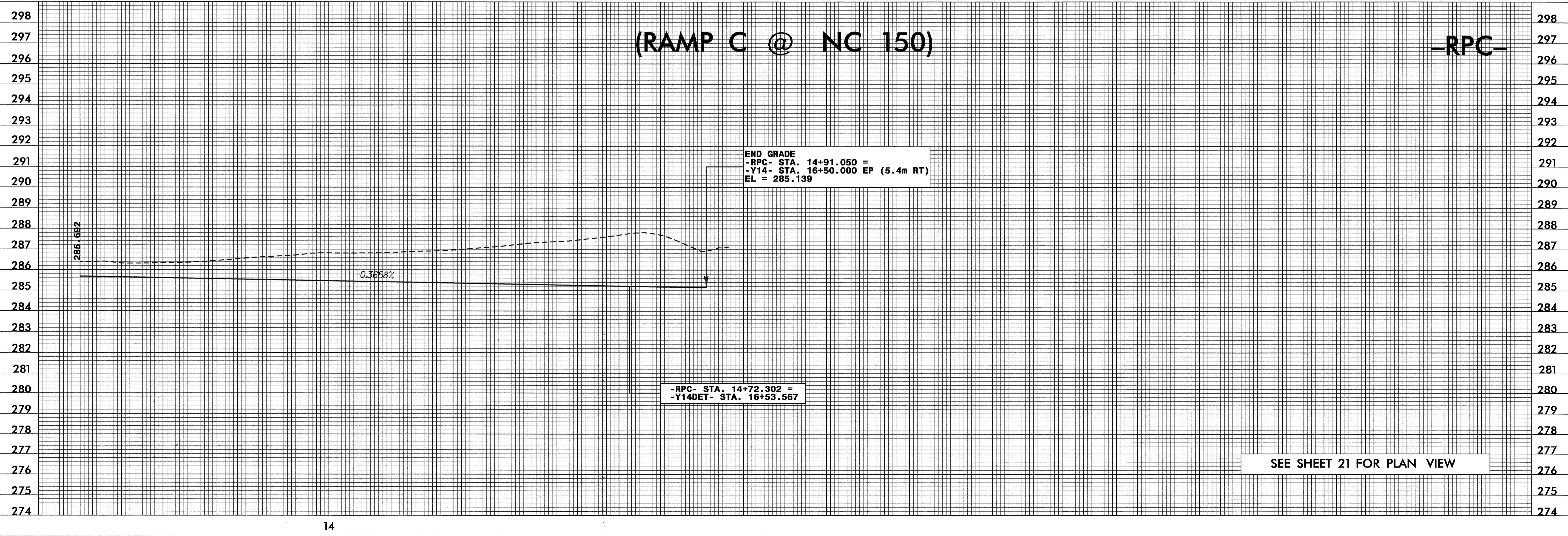

15-JUL-2004 15:44
 R:\proj\172206\p1\SEC\calhoun RD192296