

6/09/99

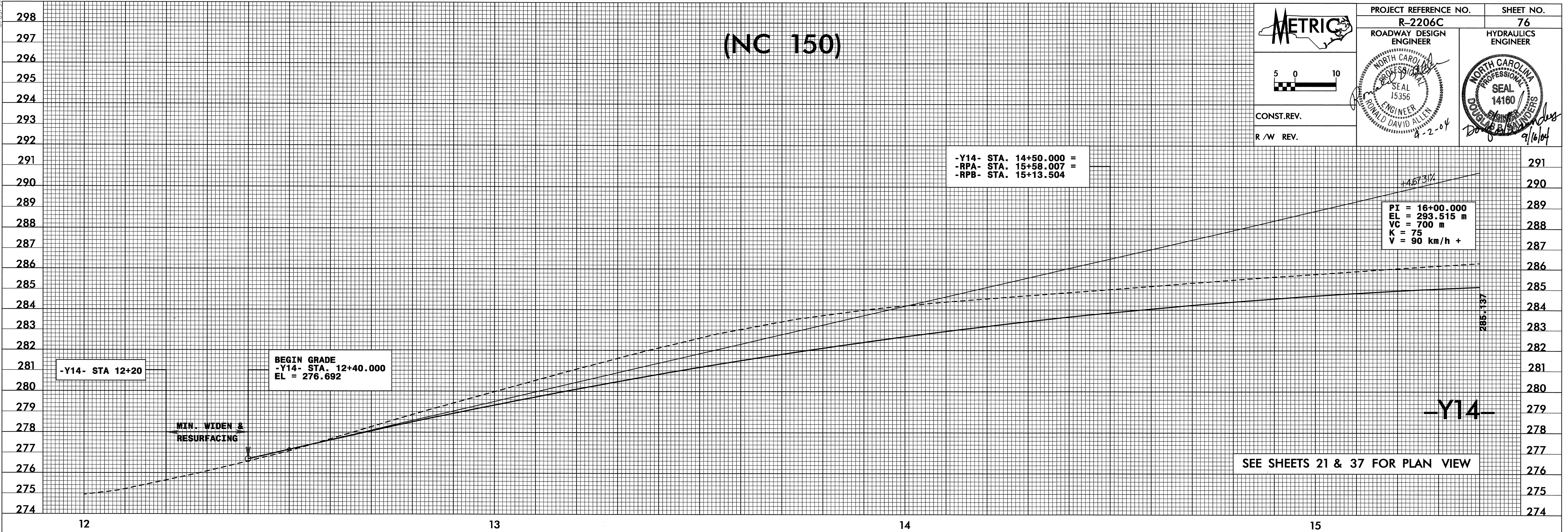

PROJECT REFERENCE NO. R-2206C	SHEET NO. 76
ROADWAY DESIGN ENGINEER	HYDRAULICS ENGINEER
CONST. REV.	R/W REV.

(NC 150)



(NC 150)

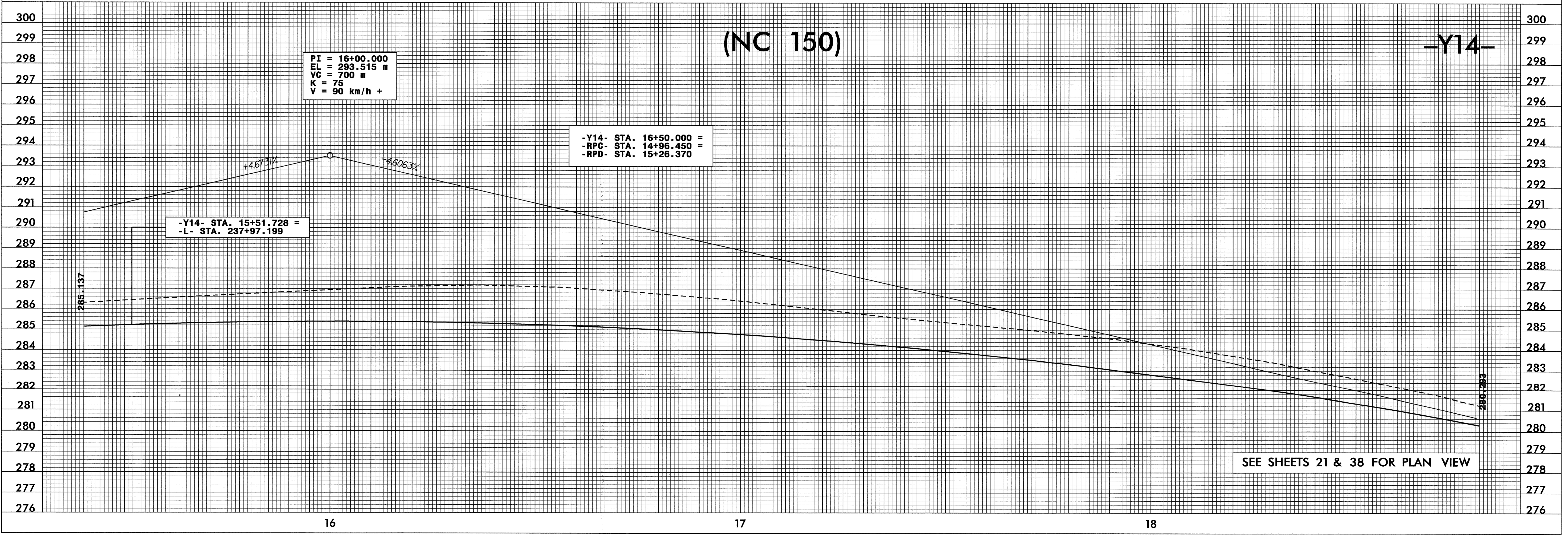

15-JUL-2004 15:41
R:\proj\2206\p1
SECalhoun AT RD192296